

# GRASS & GRAIN<sup>®</sup>

AGRICULTURE'S LOCAL NEWSPAPER

Published by AG PRESS

66th Year

No. 23

August 4, 2020

\$1.00



## Hager awarded the 2020 National Junior Angus Advisor of the Year

By Karen Hiltbrand

Often it is not what people say or do that is remembered; rather it is the way they make a person feel. This is the case for the late Nelson Hager. Before passing last April, he spent his time as an advisor to the Kansas Junior Angus Association (KJAA). Hager's junior Angus members were more than just members to him; they were "Nelson's kids." It is clear Hager will forever be remembered for his dedication to youth and to the KJAA, and it is his longstanding support that has earned him the Advisor of the Year honor at the 2020 National Junior Angus Show (NJAS).

Nelson Hager was a cheerleader for Angus youth. His rare soul would do almost anything if he knew it would make someone happy or help them learn. He always took time out of his day to make someone else's day brighter. His thoughtful and selfless demeanor was a clear indicator of his passion for the youth of the industry.

"This year Nelson Hager is being recognized as the 2020 Advisor of the Year," said Grady Dick-



Nelson Hager, Great Bend, was honored posthumously as the Advisor of the Year at the 2020 National Junior Angus Show (NJAS), July 20-24 in Tulsa, Okla. Pictured accepting the award is Nelson's family, from left: Tony and Susan Hager, Tammy Hager, Phyllis and Norman Hager, Nelson's parents; Grady Dickerson, National Junior Angus Board leadership director, presenting; Jenny Rutan, Colt Rutan and Ethan Hager.

Photo by Pearls Pics on behalf of the American Angus Association

erson, National Junior Angus Board leadership director. "But for Kansas, my family and me, he was much more than a great advisor. He was a friend a mentor, a great dad and we all miss him dearly."

A champion of young

people who excel in the Angus business, Nelson grew up showing in the Kansas Junior Angus Association, FFA and 4-H. He was an active participant in the National Junior Angus Show for many years. After his show ca-

reer as an Angus junior ended, Nelson continued to be active in junior activities by mentoring many kids with a drive and passion for Angus. He instilled a sense of self-confidence, self-worth and perseverance in many.



Nelson Hager is pictured with his son Aiden at NJAS 2018 in Madison, Wisc.

"When new families would join the Kansas Junior Angus Association, Hager would be the first to welcome them in and make them feel at home," said Anne Lampe, Kansas Angus Association secretary and American Angus Auxiliary member. "Nelson had one of those larger-than-life personalities, and he was absolutely the biggest cheerleader."

The members of the Angus family who knew Nelson well do not remember a National Junior Angus Show that he was not in attendance. However, his memory will live

on in our hearts for many National Junior Shows to come and in his young son, Aiden, whom he wished to be involved in junior Angus activities. Nelson was a true advocate of junior Angus excellence and has forever made a mark on its future.

The NJAA Advisor of the Year award was introduced in 1980 to recognize the tremendous contributions of the Junior Angus Association advisors. Any Junior Angus Association advisors are eligible for the award by sending in a letter of nomination.

## Tokach and Woodworth receive ASAS awards

Drs. Mike Tokach and Jason Woodworth, Kansas State University Department of Animal Sciences and Industry (ASI) professors, were recently presented awards by the American Society of Animal Science (ASAS).

Tokach is the recipient of the ASAS Fellow Award for research. The award was presented during the 2020 ASAS-CSAS-WSASAS Virtual Annual Meeting and Trade Show on Monday, July 20.

Tokach received his bachelor's degree in animal science at North Dakota State University, then his master's in swine nutrition at K-State. After obtaining his doctorate in swine nutrition at the University of Minnesota, Tokach returned to K-State in 1991 to join the Research and Extension staff as a livestock specialist then in 2013 he was promoted to University Distinguished Professor — the highest rank the university bestows its faculty.

His leadership is cen-

tral to the workings of a progressive swine nutrition research team that has made Kansas State University the "go to" place in applied swine nutrition research. During his nearly 30-year tenure at K-State, Tokach and his team have published more than 350 refereed journal articles and generated more than 20 million dollars in grants and fellowships.

Furthermore, his research program has fostered the growth and development of nearly 100 graduate students, serving as major professor for 24 of them. Tokach has led a highly successful program because he has had the vision to build and lead a faculty and graduate student team who share his same passion, values, and goals for the swine industry.

With his research and extension role, he has focused on transferring information to swine producers and conducting nutrition research. Tokach



Mike Tokach

has spoke at more than 300 animal and veterinary science meetings around the world. Additionally, he has co-authored 380 referred journal papers, 742 abstracts, 1,041 extension publications and field day reports. He has made many contributions to the swine industry with his research and extension efforts.

Woodworth is the recipient of the ASAS Industry Service Award. The award was presented Tuesday, July 21 during the 2020 ASAS-CSAS-WSASAS Virtual Annual Meeting and



Jason Woodworth

Trade Show.

Woodworth born and raised in Kansas received his ASI bachelor's degree from K-State. He then went on to receive his master's and doctorate also at K-State with his research focusing on vitamin and mineral requirements in nursery pigs and sows. Once receiving his degrees, Woodworth went on to work for Lonza as its global products manager for some of their specialty products. He spent some time traveling internationally to develop their global

business.

Since 2013, Woodworth has been part of the K-State applied swine nutrition team as a research professor. He also helps mentor graduate students every year, as well as serving as the faculty manager of the swine teaching and research center, early-weaned pig facility, swine lab and ASI analytic lab. His research has led to roughly 144 peer-reviewed journal publications.

"The recognition received by Mike and Jason from the predominant so-

ciety that represents animal scientists is certainly well deserved," says Dr. Mike Day, KSU ASI department head. "The K-State Swine Team is one of the best recognized sources for unbiased applied research findings and extension education in the U.S. and beyond. Furthermore, their commitment to training the next generation of swine scientists for the production industry, allied industries and land grant universities is at least, if not more impactful in the long term."

## Gov. Kelly reaffirms Tallgrass Heartland wind moratorium

On World Nature Conservation Day, Governor Laura Kelly announced a proclamation reaffirming the Tallgrass Heartland wind moratorium region of the Flint Hills. The area encompasses portions of 12 Kansas counties containing two thirds of the world's remaining tallgrass prairie.

"The Tallgrass Heart-

land moratorium helps conserve Kansas' unique prairie ecosystem, vital to native wildlife, tourism, education and local ranching economies," Kelly said. "There has been bipartisan consensus across administrations that these lands should be protected, and I'm pleased to follow in that tradition today."

Kansas Department of

Wildlife, Parks and Tourism Secretary Brad Loveless emphasized the region's value.

"The Flint Hills are home to some of our most breathtaking vistas and iconic prairie species, so it's important we continue to protect this remarkable landscape and the many wildlife that inhabit it," Loveless said. "The proc-

lamation signed today by Governor Kelly is sure to be welcome news for residents and visitors, alike."

Governor Kathleen Sebelius first declared a wind development moratorium in parts of the Flint Hills in 2004 on the advice of the Kansas Geological Society and the Wind and

• Cont. on page 3

## KDA asks public to report receipt of any unsolicited packages of seeds

The Kansas Department of Agriculture has been notified that several Kansas residents have received unsolicited packages containing seeds that appear to have originated from China. The types of seeds in the packages are unknown at this time. The packages were sent by mail; some have been labeled as jewelry and they may have Chinese writing on them. Unsolicited packages of seeds have been received by people in several other states across the United States over the last several days.

If you receive a package of this type, please DO NOT plant these seeds. If they are in sealed packaging, don't open the sealed package. Instead, please contact KDA's plant protection and weed control program at 785-564-6698, via email at KDA.PPWC@ks.gov, or at the complaint reporting portion of the KDA website: report a seed complaint.

Unsolicited seeds could be invasive species, could introduce diseases to local plants, or could be harmful to livestock. Invasive species wreak havoc on the environment, displace or destroy native plants and insects and severely damage crops. KDA works to prevent the introduction of invasive species and protect Kansas agriculture.

## Making the most of the sunshine



Janae Seematter captured this image of hay being baled near Manhattan. Hot, dry conditions earlier in July gave way to heavy rains over portions of the state last week.





## Swimming Through Summer

By Kim Baldwin, McPherson County farmer and rancher

Spending time at a pool has always been an integral part of summer for my little family. My kids have participated in swim lessons every summer since they were born. From participating in the “mommy and me” lessons offered by a local YMCA to group lessons at a nearby community pool, my two children have spent many of their summer days looking forward to a refreshing break from the Kansas heat by jumping into a pool.

Over the years my kids have become accustomed to the luxury of pool time to include a herd of kids lined up patiently waiting to jump off a diving board, summer jams blaring over loudspeakers and a concession stand readily available to sell them a nice sugary treat. This year, however, has offered a new pool experience.

While my family has remained on the farm this summer, we have introduced the kids to the joys of our own “private” pool. Our pool is a bit smaller than the average community pool.

It doesn't offer a diving board. There is no deep end to toss diving toys into. You definitely can't practice handstands or dolphin kicks or even swim laps at our pool. A ladder is not available to climb out of it when the lifeguard blows the whistle for a break. In fact, our pool's lifeguard lacks a whistle. The lifeguard tower isn't as high as you would see at other pools, and our lifeguard's seat lacks any flotation devices — but does offer two mesh drink holders.

While we still have many days of excellent pool time temperatures, when it is time to close the pool because of changing of seasons, we won't have to winterize our pool. Instead, we'll just need to move it to the other side of the fence so the cattle will have another place to drink.

Yes, we have introduced our kids to the stock tank pool this summer. And they are truly loving it!

Our pool is convenient and refreshing and has become a place for my family of four to enjoy summer mornings, afternoons and evenings taking a dip.

Our pool has allowed the kids to go for their “morning swims” before breakfast. In fact, many mornings while getting breakfast together, I watch my two race each other down the hill to see who can jump into the water first.

In the evenings, I'll sit in my comfortable camp chair, put a drink in a cup holder, place my feet up on the edge of the pool and read the newspaper while simultaneously trying to avoid getting splashed by the young swimmers occupying the space.

While the space is best for two small children, there are even times you'll see my husband or myself sitting in the pool helping the kids create a giant whirlpool. Even Rosie the farm dog has jumped in at times to demonstrate proper doggy-paddle technique to her two small humans.

While our pool may lack crowds and chlorine, it has allowed us to continue to enjoy breaks from the heat and has given the kids something extra to look forward to — and will perhaps become another happy memory of what the summer of 2020 was like home on the farm.

“Insight” is a weekly column published by Kansas Farm Bureau, the state's largest farm organization whose mission is to strengthen agriculture and the lives of Kansans through advocacy, education and service.



## Prairie Ponderings

By Donna Sullivan

The whirlwind known as County Fair Season is winding down, and what a wild one it has been. There's not a fair in Kansas, make that the nation, that wasn't forced to modify their activities in some way. And while no one was particularly happy about it, everyone did what needed to be done to give the kids the best experience possible during this COVID-19 pandemic that's altered everyone's lives.

Here at *Grass & Grain*, for many years we've published the champion and reserve champion livestock photos from many area fairs, and we will do that again this year. But since so many young people were not able to take

### KDA seeks nominations for Kansas Ag Heroes

The Kansas Department of Agriculture is excited to announce they are now accepting nominations for the first-ever Kansas Agriculture Heroes Program. Since the beginning of the COVID-19 pandemic, Kansas farmers, ranchers, and agribusinesses have performed essential functions

to keep food on the tables of people worldwide. KDA established this program as a way to recognize those in the agriculture industry who went above and beyond to serve others and better their community when it was needed most. KDA encourages Kansans to nominate any individual, family, or business in Kansas agriculture which you feel provided a notable contribution to the agriculture industry or their community as a whole this year. Nominations will be accepted through August 10. The nomination instructions can be found at [www.agriculture.ks.gov/AgHeroes](http://www.agriculture.ks.gov/AgHeroes).

KDA leadership will review each nomination and will recognize a select number of agriculture heroes virtually during the Kansas Summit on Agricultural Growth webinar on August 20. The recognition ceremony will be recorded and posted online at a later date. For questions about the Kansas Agricultural Heroes Program nomination process, please contact Brittney Grother at 785-564-6797 or [Brittney.Grother@ks.gov](mailto:Brittney.Grother@ks.gov).

• Cont. on page 3

in sharing them. You can email me your photos, along with their name, 4-H club, project name and any other details you would like to include to [gandgeditor@agpress.com](mailto:gandgeditor@agpress.com). It might take me a while, but I will print everyone's photos. I've gotten some great ones already, which begin publishing in this issue and will continue until they are all done.

Hopefully next year, things will be back to normal and we can all get together to see the projects, watch the livestock shows and maybe share a snowcone or funnel cake. Because really, what's summer without the County Fair?

## Office of Rural Prosperity announces 2020 tour

Governor Laura Kelly and Lt. Governor Lynn Rogers announced plans and dates for the Office of Rural Prosperity's (ORP) 2020 Tour. This year's tour will be completely virtual and will build off the ORP Listening Tour Lt. Governor Rogers led last summer.

Prosperity was established to give all Kansans a voice at the statehouse,” Kelly said. “This tour will continue to remind rural communities that we are here to support them, and we are continuing to work towards solutions that will foster growth and prosperity in these areas.”

Last summer Lt. Governor Rogers took to the road as part of a statewide Listening Tour where he connected with hundreds of Kansans across the state. These discussions established the foundation for the Office of Rural Prosperity and its priorities to help streamline policies and coordinate programs that aid rural Kansas.

The 2020 tour will consist of seven virtual meetings across the state that will be open to the public. State agency leaders and local stakeholders will join the Lt. Governor to talk about policies and projects that are targeted to rural areas.

“One of my favorite things is connecting with people and I'm very much looking forward to getting

“back on the road” again, even if it's virtual,” said Rogers. “To contrast last year's tour, this year we will focus around listening and action, meaning we will be showing Kansans how we've been working towards sustainable solutions to concerns we've heard across the state.”

Kelly cited Covid-19 concerns and the safety



You know that little voice in the back of your head telling you that what you are about to do is a mistake? Yeah, I have one of those, too and, no, I do not listen to mine either. The worst part of it is my little voice will tell me, “I told you so” afterward.

This past week we had a lot of rain. I am never going to complain about rain in the summer, but I will grumble occasionally about what happens because of the rain. This rain made a lot of mud. This did two things. First it made my back sore from wearing mud boots to do chores and that made me grumpy. It also made matters much more complicated when it came to feeding hay to the critters I have in the lots.

My loader tractor is in the shop and I am down to feeding with the skid loader. No problem normally, but this year is anything but normal. We had some rain and for two days I knew better than to try to put a bale in the feeder but on the third day I thought it was dry enough. I know, there I go again thinking, I should know that is a lost cause. In any case, I set out to feed hay with the skid loader.

The first two pens went fine, no problems, no incidents, then we got to the pen the butcher cattle were in. It is used more frequently and therefore the mud is a little deeper and a little soupier. As I started through the gate the little voice in the back of my head started to squawk, telling me that this was not going to work, and I was about to get stuck. I made it through the gate with a minimal amount of spinning and the voice got louder telling me I had gotten lucky and to drop the bale inside the gate and get out while I still could.

“I am not rolling that bale ring through the slop and getting muddy. I'll show you,” I told the voice in my head. Okay, so I cannot be the only one who has arguments with the voice. At least, I hope I am not the only one. I plowed on — I literally plowed on. I almost pulled it off but with about a foot to go, the skid loader stopped moving. I tried going forward, nothing. I tried going backward, nothing, I tried pushing and

still nothing. “I told you so, now what are you going to do Mr. I'll Show You?” Not only was the voice mocking me, but it was doing it in a snarky tone. Come to think of it, the voice sounded familiar, but I could not put my finger on where I had heard it before. I climbed out of the cab, and that took some doing. I was able to drop the bale just far enough away to allow for just enough room for this old fat guy to squeeze out.

It was stuck and stuck good. My daughter was helping me feed so I did have a ride back to get a tractor. Since the cattle were in the pen it was going to be a three-person operation to pull the skid loader out; we had to wait for my wife to get home from work. It was later in the day and soon Jennifer was home, and she was really thrilled about my situation. We got to the pen, squeezed the tractor into position and dug the hooks out on the skid loader. I told you I was really stuck.

Pulling it out was not terribly hard; it was a bit complicated because of the tight area we had to work in and the depth of the muck and slop we had to deal with. In a few short minutes we had the skid loader free and I was backing up to get the slack out of the chain. It was hot and very humid, and I had sweated through every layer of clothing I had on. My wife accused me of being grumpy, I prefer to call it terse and authoritative. My daughter offered her second opinion that it was not authoritative but grumpy, very grumpy.

We got the chain picked up, drove the tractor and skid loader out of the pen and as we were gathered at the gate my wife looked the situation over. “I would have not tried to drive in and I would most certainly have dropped the bale off before I got stuck,” she said in a snarky, mocking tone. That was the moment when I realized why the voice in my head sounded so familiar. “You know, you sound a lot like the voice in my head,” I told her. That was when I heard, “I told you so,” in stereo.

### COWPOKES® By Ace Reid



“Dan, I know this is gonna sound ridiculous, but...Whoa Dan!”

### EARL... Big Dry Syndicate



“THAT'S WHERE I STARTED THE FIRST GRADE, AND I'LL NEVER FORGET WHAT I LEARNED THAT FIRST DAY IN SCHOOL... 'SIT DOWN AND SHUT UP'...”

GRASS & GRAIN (USPS 937-880)  
The newsweekly for Kansas and southern Nebraska, published each Tuesday at 1531 Yuma (Box 1009), Manhattan, KS by Ag Press, Inc. Periodicals postage paid at Manhattan, Kansas and additional offices. Postmaster send address changes to: Ag Press, Box 1009, Manhattan, KS 66505.

785-539-7558  
Fax 785-539-2679  
Publisher — Tom Carlin  
Managing Editor — Donna Sullivan  
[gandgeditor@agpress.com](mailto:gandgeditor@agpress.com)

Subscription — \$76 for 2 years. \$41 for 1 year, plus applicable sales tax. Outside Kansas, \$51 for 1 year, \$95 for 2 years.  
MEMBER OF Associated Press  
[www.grassandgrain.com](http://www.grassandgrain.com)



# U.S. cattle herd sees small uptick

All cattle and calves in the United States as of July 1, 2020 totaled 103 million head according to the USDA's National Agricultural Statistics Service. All cows and heifers that had calved totaled 41.4 million head. Beef cows totaled 32.1 million head. Milk cows totaled 9.35 million head. All heifers 500 pounds and over totaled 16.5 million head. Steers weighing 500 pounds and over totaled 15.0 million head. Bulls weighing 500 pounds and over totaled 2.10 million head. Calves under 500 pounds totaled 28.0 million head. All cattle on feed fed for the slaughter market in the United States for all feedlots totaled 13.6 million head. The 2020 calf crop is expected to be 35.8 million head. Calves born during the first half of the year are estimated at 26.1 million.

# Dairyland Laboratories and ServiTech collaborate on feed testing technology

ServiTech, Inc. and Dairyland Labs have announced a strengthened laboratory partnership for serving the beef and dairy industry. Building on a relationship that has been primarily focused on beef production within the ServiTech footprint, both laboratories are committing to an expanded level of service and feed science for the growing number

of dairy herds in the high plains and southwestern United States. Benefits to the customer include seamless sample drop-off, submission and reporting from both labs

"ServiTech has three strategically located laboratory locations in geographies with growing dairy herds," said Greg Ruehle, president and CEO of ServiTech. "Dairyland Labs' rich history and commitment to science commands respect in the dairy feed testing space, and we are very excited about this new partnership moving forward. It's a win for both labs, and ultimately a win for producers within the ServiTech service area."

The agreement allows laboratory users the flexibility to ship to or drop off feedstuff samples at any ServiTech laboratory loca-

tion, while still being able to access the experts at Dairyland. ServiTech will process samples and run NIR spectral scans. The NIR spectral scans will be predicted using the Dairyland proprietary calibrations, which are the most robust in the industry. The customer may choose to view test results online through an account with either laboratory.

"The new strengthened laboratory partnership builds on the analytical strengths of both companies," said Dave Taysom, president of Dairyland Laboratories, Inc. "This unique relationship between ServiTech and Dairyland will provide real value in analytical services for the beef and dairy industry. We are excited to get started."

# Gov. Kelly reaffirms Tallgrass Heartland wind moratorium

•Cont. from page 1  
Power Task Force. In 2011, Governor Sam Brownback expanded the protected area to its current size, naming it the "Tallgrass Heartland."

"Wind power will continue to be a key part of Kansas' energy future," Kelly said. "We can and should seek both to expand the development of clean energy like wind and solar while protecting the ecosystem and natural beauty of our tallgrass prairies for future generations."

More than 15 percent of Kansas' electricity comes from renewable energy and Kansas has the second largest wind power potential of any U.S. state. The industry has grown substantially in recent years, more than tripling since 2008.

## Building Solutions You Can Trust

"Experience the Difference"



Pre-Engineered Wood Frame Metal Buildings  
Check us out online  
or  
Call us today for a FREE ESTIMATE!  
**Your Building. Your Dream. Your Way.**

**K-Construction Inc.**  
Alta Vista, KS  
**785-499-5296**  
www.k-constructioninc.com

# Office of Rural Prosperity announces 2020 tour

• Cont. from page 2  
Kansas for the move to a virtual platform. The Lt. Governor echoed her sentiments but acknowledge the challenges of broadband internet for some rural areas. Participants will still have opportunities to ask questions during the meetings and provide feedback through surveys and the comments section.

The ORP's priority areas consist of broadband and infrastructure, early education and childcare, healthcare, housing, and community development. The tour will also discuss the impacts of COVID-19 on rural communities.

Participants must register for their specific region at [www.ruralkanprosper.gov/2020-tour](http://www.ruralkanprosper.gov/2020-tour). Call-in options for those with limited internet access will be available and all sessions will be recorded and streamed to Lt. Governor's Facebook page. Press and

public officials are encouraged to attend.

Tour Schedule:  
All meetings will be held 5:30-7:00 p.m. except for the Saturday statewide meeting.  
North Central- Thursday, August 6th  
North West- Wednesday August 12th

Statewide- Saturday, August 22nd (1:30-3:00 p.m.)  
Southwest- Tuesday, August 25th  
South Central- Wednesday, September 2nd  
South East- Wednesday, September 9th  
North East- Wednesday, September 16

PRECISION AERIAL APPLICATION: Pasture \ Crop \ Government



**VersaAir** SERVICES, LLC  
(877) 79-VERSA  
(316) 882-1540  
VersaAir.com

## NOW IS A GOOD TIME TO GET RID OF UNUSED ITEMS ON THE FARM

### GRASS & GRAIN Classifieds are the perfect way to do it!

**CLASSIFIED LINER ADS:**  
65¢ per word.  
Discounts available for pre-paid ads that run 2+ weeks.  
Visit us online, give us a call, stop by, or fill in and mail the ad form on page 16 to submit a classified liner ad.

**CLASSIFIED DISPLAY ADS:**  
\$10.50 per column inch.  
Discounts not available.  
Give us a call, stop by, or contact your Grass & Grain sales rep to place a classified display ad!

[www.GrassAndGrain.com](http://www.GrassAndGrain.com)  
785-539-7558  
1531 Yuma St • Manhattan, KS 65502

**CLASSIFIED LINER ADS** look like this. First line is in all-caps and bold. No other formatting available. Pay by-the-word. Words counted by a space. Phone numbers or words separated by a dash are 1 word. Words separated by a backslash are counted as 2.

**CLASSIFIED DISPLAY ADS LOOK LIKE THIS!**  
• Includes a defining border around the ad.  
• Pay by the inch.  
**All formatting is available.**  
Photos/ logos optional.  
Can be 1 or 2" columns wide.  
\*Depending on classification  
**Color is now available for classified display ads!\***  
\*Color is \$15 per inch. Ad must be at LEAST 1colX3.5" to run in color in the classified section.



**KANSAS AG REPORT**

Ken Rahjes, Host

For TV Show times check your local listings or watch at [kansasagreport.net](http://kansasagreport.net)

## GRASS & GRAIN EMAIL EDITION

ARRIVES IN YOUR INBOX EVERY MONDAY AFTERNOON!  
Low cost, easy to sign up and use!

Current print subscribers can receive the email edition at no extra cost. All we need is your email! Call and we'll get you set up!

**For more information:**  
Subscribe online: [GrassAndGrain.com](http://GrassAndGrain.com)  
Give us a call: 785-539-7558  
Or stop by: 1531 Yuma St., Manhattan, KS 66502

We will NEVER sell your information, and you will not receive any junk emails from or as a result of us.

## Never miss an issue of

# GRASS & GRAIN

Subscribe or renew today!

New Subscription \_\_\_\_\_ Renewal \_\_\_\_\_

Name: \_\_\_\_\_  
Address: \_\_\_\_\_  
City: \_\_\_\_\_ State: \_\_\_\_\_ Zip: \_\_\_\_\_  
Phone: \_\_\_\_\_  
Email: \_\_\_\_\_

Activate Online Edition? \_\_\_\_\_  
\*\*Online Edition is FREE with purchase of Print Subscription; Email is required.\*\*

**In-State Print Edition Rates:**  
1 Year; \$41 + additional sales tax \_\_\_\_\_  
2 Years; \$76 + additional sales tax \_\_\_\_\_  
3 Years; \$105 + additional sales tax \_\_\_\_\_

\*\* SALES TAX DETERMINED BY COUNTY AND MUST BE INCLUDED TO RECEIVE FULL YEAR. CALL IF UNSURE.\*\*

**Out-Of-State Print Edition Rates:**  
1 Year; \$51 \_\_\_\_\_ 2 Years; \$95 \_\_\_\_\_ 3 Years; \$132 \_\_\_\_\_  
\*\*Call for info about our 1st Class or Online Only rates\*\*

Check/Cash Enclosed: \_\_\_\_\_  
or  
Credit/Debit Card:  
Visa, Master Card, Discover, American Express  
\_\_\_\_\_  
Expiration Date: \_\_\_\_/\_\_\_\_/\_\_\_\_  
V-Code (3 digits on back of card): \_\_\_\_  
Signature: \_\_\_\_\_

Mail to: P.O. Box 1009, Manhattan, KS 66505  
OR Stop by the office: 1531 Yuma St., Manhattan, KS 66502  
**1-877-537-3816**



# GRASS & GRAIN Our Daily Bread

\*\*\*\*\* By G&G Area Cooks \*\*\*\*\*

**LaVerna Hinkle, Manhattan, Wins Weekly Grass & Grain Recipe Contest & Prize**

Winner LaVerna Hinkle, Manhattan: "If you like apple pie, you will love this recipe. Also a great way to use some of the extra zucchini."

## ZUCCHINI PIE

4 cups zucchini  
 1 1/2 teaspoons cream of tartar  
 Dash of salt  
 2 tablespoons flour  
 1 tablespoon lemon juice  
 Dash of nutmeg  
 1 1/4 cups sugar  
 1 1/2 teaspoons cinnamon  
 1 teaspoon butter  
 1 unbaked pie shell  
**Topping:**  
 1 stick of butter  
 1/2 cup sugar (I use brown sugar)  
 1 cup flour  
 Peel zucchini and cut lengthwise; scoop out seeds. Slice like an apple. Cook zucchini in a small amount of water for 10 minutes. Drain. Mix cream of tartar, salt, flour, lemon juice, nutmeg, sugar and cinnamon with zucchini. Pour into pie shell and dot with butter. Make topping by mixing butter, sugar and flour (just soften butter a little so you can make the crumble topping). Put crumb mixture on top of pie and bake at 350 degrees for 45 minutes.  
 \*\*\*\*\*

Annette Reilly, Abilene:  
**CROCK-POT LASAGNA**  
 24-ounce can of pasta sauce, divided  
 6-ounce bag ribbon pasta, dry  
 2 pounds Sirloin steak, trimmed & cut into serving sizes  
 1/4 cup water  
 1/4 cup dehydrated onion, divided  
 2 tablespoons Italian seasoning, divided  
 Place uncooked pasta on bottom of pan of crock-pot. Sprinkle with half the dehydrated onion, half the Italian seasoning and all of water. Spread two-thirds of the pasta sauce across pasta. Place steak pieces atop pasta and sprinkle with remaining dehydrated onion and Italian seasoning. Spread last of pasta sauce evenly atop steak. Cook on low for 6 to 8 hours. Serves 6 to 8. Will be thick, but completely forkable.  
**SUGGESTION:** Preheat and pre-spray crock-pot with nonstick coating on high while preparing and layering then turn to low for remaining cook time of 6-8 hours.  
 \*\*\*\*\*

Millie Conger, Tecumseh:  
**HARVARD BEETS**  
 3 cups cooked sliced beets  
 1/2 cup sugar  
 1 tablespoon cornstarch  
 1/2 teaspoon salt  
 1/2 cup milk vinegar  
 Cook and stir all ingredients, except beets, until clear. Pour over drained, cooked, heated beets. Allow to set for 10 minutes before serving.  
 \*\*\*\*\*

Susan Schrick, Hiawatha:  
**CHEDDAR ZUCCHINI BREAD**  
 3 cups shredded zucchini  
 2 teaspoons salt  
 1 1/2 cups flour  
 1 tablespoon baking powder  
 Diced onion  
 2 cups Cheddar cheese  
 1 tablespoon garlic powder  
 1 teaspoon pepper  
 1/2 cup melted butter  
 3 eggs  
 Mix the zucchini and salt; drain after 30 minutes. Mix the flour, baking powder, onion, cheese, garlic powder and pepper. Mix melted butter and eggs then add to flour mixture. Add zucchini. Bake at 350 degrees for 35 to 45 minutes.  
 \*\*\*\*\*

Kim Edwards, Stillwater, Oklahoma:  
**ZUCCHINI JAM**  
 6 cups shredded zucchini  
 1 cup crushed pineapple  
 1/2 cup lemon juice  
 1 package Sure-Jell  
 6 cups sugar

6-ounce package apricot gelatin  
 Peel and grate zucchini. Drain for 1 hour. Cook zucchini, pineapple, juice, Sure-Jell and sugar. Boil hard for 10 minutes stirring constantly. Stir in gelatin. Freeze in containers.  
 \*\*\*\*\*

Loretta Shepard, Helena, Oklahoma:  
**MEXICAN LASAGNA**  
 1 large package of Doritos  
 1 1/2 pounds hamburger  
 1 green pepper  
 1 medium onion  
 1 can cream of chicken soup  
 1 can cream of mushroom soup  
 1 small can Carnation milk  
 1 can Ro-tel tomatoes  
 1 cup grated Cheddar cheese  
**Brown hamburger, chopped onion and chopped green pepper. In a 9-by-13-inch baking dish put half of lightly crushed Doritos. Top with meat mixture. Mix together the soups and milk; spread on top of meat. Pour Ro-tel tomatoes over all. Add another layer of lightly crushed Doritos. Top with grated cheese. Bake at 350 degrees for 30 minutes.**  
 \*\*\*\*\*

Rose Edwards, Stillwater, Oklahoma:  
**CASHEW CHICKEN CASSEROLE**  
 1 cut-up & cubed chicken  
 1 cup diced celery  
 1 cup diced onion  
 2 cans mushroom soup  
 3/4 cup chicken broth  
 1 cup cashew halves  
 1 small can Chinese noodles  
 Sauté celery and onion until tender. Mix all together. Bake in 9-by-13-inch baking dish at 350 degrees for 30-45 minutes until bubbly.  
 \*\*\*\*\*

Kellee George, Shawnee:  
**BREAKFAST PAN**  
 (2) 20-ounce bags refrigerated hash browns  
 8 green onions, sliced  
 1/4 cup oil  
 4 cloves garlic, finely chopped  
 1 teaspoon salt  
 1/2 teaspoon pepper  
 2 cups diced ham  
 2 cups shredded Cheddar cheese  
 6 eggs  
 Heat oven 450 degrees. Spray a jelly roll pan. Mix hash browns, onions, oil, garlic, salt and pepper. Spread evenly in pan. Bake 30 minutes. Stir then top with ham and cheese. Bake 20 minutes. Remove pan and make 6 wells in pan and crack egg in each well. Bake 7-9 minutes until eggs are set.  
**NOTE: You can put more eggs on if you like.**  
 \*\*\*\*\*



# Baking With Sugarbuns

By Michele Carlyon  
**The Pie Lady**

High school was easy, really didn't have to try; graduated number eleven in a class of over 400 and wasn't even close to being ready for the reality check that college was going to toss my way. Fast-forward to putting my mom's van in a ditch and deciding that was a sign from the universe that I wasn't meant to go to WSU; KSU won my loyalties and my money. After being influenced to not follow my heart I managed to lose all of my scholarships and got put on academic probation with the threat of being kicked out of school. At that point I finally decided to do what I wanted to do and switched my major to Hotel and Restaurant Management, knowing that when I finally grow up someday, I would love to have my own bakery. Best decision I have ever made.

I turned things around, got off of academic probation and was meeting people that finally had some similar interests as myself. Somewhere along the line of it all, I met Tiffany, who you all know as The Pie Lady. Our sassy personalities and the ability to laugh at things we probably shouldn't draw us together first; add in a class when I said some things I probably shouldn't have said to the instructor and our friendship was sealed. She led me to chasing a restaurant management dream and when life became overwhelming, she was there to help lead the way and quite frankly laid the groundwork and planted the seed that has landed me in a job that I absolutely adore with people that I wouldn't trade for the world.

Through it all there have been plenty of ups and downs, but one thing has always been consistent, an unwavering friendship that I never have to doubt. A listening ear, an honest opinion and the occasional much-needed reality check. She has become one of my closest friends, my chosen family, biggest supporter and one of my favorite people to bake with.  
 I am fiercely independent and one thing I generally don't do with any-

one else is bake, but if I let you into my baking world or if I am willing to step into yours, you've made it, you've made it into a forever friendship; Tiffany is one of the few people who has been able to cross into that world of baking. Some things just can't be said outright, but when you get lost in the love of baking or you're covered in flour, words come easy; she gets that. Life isn't perfect for either of us, ever, but I love seeing her chase her dreams, be a mom, a wife and an overall strong woman: she is truly an inspiration.

While my pie crust will never be as pretty as hers and I would never share her recipes, I do enjoy making the occasional pie. Here is my mom's favorite pecan pie recipe that I have been making her for years.

**PECAN PIE**  
 Pie Crust (either your own or store-bought)  
 6 tablespoons unsalted butter, cut into 1-inch pieces  
 1 cup packed brown sugar  
 1/2 teaspoon salt  
 3 eggs  
 3/4 cup light corn syrup  
 1 tablespoon vanilla extract  
 1 tablespoon bourbon (optional)  
 2 cups pecans (toasted)

To toast pecans, bake for 6-8 minutes at 350 degrees. Let cool completely. Pre-bake your pie crust according to instructions. While crust is baking, make filling. Melt butter in medium heat-proof bowl and sit in a skillet of water that is simmering. Remove bowl from skillet and mix in sugar and salt with wooden spoon. Beat in eggs, corn syrup, vanilla and bourbon. Return bowl to hot water, stir until mixture is shiny and warm (about 130 degrees). Remove from heat and stir in pecans. Pour pecan mixture into pie shell. Bake at 275 degrees for 50-60 minutes. Let cool completely and then enjoy.

Michele grew up in Junction City and graduated from Kansas State University. She worked in the restaurant management field for six years before deciding to switch careers and now works as an office manager for a company that manufactures oilfield products. Her passion for blogging and food can be followed on Instagram: [boobsbrainsandbaking](https://www.instagram.com/boobsbrainsandbaking).  
 If you would like to contact Michele with comments please email [mcarlyon88@gmail.com](mailto:mcarlyon88@gmail.com)

## Need Senior Insurance?

- ★ Medicare Supplement
- ★ Long Term Care
- ★ Final Expense

**800-373-9559**  
**PHILLIPS INSURANCE**  
*Jim- The Answer Man!*

## Prize for AUGUST 2020! "Our Daily Bread" Recipe Contest Prize

### Elsie Grace's PIE CRUST MIX



This mix makes the best pie crust you've ever tasted, but without all the work! Just follow the directions on the back of the package for an easy pie crust that's sure to wow your guests!

*Elsie Grace's*  
[Elsiegraces1.com](http://Elsiegraces1.com)

The winner each week is selected from the recipes printed. Send us your favorite recipe. It may be a main dish, leftover, salad, side dish, dessert, or what-have-you.  
 1. Check your recipe carefully to make certain all ingredients are accurate and instructions are clear. 2. Be sure your name, address and phone number are on the entry. Please include a street address with your recipe entries. A post office box number is not sufficient for prize delivery. Allow 3-4 weeks for delivery.  
 3. Send it to: Woman's Page Editor, Grass & Grain, Box 1009, Manhattan, KS 66505.  
 OR e-mail at: [auctions@agpress.com](mailto:auctions@agpress.com)

## COVID-19 can't stop Elsie Grace from turning 21!!

Come celebrate August 27, 28, 29  
**In store specials!**

Please wear your mask and practice social distancing.  
 Carry out only for lunch [Elsiegraces1.com](http://Elsiegraces1.com)

**Elsie Grace's**  
 123 N. Kansas Ave., Frankfort, KS  
 785-292-4438 • Follow us on Facebook!

**Hours:**  
 Mon.-Fri.: 9am-5pm  
 Saturday: 9am-3pm

## Visit One Of These Quilt Shops TODAY!

Be Sure To Let Them Know You Saw This Ad in Grass & Grain!

**Chris' Corner Quilt Shop**

Located just north of the Ottawa City limits.  
 3593 Old US Hwy 59  
 PO Box 222  
 OTTAWA, KS 66067

**785-242-1922**  
[chriscorner@sbcglobal.net](mailto:chriscorner@sbcglobal.net)

**\*CLOSED AUGUST 3-8**  
**HOURS:**  
 Monday-Friday: 9:30 am-5 pm  
 Saturday: 9:30 am-3 pm

LIKE US ON FACEBOOK!

**Hidden Treasures QUILT SHOP**

101 N. Commercial  
 MANKATO, KS 66956

*Luann Wilson, Owner*

E-mail:  
[hiddentreasuresquiltshop@nckcn.com](mailto:hiddentreasuresquiltshop@nckcn.com)

**HOURS: Monday-Friday**  
 10:00 AM to 6:00 PM  
**Saturday: 10:00 AM to 5:00 PM**

LIKE US ON FACEBOOK!

**Quilters' Paradise**

713 8th Street,  
 BALDWIN CITY, KS  
**785.594.3477**  
[www.quiltingfabricsupply.com](http://www.quiltingfabricsupply.com)  
[www.facebook.com/quiltersparadiseks](http://www.facebook.com/quiltersparadiseks)

## AUCTION NOTICE \* CONSIGN NOW!

**St. James Catholic Church**  
 Upcoming CONSIGNMENT AUCTION  
 SATURDAY, DECEMBER 5, 2020  
 Wetmore, Kansas

**EARLY CONSIGNMENTS Contact:**  
 Bill Burdick: 785-547-5082 \* Ron Burdick: 785-207-0434

**Material Girls quilt shop**

306 N. Buckeye  
 ABILENE, KS 67410

Phone: 785-263-7787

[www.etsy.com/shop/materialgirlsqilt](http://www.etsy.com/shop/materialgirlsqilt)  
[www.facebook.com/materialgirlsqiltshopabileneks.com](http://www.facebook.com/materialgirlsqiltshopabileneks.com)

LIKE US ON FACEBOOK!

**G&G QUILTERS!**  
 If you have a Quilting Tip you would like to share, please email [shelby@agpress.com](mailto:shelby@agpress.com) or give us a call at 785-539-7558!

If your quilt shop would like to be included in this EXCITING GROUP AD ...

**Give Us a Call Today!**  
 785.539.7558

**Overbrook Quilt Connection**  
 A Full Service Quilt Shop!

500 Maple (Hwy. 56)  
 OVERBROOK, KS 66524  
 Phone: 785-665-7841

Quality Quilting Fabrics  
 Patterns, Books & Notions  
 Classes  
 Mention this ad & receive a FREE GIFT!

[ogc@embarqmail.com](mailto:ogc@embarqmail.com)  
[www.overbrookquilts.com](http://www.overbrookquilts.com)

**HOURS: Tuesday-Saturday**  
 10:00 AM to 5:00 PM

LIKE US ON FACEBOOK!

# THE WAIT IS OVER!

Volume 7 of the Grass & Grain  
 "Our Daily Bread" cookbook is finally here!!

Picking up where we left off, you can now enjoy a compilation of nearly 80 pages of unique & delicious recipes from "Our Daily Bread" circa 2014, including a few home recipes from the G&G staff!

**Stop by and get yours or call in & place a mail order today!**

**\$15/ea., + \$3 shipping to U.S.**  
 Earlier editions also still available!

**NEW!**

Grass & Grain  
 Recipe Collection  
 Volume 7

**GRASS & GRAIN**  
 785-539-7558  
 1531 Yuma St • Manhattan, KS



**Dining With Diabetes Course Offered In Online Format**

By Barbara Ames, Family & Consumer Sciences Agent  
K-State Research and Extension, Wildcat District will be offering Dining with Diabetes in a convenient online format beginning August 17. This is a national Extension program designed to boost the health and wellness of Kansans with Type 2 diabetes or pre-diabetes and help educate their family members, caregivers and others who support them.

Similar to the face-to-face Dining with Diabetes classes previously offered, the online course will offer participants access to a new learning module each week for four weeks. Three months after the class ends, participants will be given access to a free follow-up class called Dining Out with Diabetes. Classes will be available online to access at your convenience. Each

class will include informational handouts and recipes to print as well as videos of cooking demonstrations.

To register for the Dining with Diabetes Online Course, visit <https://bit.ly/diningonline> to join the class and pay the \$25 registration fee. Registrations are due by August 10, and class size is limited. For questions, please contact the Independence Wildcat District Extension Office at 620-331-2690 or email Barbara Ames at [bames@ksu.edu](mailto:bames@ksu.edu).

About one in 10 Kansans has been diagnosed with diabetes, a chronic disease characterized by elevated blood sugar (blood glucose). High levels of blood glucose are a result of inadequate production of insulin or a resistance to the effects of insulin, a hormone produced by the pancreas.

Diabetes is a common, serious, and costly disease. However, there is good news

for persons with diabetes. Diabetes can be controlled. Studies show that complications of diabetes, such as blindness, kidney failure and amputations, can be prevented if blood sugar is controlled most of the time. Following a meal plan is the first step in controlling blood sugar. For some, this is also the hardest step in diabetes control.

Dining with Diabetes can help. Learn strategies to manage diabetes through menu planning, carbohydrate counting, portion control and label reading. Observe videos of cooking demonstrations and download the recipes. Sign up to learn more about how to take charge of your diabetes for life.

An informational flyer can be downloaded from the Wildcat District website at <http://www.wildcatdistrict.k-state.edu/events/>



**Be Like Buddy**

By Lou Ann Thomas  
Once upon a time, there was a bunny named Buddy. Buddy was always ready and willing to help any of the other rabbits in his hutch. If you needed help moving, Buddy was there. If you needed someone to take you to the store or doctor, Buddy was just a hop away.

ever he stepped outside his hutch. But as Buddy moved about he noticed not all of the bunnies were wearing their protective booties. Even as the incidents of Forest Pox continued to increase, the No-Boots group refused to wear them and many of the dissenters were loud and mean-spirited in their rebuttal, and even made fun of Buddy and others for wearing them.

That's why when the deadly Forest Pox set in, Buddy worried. The Forest Pox was not only a threat to the woodlands, crucial for the rabbits and other creatures' survival, but the Pox could also infect bunnies through the pads of their feet.

From what he could determine, the No-Boot group didn't like being told what to do and rejected rules, mandates, even gentle suggestions to wear boots. Buddy didn't understand this since there were plenty of other rules as to how to behave in the interest of the greater good and by far most of the bunnies followed them.

Several rabbits in Buddy's hutch had gotten sick, a few had even died, so when Pox experts suggested that wearing fabric coverings on their paws could help control the spread of this deadly disease, Buddy was on board and wore his booties when-

The more Buddy lis-

tened to the No-Boot group, the more disheartened he became. His fellow rabbits were so divided and wouldn't even listen to each other. It was as though a Fox had gotten into their heads and was telling them lies, which they chose to believe. Buddy didn't understand. To him this was about caring for the entire Rabbit Nation, and even if the experts were wrong, wearing protective booties created no more than a minor inconvenience. But, if the experts are right, and one bunny might be saved, Buddy believed it was the right thing to do.

“What has become of the Rabbit Nation? Do we no longer care about each other?” Buddy wondered. Buddy felt shame at what he heard and saw. “I can't believe this is happening!” Buddy said. “I would gladly give my right foot, for us to return to treating each other, even those who disagree with us, with dignity and civility.”

And that, my friends, is how the Lucky Rabbit's Foot can to be. May it also be a reminder of how important it is to treat each other like a Buddy, rather than a Bully.

**Summertime! It's Time For Older Kansans To Apply For Senior Farmers' Market Vouchers**

Kansans age 60 or over who meet income guidelines and who shop in farmers' markets in Kansas can boost their health and their wallets thanks to a program that provides money through vouchers to qualified older Kansans.

The North Central-Flint Hills Area Agency on Aging (NC-FH AAA) announced that applications are now available for the Kansas Senior Farmers' Market Nutrition Program (KSFMP). This popular program provides \$35 in vouchers to Kansans age 60 or better who meet income guidelines. Vouchers can be used to purchase fresh, nutritious, unprepared, locally-grown fruits, vegetables, herbs and honey from participating farmers at local farmers' markets.

Those who wish to apply for the \$35 vouchers — or to find out if they qualify — should contact the NC-FH AAA at 785-776-9294 or 800-432-2703. Applications for this program are also avail-

able on the Agency's website at [www.ncfhaaa.com](http://www.ncfhaaa.com).

To qualify, seniors must be age 60 or older and have an annual gross income at or below \$23,606 — which is \$1,968 per month. Vouchers are distributed on a first come, first served basis and may be used at participating markets from now to November 1, 2020. Eligible Kansans from anywhere in Kansas may shop at participating farmers' markets with the vouchers.

“The Kansas Senior Farmers' Market Nutrition Program is a great way for older Kansans to add more fruits and vegetables to their diets — and is a fantastic way to support local farmers and farmers' markets, too,” said Julie Govert Walter, Executive Director of the North Central-Flint Hills Area Agency on Aging (NC-FH AAA). “We're delighted to work with the Kansas Department of Health and Environment and other Kansas Area Agencies on Aging on this initiative,” she said.

Walter said that The Kansas Department of Health and Environment would like to expand this program, since it boosts the success of farmers' markets while improving nutrition options for Kansans. Farmers interested in accepting vouchers should contact Warren Hayes at the Kansas Department of Health and Environment Nutrition Program at 785-296-8060.

For more information about Senior Farmers' Market Vouchers or to request an application call the North Central-Flint Hills Area Agency on Aging (NC-FH AAA) toll free at 800-432-2703 or go to [www.ncfhaaa.com](http://www.ncfhaaa.com)

**Kansas POWERTRAIN & EQUIPMENT LLC**  
**785-861-7034**  
1534 NW TYLER  
TOPEKA, KANSAS  
Your Parts & Service  
Headquarters for 10 years  
Complete Drivetrain Specialists • Drive Shafts  
Rear Ends and Heavy Duty Parts

**CENTRAL KANSAS AG AVIATION**  
Call for all your Spring spraying needs!  
  
STEVE DONOVAN  
Cellular: 785-366-0513 • Office: 785-258-3649

**BARN BUILDERS DT CONSTRUCTION**  
918-527-0117  
Free Estimates! All Workers Insured Est. 1977  
One Year Warranty  
  
30x50x10 enclosed..... Galvalume \$9,100  
12' slider, 1 walk door...Colored metal \$10,100  
40x60x14 enclosed  
2 12' sliding doors..... Galvalume \$16,100  
1 walk door.....Colored metal \$17,500  
40x100x16 enclosed  
20' split sliding door..... Galvalume \$24,600  
1 walk door.....Colored metal \$26,600  
Price includes labor and material.  
www.DTCBarns.com

A Complete Cattle Feeding & Marketing Service  
**TIFFANY CATTLE CO., INC.**  
Family Owned & Operated  
Tiffany Cattle Company, with a total capacity of 32,000 head, is equipped to offer economies of scale and industry leading service to customers of any size.  
Production Services  
Objective is simply: Least Cost Per Pound of Gain!  
Ration formulation and cost analysis, health program designed and maintained by veterinarian, special pens and attention to sick animals, feed financing and cattle purchasing available.  
Marketing Services  
Marketing finished cattle is top priority at Tiffany Cattle Company. You have the option of selling on the cash market, forward contracting or grid pricing through multiple Kansas packers.  
★ www.tiffanycattle.com ★  
Follow us on at Tiffany Cattle Company  
Tiffany Cattle Company 1333 S. 2500 Road Herington, KS 67449 (785) 258-3721  
Tiffany Cattle West 758 Pioneer Road Marquette, KS 67464 (785) 546-2216  
Shawn Tiffany - COO (785) 229-2902 shawn@tiffanycattle.com  
Shane Tiffany - CEO (785) 466-6529 shane@tiffanycattle.com  
Dennis Roddy - CFO (620) 767-2139 dennis@tiffanycattle.com  
Tanner Stucky - Asst. Mgr. (620) 214-0979 tanner@tiffanycattle.com

Need an extra copy of **GRASS & GRAIN?**  
Pick one up at any of our Box locations:  
  
**Dara's Fast Lane:**  
- 5321 Tuttle Creek Blvd, Manhattan. KS -  
- 8811 US-24, Manhattan. KS -  
- 1132 Pillsbury Dr., Manhattan. KS -  
**Sharp's:**  
- 118 W. Randolph St., Randolph. KS -  
**The Store:**  
- 104 E Barton Rd., Leonardville. KS -  
Copies are also available at these businesses:  
**Bluestem Farm & Ranch:** - 2611 W. Hwy 50, Emporia. KS -  
**Pioneer Farm & Ranch:** - 427 NE 14th Abilene. KS -  
Or Stop by the Grass & Grain Office:  
- 1531 Yuma St., Manhattan. KS -  
**Office Hours:** Monday-Friday, 8am-5pm

“Alexa, turn on KFRM”  
“The Voice of the Plains”  
**KFRM 550 AM**  
Streaming 24-7  
Download the KFRM App and Listen Anytime, Anywhere!  
  
NEBRASKA  
Wray, Grand Island, McCook, Goodland, Hays, Salina, Topeka, Emporia, Garden City, Hutchinson, Dodge City, Alva, Woodward, Ponca City, Enid, OKLAHOMA, OK City



# COAXIUM WHEAT PRODUCTION SYSTEM. IT WORKS.



Sometimes all you need to hear is what you see.

Side by side superiority.

CoAXium® Wheat Production System driven by Aggressor® herbicide.

Now a proven option for control of downy brome and feral rye.

Go to [CoAXium.com/performance](https://CoAXium.com/performance)  
to see more extraordinary field photos.





---

**CLEANER FIELDS. HIGHER YIELDS.®**

---

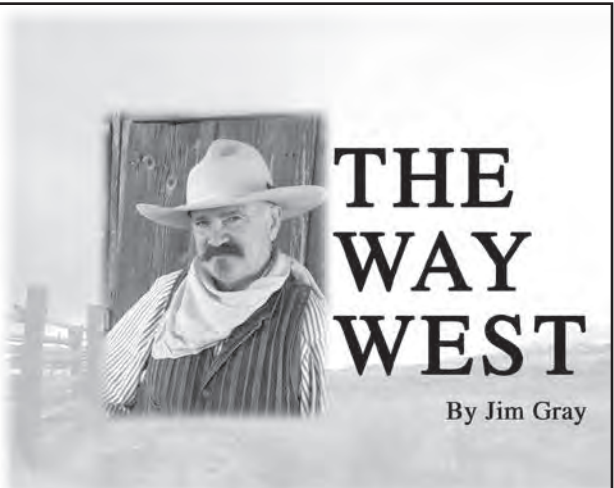



# THE WAY WEST

By Jim Gray

## Seward County Conflict

Established along the north bank of the Cimarron River, Fargo Springs was developed to become the Seward County Seat. Much to the consternation of the residents of Fargo Springs, Kansas Governor John Martin, on June 17, 1886, awarded the temporary county seat to Springfield. The designation was but a preliminary act to open a legal point of reference until an election could be organized in the new county. An official election was necessary to validate the county seat chosen by the county residents. Unfortunately, Fargo Springs and Springfield were in the same precinct. County commissioners slated the election for August 5, 1886, with both towns voting at Fargo Springs.

Passionate divisions in Seward County were noted by several newspapers across the state of Kansas. One account, found in several papers, declared that "the fight waxes warm" in Seward County. Abe K. Stouffer, the editor of the *Fargo Springs News* posted a letter "By a Voter," that told of Springfield's collusion with Meade County to forward Springfield in the election. Until declared an official county the proposed Seward County was attached to Meade County for official business. "Voter" described an attempt by the "Springfield gang" to intimidate workers in the construction of buildings on the town square. Proof of their "ruffian disposition" was

openly displayed when Springfield men armed themselves with deadly weapons. "Words of profanity...fell from their lips." but the attempt was bravely ignored.

Just days before the election officials at Fargo Springs learned that Meade County Sheriff Travis McKibben and fifty deputies were coming to the election in support of Springfield. Until the election was finalized, Seward County fell within Sheriff McKibben's jurisdiction. On the eve of the election at twelve a.m., armed men from Springfield arrived on the streets of Fargo Springs. When they were met by the Fargo boys, "they prudently beat a hasty retreat."

When the "Springfield gang" returned at six a.m. a large crowd of reinforcements from Meade County, including the sheriff were counted in the mob. "A very large majority of these people were walking arsenals and were loud in their demands that they were going to have the election officers."

The election officers and fifty to sixty Fargo men were secured inside the polling place. To preserve their safety voters were told to mark their ballots and pass them through a window, further infuriating the Springfield men.

When the polls opened at 9 a.m., J. Malcombed

Johnsing led the Springfield mob to break in the door. With the help of Sheriff McKibben they hoped to arrest the election officials. But the sheriff suddenly stepped between the mob and the door shouting, "I won't break the door open and I won't arrest them; they haven't done anything that I can arrest them for."

Johnsing wasn't done. From a perch on a nearby wagon, Johnsing implored the mob to overpower the sheriff and capture the polls. Sheriff McKibben stood firm, backing his position with the admonition that the Springfield men were "beaten at their own game."

Having failed to gain control of the polls, the Springfield mob refused to pass their ballots through the window. Instead, they secured a soapbox from Billy Green's grocery and placed it on a farm wagon to serve as the receptacle for their ballots. At the close of the day the soapbox was presented to the election officers who declared the soapbox ballots invalid and ordered them thrown out. That did not sit well with Springfield men. With several Winchester rifles in hand, the soapbox was reluctantly

preserved by the election officers. The results were scheduled to be canvassed on Saturday August 7th, at Springfield's courthouse, described by a Fargo Springs supporter as "a little shanty." The canvassing for county officers was accomplished throughout the afternoon. Outside, a huge crowd "swayed backward and forward like an ocean beneath a tempest..." By the time that the county seat vote had been counted "the shades of night had fallen."

When the officers opened the door to announce the results of the election a crowd of about seventy-five men poured into the room. Fargo Springs had won the vote, but realizing they were in danger, the canvassing was

adjourned until Monday. The *Fargo City News* announced the results with an edition printed in red ink. Fargo Springs had won the county seat by a majority of two hundred forty votes. The elected county officers brought the records from Springfield and commenced business at Fargo Springs. But Springfield was not yet done. Seward County would see more conflict for several more years, giving us many more stories to tell on The Way West.

"The Cowboy," Jim Gray is author of the book *Desperate Seed: Ellsworth Kansas on the Violent Frontier, Ellsworth, KS.* Contact Kansas Cowboy, 220 21st RD Geneseo, KS. Phone 785-531-2058 or [kansascowboy@kans.com](http://kansascowboy@kans.com).

**STEEL BUILDING INVENTORY SALE!**

I-BEAM CONSTRUCTION • EASY BOLT-UP DESIGN

**DON'T MISS OUT ON OUR 50' X 100' X 16' SPECIAL PRICE!**

**316-559-0759**  
sales@toplinebuildings.com  
toplinebuildings.com

**LONGSHOT BAR & GRILL ONLINE AUCTION \* Chase, KS**

**Selling Restaurant Equip. including** Hot Bar \* Commercial Frig \* Cooking Grill \* Take out: cups, lids, flip lid containers \* Stackable Chairs \* Bar Stools & Bars \* Electric Beer Signs \* Mugs, glasses, pitchers, restaurant china & much more!

**BIDDING Thursday, August 6, 8:00 AM - Wednesday, August 12, 8:00 PM**

**Auction & BIDDING Information available 8-1-2020 at:**  
<https://hollingerauction.hibid.com/auctions/current>

**HOLLINGER ONLINE AUCTIONS, Lyons, KS — Jim & Mary 620-257-8148**  
Pickup: Friday, August 14 • 1:00-7:00 p.m.

**C&W FARM SUPPLY INC**  
PROUDLY SERVING YOU SINCE 1959

**785-374-4521**  
Fax: 785-374-4458  
Email: [cwfarmsupply@hotmail.com](mailto:cwfarmsupply@hotmail.com)  
Web: [www.cwfarmsupply.com](http://www.cwfarmsupply.com)  
PO BOX 257  
COURTLAND KS 66939

**FARM HARD AG. PRODUCTS**  
**BY HOFFMAN BROTHERS WELDING LLC**  
405 CENTRAL STREET HOYT, KS/785-986-6310

## Advantage Series Overhead Feed Bins

**Patent Pending! No. 29/694.456**

20% more storage than a round bin, better clean-out than a square!

**More space! Better clean-out!**

[www.fcsmfg.com](http://www.fcsmfg.com) • (620) 427-4200  
FCS Mfg. Inc • Gridley, KS

### OIL FIELD PIPE & PIPE POST SPECIAL

Pipe Pricing Per Foot			
2 3/8"	\$1.25	2 7/8"	\$1.50
3 1/2"	\$2.50	4 1/2"	\$3.75

Post Pipe Per Post	
2 3/8" X 8'	\$14
2 7/8" X 8'	\$16
2 3/8" X 9'	\$16
2 7/8" X 9'	\$18
2 3/8" X 10'	\$18
2 7/8" X 10'	\$20

**HAY SAVER BALE FEEDERS**

HEAVY DUTY HORSE FEEDER.....	\$625.00
HEAVY DUTY SINGLE BALE FEEDER .....	\$595.00
SINGLE CONE INSERT .....	\$395.00
HEAVY DUTY DBL. BALE FEEDER.....	\$995.00
DOUBLE CONE INSERT .....	\$695.00
BIG SQUARE BALE FEEDER.....	\$595.00

**FEED BUNKS & PANELS**

20' PIPE BUNK OPEN END 24" .....	\$475.00
20' PIPE BUNK CLOSED END 24" .....	\$525.00
20' BOTTOMLESS GROUND HAY FEEDER..	\$825.00
20' LONG X 24" PIPE BUNK W/NECK RAIL OR HEAD FENCE .....	\$695.00

**Call for Current Prices!**

### SPRING IS HERE!

Order your Panels today.

**CONTINUOUS PANELS**

4 BAR 14 GA. 20'x4' Tall .....	\$69.00	\$65.00
5 BAR 14 GA. 20'x4' Tall .....	\$85.00	\$75.00
6 BAR 14 GA. 20'x4' Tall .....	\$95.00	\$85.00
7 BAR 14 GA. 20'x4'9" Tall.....	\$140.00	\$100.00

**FREE STANDING PANELS**  
20' Long by 6' Tall w/adjustable legs .....
 \$320 |

**Free Standing Panels Gates**

4' .....	\$95
8' .....	\$150
10' .....	\$165
12' .....	\$195
14' .....	\$210
16' .....	\$235

Prices may be subject to change with material cost & adjustments.  
[www.hoffmanbrotherswelding.com](http://www.hoffmanbrotherswelding.com)

**DISTRIBUTORS**

Wohlgemuth Equip., Atchison, KS 913-370-1245  
B&D Ag Solutions, Savannah, MO 816-344-9381  
Hoffman Farms, Friend, NE 402-947-3901  
Dailey Ag LLC, Oskaloosa, KS 785-863-2011

# Superior genetics ... locally grown™

**KAUFFMAN SEEDS**  
Haven, KS  
**620-465-2245 • 620-727-3567**

**Bob Dole, SY Monument, SY Benefit, SY Grit, SY Wolverine, SY Rugged**

**PLAINSMEN SEED**  
**Palco, KS • 785-221-1682**

**SY Monument**

**POLANSKY SEED**  
Belleville, KS • 800-372-2271  
**SY 517CL<sup>2</sup>, SY Monument, SY Wolverine, Bob Dole, SY Achieve CL<sup>2</sup>**

**SEEMAN FARMS**  
Larned, KS  
**620-285-5288 • 620-285-1357**  
**SY Rugged, SY Monument, Bob Dole**

**MILLER SEED FARMS**  
Partridge, KS  
**800-567-3125**  
**AP EverRock, Bob Dole, SY Monument, SY Rugged, SY Achieve CL<sup>2</sup>, AP503 CL<sup>2</sup>**

**CALL US FOR ALL YOUR SEED NEEDS!**



# 2020 4-H YOUTH SHOWCASE



Trent Norris, 8, Ellsworth County, Elkhorn, received a blue ribbon in the bucket calf show with his calf, Emmett.

**With all the changes to County Fairs brought on by COVID-19, Grass & Grain wants to celebrate the accomplishments of the 4-H'ers by showcasing their projects. Send your photos, the name of the 4-H'er and a brief description of their project to [gandgeditor@agpress.com](mailto:gandgeditor@agpress.com). The photos will all be published throughout the rest of the summer and fall.**



Cord Norris, 6, Ellsworth County, Elkhorn club, showed "Lisa," his bucket calf in the Cloverbud tag-along bucket calf show.



Josepha Inlow is a 13-year-old member of the Bazaara 4-H Club in Chase County and enjoys taking animal pictures. Josepha could only take two photos to the fair and chose these buffalo pictures which received two blue ribbons.



Kole Kroupa, age 9, is a member of Tampa Triple T's 4-H Club. This was his first year in the rocketry project and he is pictured being judged at the Marion County Fair. He earned a purple ribbon.



## AbileneMachine®

Ag Replacement Parts



**Looking for Skid Steer Parts? We've Got 'Em!**

*New and Used Parts Available*

*Seats, Glass, Engine Parts, Lights AC Parts, Radiators and More ...*



**Air Conditioning Parts**



AC Parts for many makes & models. Conversion kits upgrade your old system to a modern, more efficient system.

**Toll Free: 800-255-0337 • [AbileneMachine.com](http://AbileneMachine.com)**

 Follow us on Facebook

**BMH HARVESTING**

Conveniently located in northeast Kansas and focused on servicing any and all producers.



- Dependable and Experienced
- All Silage, Haylage Earlage Equipment to support any job
- Yield Mapping
- Field monitoring to ensure proper harvest moisture & conditions

**Brian Hagedorn**  
 785-458-2137  
 9760 Onaga Rd • Wamego, KS 66547  
[BMHHarvesting.com](http://BMHHarvesting.com)



# A CENTURY OF SUDDEN SERVICE™

**PREMIUM PRODUCTS. QUALITY PROTECTION.**

At Star Seed, not only do we offer premium certified wheat varieties, but our fungicide and insecticide packages will take your crop performance to the next level. Choose from our lineup of high-yielding single varieties or a blend, designed for diversity. Our wheat seed treatments are proven in controlling numerous seed and soil borne diseases while guarding against insect damage. For over a century we have been dedicated to offering premium quality products with the service our customers deserve.



*green and always growing™*

[info@gostarseed.com](mailto:info@gostarseed.com)  
 For more information, visit:  
[www.gostarseed.com/LP](http://www.gostarseed.com/LP)

CALL TODAY TO DISCUSS YOUR SEED TREATMENT NEEDS!

800-782-7311





**GENERATIONS**  
REAL ESTATE & AUCTION



FARM EQUIPMENT AUCTION

Saturday, August 8, 9:00AM

259 1400 Ave, Solomon, KS 67480  
*Arvin and Virginia Eilders, Sellers*

Excellent Line of Well-Maintained Equipment



JD 7720 Titon II Combine, IH 1086 Tractor w/Cab, GP SS 24 Drill, Bradford Grain Wagons, Ford 800 Grain Truck, 20ft Livestock Trailer, Gehl 95 MixAll, JD 30ft Cultivator, JD 26ft Disc.



Farmall M, Farmall F-30, McCormick W-6, and much more.



This will be an on-site live-webcast auction. For complete details go to [genkc.hibid.com](http://genkc.hibid.com).  
**Kevin Berger, Auctioneer; (913) 940-5494**  
**Lenny Mullin, Auctioneer; (913) 915-0468**



**genkc.hibid.com**



# 2020 4-H YOUTH SHOWCASE



Josey Norris, 10, Ellsworth County, Elkhorn Club, received reserve champion in the Fashion Revue and grand champion in Clothing Construction on her recycle outfit.



12-year-old Kaitlyn Sohnrey is a member of the Humboldt 4-H Club in Geary County. She received a blue ribbon on this craft project.

**grassandgrain.com**  
place a classified ad renew a subscription



Kaitlyn Sohnrey sold her apple pie in the premium auction held online.

**CHECK US OUT ON**  
  
**GRASS & GRAIN**



Kaitlyn Sohnrey also participated in the clothing buy-manship project with this cute purple jumpsuit.



Austin Sohnrey, 8, belongs to the Humboldt 4-H Club in Geary County and chose this outfit for the clothing buy-manship project.



Austin Sohnrey earned a blue ribbon with his button craft.

**KANSAS FARM BUREAU**  
Health Plans

Kansans who switched their health coverage to Kansas Farm Bureau Health Plans saved an average of 50% to 60% per month on healthcare coverage.

Call us toll free at 1-833-282-5928, visit [kfbhealthplans.com](http://kfbhealthplans.com) or contact a Farm Bureau Financial Services agent near you.

And, if you're over 65, we have options for you, too. Call, click or visit an agent to learn more.



## Kid's Corner

Enjoy the activities below!

### I Spy Down on the Farm

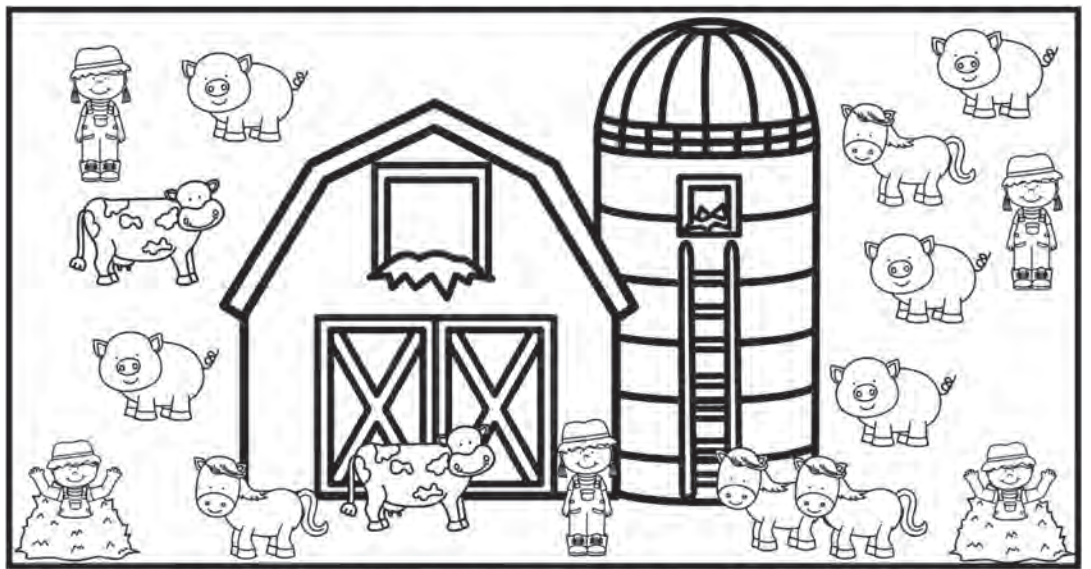

Directions: Can you spy these pictures in the box? Write how many you find on the line.



\_\_\_\_\_



\_\_\_\_\_



\_\_\_\_\_



\_\_\_\_\_



\_\_\_\_\_ ©Jenny-Lynn Creations



\_\_\_\_\_

### Word Scramble

- R E R M A F = \_\_\_\_\_
- C I C H K N E = \_\_\_\_\_
- N B A R = \_\_\_\_\_
- R T A T R C O = \_\_\_\_\_
- P E H E S = \_\_\_\_\_

### Sudoku

Fill in the grid with the numbers 1, 2, 3, and 4 making sure no number is repeated in each row, each column, and within each mini grid.

			3
	4		
		1	
			2



# State 4-H leader looks to past in forging future

The leader of the Kansas 4-H program said that looking at the organization's past is one way that it will overcome the challenges it has faced the past several months.

Like so many other groups, Kansas 4-H had to adapt its programs quickly due to the COVID-19 pandemic. Only recently –

July 5, nearly four months since much of the United States first closed down – has the organization been given a green light to resume some in-person activities.

Wade Weber, the state leader for Kansas 4-H, said two showcase events – the county and state fairs – are examples in which

youth and families have had to adapt quickly.

“We have a rich history of young people being involved in their community, and learning to work together to be problem solvers, innovative and creative,” Weber said. “We’ve always worked to expand opportunities for young people to belong to their local 4-H program, all the way back to our beginning in 1905.”

Weber cited a familiar quote from the state's first 4-H leader, Otis Hall, who said: “We’re not trying to make farmers out of all these youth. We don’t care how many hogs or cabbages they raise; it’s the youth we’re interested in. We’re trying to build self-reliance, good judgment and character. For many, 4-H is a stepping stone for those larger life skills.”

Hall, who created the 4-H Pledge that is recited in every club across the country, led Kansas’ program during stressful

times: World War I and the 1919 Spanish Flu pandemic. Weber said today’s 4-H leaders, volunteers and youth can benefit from his wise words.

“I think it really speaks to us 100 years later about the resiliency they were developing, and how they were trying to develop young people,” he said. “I think it’s something for us to be encouraged by as we think about moving forward.”

Weber said Kansas 4-H members and volunteers can also draw strength from another former leader, Glenn Busset, who helped steer the program through turbulent times in the 1960s and 1970s. Busset believed that empathy and drive are two critical elements when times are tough.

“Empathy is the important central ability to feel as the other person does. Drive is the energy to want to do something,” Busset said. “There must be a delicate balance between empathy and drive. Too much empathy will lead to little accomplishment. Conversely, too much drive with too little empathy will often bulldoze and harm others in pursuit of accomplishments in order to fulfill their own ego.”

Weber called Hall’s and

Busset’s wisdom “timeless phrases” that are important for today’s 4-H programs. “I think they help to put us in a great position to think about the challenges we have in 2020,” he said. “I think right now is a great time to think about where we want to see ourselves moving, and then help each other along.”

Weber listed three ways that Kansas 4-H can focus on as it moves forward:

Be flexible, adaptive and resilient in working with youth, family and volunteers. “Engagement is key; we can’t abandon them.”

Be authentic in learning from and serving communities and families who are different from our own experience. Expand the circle of belonging in 4-H.

Create a better blend of in-person and distance learning opportunities, which can lead to career and college-ready skills.

“Those are the three things that I think are really key to our future,” Weber said. “A lot has been learned and done, but there is a lot left to learn and accomplish. In reality, this era is ripe for innovation, confidence-building, excellence, belonging, and intentionality pursuing our 4-H mission.”

## Glenn Busset: Principles for working with youth

Glenn Busset, who led the Kansas 4-H program from 1966 to 1981, proposed three principles for working with youth:

Love them. Have kind regard for the ideas and feelings of each youth. They should be able to count on you to be understanding and free from prejudice. Expect that each youth will make their own unique contribution and that contribution is important. By doing this, you affirm that youth belong.

Limit them. In 4-H, youth can help set boundaries for the group to function. Youth may not like these boundaries and they should have the opportunity to say so and consider ways of changing them. All of us must learn to function within certain boundaries and to consider changing them if they are not right. Democracy is as much a limiting process as it is a freeing process.

Help them achieve. Unless youth have a sense of accomplishment and achievement, feelings of inferiority can develop. They will feel success from their 4-H work when recognized by adults for their progress. Youth development is the most important outcome of the 4-H club program.

**Renew your Grass & Grain subscription Online - it's easy!**

Visit [www.GrassAndGrain.com](http://www.GrassAndGrain.com)



Click 'Subscribe To Grass & Grain' and follow the prompts!



Having trouble? Give us a call! 785-539-7558

## ANTIQUe AUCTION

SATURDAY, AUGUST 8, 2020 — 9:30 AM

Auction will be held in Kenwood Hall at the Saline Co. Expo, 900 Greeley in SALINA, KS

JEWELRY, LAMPS, INDIAN, TOYS, COLLECTIBLES, SHOWCASES

50 Lamps: (large assortment of hanging lamps electric & kerosene inc: 1880 cranberry hall hanging; 1890 cast iron large store lamp; Aladdin; Greek Key; Riverside; Wil-drose; Dew Drop; cast iron base; pink opalescent base lamp; Peanut; finger; Queen Heart; many early lamps; owl & star lamp chimney; floor lamp w/jadite & beaded shade; bridge lamps; assortment of lamp parts); **INDIAN:** (Indian sterling necklaces signed; bear claws; rings; many pieces turquoise jewelry; Navajo rugs; Chimyo wall hanging; Scookum dolls; 40" Tepee); Sauteo Mexican throw; Jewelry Gold & Sterling: sterling flatware; mesh purses; watch fobs inc: 1915 Jewell Co. Festival 1st prize; hat stand; **1971 Rusty Phelps bronze "Howdy" 2 of 12;** G E Radio 1930's band figure very unusual; **Oak 6'x8'** tall step back store cabinet; oak 4'x7' back store cabinet; 8' marble base showcase from Sietz Shoe store Salina; curved glass table top house showcase 2'x26"x30"; 5' floor showcase folding; 37"x44" slant

front showcase; 19"x43" slant front showcase; 15"x12" table top showcase; 27"x45"x27" oak table top showcase; rare double sided music stand; 20' Hoosier cabinet; early 2 door 36"x6' cabinet w/cubby holes at top; 7' oak drop front secretary; unusual area advertising card table; 6 drawer oak glasses case; smoke stand; barley twist book shelf; 1 door display; revolving bookcase; li-brary table; wicker parlor table; 4 ice cream chairs; brass rotary candle stick telephone; Art Deco lady & dog statue; marble soldier statue; weather vane from Waconda Springs cabin; Deco mirror; 1917 organ tuner; 1877 cigar lighter; Zenith wind generator radio shortwave w/box & papers; oak & glass ballot box; Signed stain glass window; unusual bell tree; unusual ice cream scoop; Clocks inc (German; New Haven; Deco; other); Watches some coin silver; assortment of pictures inc: yard longs; **TOYS:** Mamod steam engine car; Arcade truck professional restored; many 50's trucks & cars; many cast iron toys & banks; The Royal Blue electric train w/boxes; Rich Toy rocking horse; Cass doll

dish cupboard, doll dresser & chest; airplane motor; hand-made covered wagons; beanie w/Cracker Jack pieces; **POT-TERY & GLASS:** Fulper decanter; VanBriggle; Roseville; Broadmore candle holders; Denver White piece; Weller Utopia vase; Weller umbrella holder; Brentley vase; cut glass; caster set; table sets; 1934 Colo State Fair Coors mug; carnival pieces; Vaseline Lazriod Bucuresti seltzer bottle; Hummel lamps; green depression; bisque Disney figures; marbles; Hires mug; 50's pieces glass; large assortment glass; Morning Glory phonograph horn; viewer & cards; Holliday Bros Lumber & Coal match holder; Heart shape commercial foot scraper; cast iron street sign hanger; street signs; pedestal sink yard bench; iron wheels; cast iron horse windmill weight; local car tags; 78 records many cowboy; 50's record player recorder; cast iron boiler; tins; transit; assortment granite; churns; large assortment of primitives; assortment kitchen pieces; lighters; razors; books; **Very large amount of other items not listed, this is a very large quality auction.**

This an individual collection. He has collected since the 70's and ran a shop for a time. He is retiring and moving. This is a very large auction. There are many very quality and unusual pieces. Check our website for a more complete list & pictures at [www.thummelauction.com](http://www.thummelauction.com). For safety if you are sick please call in your bids to 785-738-0067. Also wear your mask.

**INDIVIDUAL COLLECTOR**

Auction Conducted By: THUMMEL REAL ESTATE & AUCTION LLC 785-738-0067

## AUCTION

SUNDAY, AUGUST 9, 2020 — 10:00 AM

Auction will be held in Kenwood Hall at the Saline Co. Expo 900 Greeley in SALINA, KS

**Pottery:** Shawnee; Long-aberger; Dryden; McCoy; Frankoma; Coors; Redwing; spongeware; Van Briggle; Roseville; Denver Co. pottery; crocks; Western 5 gal; Sleepy Eye; RS Prussia; carnival glass; Flow Blue (serving pcs, bone dishes, other); kitchen type glassware; salt & peppers; Kitty Cat castor set; Fire King set; Fiesta inc: 6 3/8" cobalt bud vase & large platter; Jewelry (gold; sterling; Squash blossom; Indian; costume); lamps; hanging Aladdin; other; Toby mugs; Belleek; Cloisonne; Staffordshire; depression green Mother Goose & Rabbits; red water set w/ flowers; glass baskets brides & other; Fenton; cup & saucer collection; Lil Red Riding Hood cup; refrigerator glass; Johnson Bros Simpson plate; ladies pink dresser set; Art glass; double pickle castor; perfume bottles; salt dips; child's Hostess tea set; beer stein; cake plates; black amethyst; shaving cup; shaving brushes; bells; light shades; doll furniture; doll dishes; airplane candy container; Sandzen student painting 1920's; Paintings; prints;

Anderson Hall K State painting A Johnson; Indian blankets; 1971 Phillip Kreezkewski bronzes (Buffalo Hunt; Off Great Spirit; Holding Ground; Sergeant 7th Cavalry); 1972 Michael Gordman cowboy "Taking The Rough Off"; Thor-ton Burgess books; silver plate tea set; Singer feather weight sewing machine; candle mold; cigar mold; copper pieces; Gus Benz lard tin; scale; trumpet; cast iron Christmas tree base; wooden bucket; iron wheel child's wagon; WWII items (Fort Benning map; Dec of Independence; Bill of Rights; War rations); turquoise; fishing lures; cotton scales; sugar baskets; mannequin; Dazey churn; mirror plateaus; store knife display; Wooden barrels (powder, water); Keen Kutter items; Coca Cola ice chest; other Coke collectibles; light shades; hanky box; Old Onion seed jar; Marlboro & Bowl-up playing cards; beer tree; lady beer picture; photo album; bottle openers; sad irons; Fuller brush; Beatles poster; political pins; thermometers; cast iron circus wagon w/horses; other cast iron banks; Kodak

in store display camera; advertising pieces; fishing lures; snuff bottles; records; wagon & sleds; razors; knives inc: WWII commemorative; cigarette lighters; Remington pocket oiler; pocket watch chain; small coin collection; strong-box; silver plate; International silver set; spice racks; portable TV in case; oak wall telephone; transistor radios; Great National parks videos; sand dollars; shells; ice shaver; Griswold tea pot; Coca Cola bottle door pull; viewer & cards; levels; Billard & Billard flour sack; quilts; blankets; hankies; red Exit globe; books; Constitutional Amendment ballot box from Galva. **Furniture:** cast iron bed; short pie cupboard; flour bin; walnut drop leaf table; night stand; child's bed; walnut dr3esser w/wishbone mirror; ice cream table; rockers; Mission oak buffet; 42" round oak table; 9 captain's chairs; yarn winder; harness horse; wagon seat; wash bench; school desk; shaving mirror w/stand & bowl; oak medicine cabinet; fire place screen; **large assortment of other collectibles.**

**NOTE:** This is a large auction with many collectibles and glass. Check our website for pictures at [www.thummelauction.com](http://www.thummelauction.com). Please bring your masks for your safety. If you are not feeling well please call in your bids to 785-738-0067.

Auction Conducted By: THUMMEL REAL ESTATE & AUCTION LLC 785-738-0067



**Jim Phillips with Phillips Insurance uses Grass & Grain to create awareness about his company.**

Jim has advertised in Grass & Grain for over 25 years. Look for his weekly ad in the Women's Pages!

**"Name recognition is important to a business. You have to have consistency with your advertising."**

**You could also be reaping the benefits of Grass & Grain advertising!**

Don't hesitate, call today:

**785-539-7558**

Or stop by to talk with one of our advertising representatives:

Since 1954

# GRASS & GRAIN

1531 Yuma St. • Manhattan, KS

## 5,422+/- ACRES CROPLAND & GRASS TREGO & GRAHAM COUNTIES, KANSAS

### ABSOLUTE LAND AUCTION

WEDNESDAY, AUGUST 12, 2020 @10:30 AM, CDT

**AUCTION LOCATION:** VFW BUILDING, WAKEENEY, KANSAS

**SELLER:** THE BANK

LAND WILL BE OFFERED IN 21 INDIVIDUAL TRACTS!  
 •3,372.67 acres cropland  
 •2,049.52+ acres grassland  
 •Tracts 13 & 19 include farmsteads with 3 houses

VISIT OUR WEBSITE FOR LEGAL DESCRIPTIONS

•IMMEDIATE POSSESSION of cropland acres & unrented pasture acres!  
 •All Seller's interest in mineral rights will go to the Buyers, including any royalty income and SWD well income!

**OPEN HOUSE**  
 SATURDAY, AUG. 8, 2020  
 10:00 - 12:00  
 Agents will be onsite on Tracts 13 & 19 to show these properties!

INTERNET BIDDING AVAILABLE!

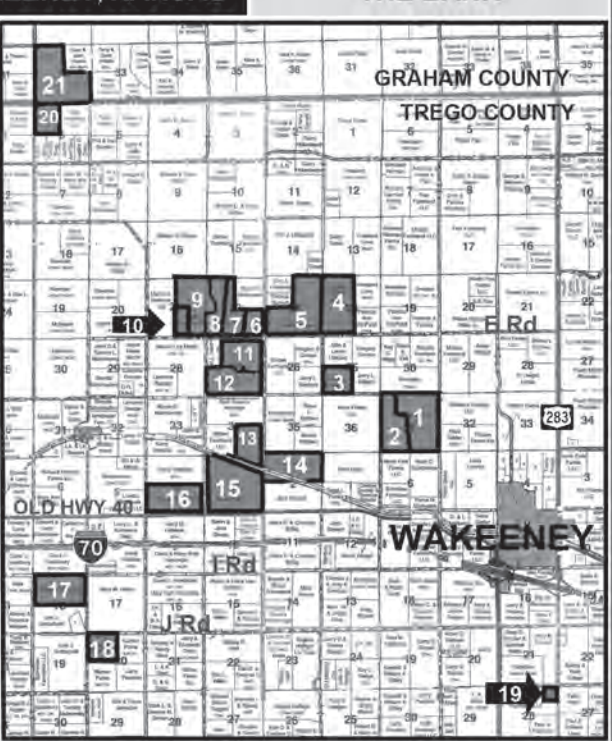

FOR COMPLETE SALE BILL VISIT [www.farmandranchrealty.com](http://www.farmandranchrealty.com)

## FARM & RANCH REALTY, INC.

NEAL MANN, Listing Agent (785-635-2102)  
 1420 W. 4TH • COLBY, KS 67701

Toll Free: 1-800-247-7863

DONALD L. HAZLETT, BROKER/AUCTIONEER

"When you list with Farm & Ranch, it's as good as SOLD!"



# Grass & Grain Area Auctions and Sales

Due to the uncertainty of recent events and the phases of re-opening, if you plan to attend any of the following auctions and have any doubts, please contact the auction company to confirm that the auction will be conducted and inquire about safety procedures if you are concerned. And please check their websites.

Always great online equipment auctions — [www.purplewave.com](http://www.purplewave.com)

**Longshot Bar & Grill Online Auction** (Bidding opens August 6, 8 am; Closes August 12, 8 pm; Chase, KS) — Selling Restaurant equipment including hot bar, commercial refrigerator, cooking grill, take-out items like cups, lids, etc., stackable chairs, bar stools & bars, electric beer signs, mugs, glasses, pitchers, restaurant china & more held online at [hollingerauction.hibid.com/auctions/current](http://hollingerauction.hibid.com/auctions/current). Auctioneers: Hollinger Online Auctions.

August 6 — Antiques, collectibles, guns, furniture, vintage, tools & more held at Osage City for Jim & Pat Croucher (Vassar, KS). Auctioneers: Wischropp Auctions & Real Estate.

August 8 — Farm equipment auction including combine, drill, grain wagons, grain truck, livestock trailer, cultivator, Farmall M, Farmall F-30, McCormick W-6 & much more held at Solomon for Arvin & Virginia Eilders. Auctioneers: Generations Real Estate & Auction, Kevin Borger & Lenny Mullin.

August 8 — Tractors, equipment, trucks, autos, vintage auto parts, trailers, 4x4s, scrap iron & much more at Osawatomie for Frank Austin Estate. Auctioneers: Eastern Kansas Auction Barn.

August 8 — Antique furniture, glassware, pottery, collectibles & primitives, tools & miscellaneous held at Junction City for George & Norma Mailen Estate. Auctioneers: Brown Real Estate & Auction Service, LLC.

August 8 — Tractors, tools & more tools, dump truck, trailers, anvil held southeast of Overbrook for Virgil & Sandy Deck. Auctioneers: Altic Auction Service.

August 8 — Jewelry, lamps, Indian items, toys, collectibles, showcases, 50 lamps, pottery & glassware & much more held at Salina for an Individual Collector. Auctioneers: Thummel Real Estate & Auction, LLC.

August 8 — Jeep, tractors, ATV, farm & shop equipment, blacksmithing tools, primitives held South of Fairbury, Nebraska for Mrs. Bruce A. Junker. Auctioneers: Bott Realty & Auction.

August 8 — Contents and beam house (to be taken down and removed

from property) held SW of Lindsborg for Hoffman Estate. Auctioneers: Wilson Realty & Auction Service.

August 8 & 15 — Household, antiques and miscellaneous at Herington for Irene Finley Estate. Auctioneers: Kretz Auction Service.

August 9 — Large auction with lots of collectibles & glassware including pottery (Shawnee, Dryden, Frankoma, Red Wing, VanBriggle, Roseville & more), Flow blue, salt & peppers, refrigerator glass, Sandzen student painting & other paintings & prints, political buttons, cast iron banks, small coin collection, furniture & much more held at Salina. Auctioneers: Thummel Real Estate & Auction, LLC.

August 10 — 2 Storage Units to be sold by entire units held at Manhattan for Maberry RFD Storage. Auctioneers: Gannon Real Estate & Auction.

August 12 — 5,422 acres m/l of cropland & grass land located in Trego & Graham counties offered in 21 individual tracts (no combinations of any tracts) held at WaKeeny (online bidding available) for The Bank. Auctioneers: Farm & Ranch Realty, Inc., Neal Mann, listing agent, Donald Hazlett, broker/auctioneer.

August 15 & 16 (2-day auction) — Selling Aug. 15: Approximately 650 pieces tractors, machinery & industrial toys, cast iron bank collection; selling Aug. 16: Collectibles, 7 bronze, pewter & Montana Silversmith statues/figurines, pottery & glassware & more both days held at Holton for Pat Erickson & the late Jerry Erickson. Auctioneers: Gannon Real Estate & Auctions.

August 15 — Shop tools, lawn & garden, antiques & collectibles, furniture & appliances, household, guns held near Scott City for Jim & Janelle Krehbiel. Auctioneers: Berning Auction, Inc.

August 15 — Antiques, primitives, collectibles including glassware, ammo boxes, brass items, cast iron items, duck decoys & more; tools, Hiawatha boys bicycle, Christmas decor & more miscellaneous held at Portis for Don Chegwidzen Estate. Auctioneers: Wolters Auction & Realty.

August 15 — Live & Online Auction selling

Tractors & accessories, trucks, ATV, trailers, hay equipment, machinery, livestock equipment, shop & miscellaneous held Live at Sabetha & Online at EquipmentFacts.com for Herman & Jean Renyer. Auctioneers: Harris Auction Service ([www.holton-livestock.com](http://www.holton-livestock.com)).

August 15 — Live & online auction. Livestock feeding & handling equipment including loader & grapple bucket unit, swather, Honda Foreman 500, feed wagon, bale processor, Bobcat, portable corral, baler, stock trailers, bale feeders, feed bunks, continuous fence panels, portable panels, mineral feeders & more held at Washington for Stewart Family Farms, LLC. Online at Equipment-facts.com.

August 15 — Tractors, combine, trucks, machinery, horse machinery, motorcycles, antiques, collectibles, tools & other held near Clay Center for Clarence & Marjorie Urban Estate. Auctioneers: Thummel Real Estate & Auction, LLC.

August 15 — Farm auction held at Baldwin City (Vinland Fairgrounds) for J.C. Brown Estate. Auctioneers: Elston Auction Company.

August 15 — New Strawn Consignment auction including tractors, trucks, vehicles, farm & ranch equipment, lawn & garden, trailers, tools, building materials, farm misc. & more held at New Strawn. Auctioneers: Darwin Kurtz, Lyle Williams, Laverne Yoder; Richard Newkirk, sales manager; Larry Hermon, asst. sales manager.

August 16 — Large assortment of vintage, collectibles, antiques, pottery, hundreds of smalls, travel trailer held at Osage City for Mrs. William "Pam" Lynn. Auctioneers: Wischropp Auctions.

August 20 — (Live & Online bidding) Farm machinery consignment auction selling tractors, hay & livestock equipment, grain handling, planting, cultivating & spraying, tillage, trucks, trailers, vehicles, harvest equipment, antique machinery, construction & miscellaneous held Live at Tekamah, Nebraska and online EquipmentFacts.com. Auctioneers: Lee Valley, Inc. ([www.leevalley.net](http://www.leevalley.net)).

August 22 — Coins & Guns held at Cottonwood Falls for property of Merle Ecklund. Auctioneers: Griffin Real Estate & Auction.

August 22 — Real Estate & personal property held at Lindsborg. Auctioneers: Wilson Realty & Auction Service.

August 22 — Farm retirement auction including Kawasaki 4x4 Mule, Lone Star flat bottom boat, Gehl 2500 skid steer/loader with bucket, 1972 C50 farm truck, car, mowers, loading chute, riding mower, pedal tractor, shop tools, collectibles & antiques held at Wamego for John L. & Juanita Habluetzel. Auctioneers: Crossroads Real Estate & Auction, LLC.

August 22 — Real Estate consisting of 3+ BR home with Morton Building & 2-car garage on 1 1/2 acres; plus dolls, collectibles, tools, mowers, vintage, furniture held at Burlingame for Patricia M. Dennison, Cindy S. Dennison, POA. Auctioneers: Miller & Midyett Real Estate & Wischropp Auctions.

August 22 — HD Lee collectibles, antique furniture, store tins & very large tin collection, advertising thermometers, glassware, art & pictures including Sandzen, Kreige, Fox & others; crocks, Singer toy sewing machine, electric train, dolls & more collectibles held at Salina for 2 local collectors. Auctioneers: Thummel Real Estate & Auction, LLC.

August 22 — 2008 PR Cruiser, Retro lighted juke box, furniture, large floor scale, household, holiday

decor, collectibles, large trampoline held just west of Junction City for Thomas & Mary Ballow Estate. Auctioneers: Gannon Real Estate & Auctions.

August 22 — (rescheduled from June 6) — Farm machinery, trailers, 1976 Lincoln, antiques, farm supplies, tools, iron & miscellaneous held at Talmage for Twila (Mrs. Rosie) Holt. Auctioneers: Kretz Auction Service.

August 25 — 440 acres m/l of Quality Farmland in Miami County sold as an entirety or split into 3 tracts held Live at Paola with internet bidding available for Thomas M. Mang property, Paul & Patricia Morano, administrators. Steve Cutshaw, listing agent; Paola Livestock Auction, auctioneer.

August 29 — Firearms auction including 125 rifles & shotguns held at Alma for a Private Collector. Auctioneers: Cline Realty & Auction, LLC.

August 30 — Approx. 130 High-End Guns, scopes plus ammo held at Salina. Auctioneers: Wilson Realty & Auction Service.

August 31 — Farm machinery, new skid steer, nice pickups & more at Clay Center for The Lorenz Karmann Estate. Auctioneers: Kretz Auction Service.

September 4 — 80 acres m/l acres Cottage Hill Cropland farm auction held at Waterville for Eugenie E. Long Trust. Auctioneers: Olmsteds Auction.

September 10 — 96 acres of farmland, mostly tillable which touches the city limits held at Waverly

for the Heck Family. Auctioneers: Darwin W. Kurtz, broker & auctioneer.

September 12 — Possible antiques & collectibles, guns, farm machinery, pickups, hay equipment, livestock feeding equipment & a number shop tools held at Bennington for Denny & Janice Graham. Auctioneers: Royce Bacon Auction Service.

September 12 — Real Estate & personal property auction at Salina. Auctioneers: Wilson Realty & Auction Service.

September 19 — Household goods & collectibles at Clay Center for Betty (Mrs. Grant) Sump. Auctioneers: Kretz Auction Service.

September 19 — 2 Day Sale ammo & reloading equipment held at Salina. Auctioneers: Wilson Realty & Auction Service.

September 20 — Day 2 Gun Auction held at Salina. Auctioneers: Wilson Realty & Auction Service.

September 21 — Farm machinery, iron, shop tools & miscellaneous held near Herington for Duane Stroda. Auctioneers: Kretz Auction Service.

October 10 — 1,400 acres m/l of Brown County land held at Hiawatha. Auctioneers: Midwest Land & Home.

October 28 — Fink Beef Genetics Production Sale held at Randolph. Contact Galen Fink at 785-532-9936.

December 5 — Consignment auction held at Wetmore for St. James Catholic Church. Early consignments contact Bill Burdick (785-547-5082) or Ron Burdick (785-207-0434).

## STEWART FAMILY FARMS, LLC LIVESTOCK FEEDING & HANDLING EQUIPMENT AUCTION

SATURDAY, AUGUST 15, 2020 - 10:00 AM  
Held at Washington Sales Pavilion, 711 D. Street - WASHINGTON, KS 66968

2012 Case IH Puma 130 CVT MFWD 2520 Hrs w/CIH L765 Loader and 8' Grapple Bucket-Nice Unit; Bale Spear For Front End Loader; 1999 Case IH 8870 Self-Propelled Swather w/18' Deluxe Header 1,750 Hrs Dual Sickle Drive; 2007 Honda Foreman 500 ES/PS 4x4 - New Tires; 1969 IH 656 5695 Hrs Rebuilt Gas Engine, Wide Front, 3 pt.; Kelly Ryan Feed Wagon 5x14 w/Scales-Only fed dry grain; HayBuster 2650 Bale Processor w/Scales; 2009 Bobcat S185 2487 Hrs w/68" LoPro Bucket; Bobcat 68" LoPro Bucket w/Bolt-on Teeth; Haugen Hydraulic 68" Grapple/Rock Bucket; Bobcat 74" Snow Bucket; Double D Tree Clipper for Skid Loader; 2015 Rawhide Super Large Portable Corral w/Hydraulic Alleyway and Walkthrough Headgate; New Holland Hayliner

Feeder w/Wheels; 750 lbs Poly Creep Feeder -New; (3) Stainless Steel Pig Creep Feeders; 4500 IH Vibra Shank 18.5' w/Levelers; KatoLight 25,000kw PTO Alternator w/Trailer; KatoLight 12,500kw PTO Alternator w/Trailer; (4) Flat Bed 4-wheel Trailers; (5) 4-wheeled Running Gears; (4) Viking Galvanized Grain Elevators 40'; (3) Elevator Feed Bunks; (10) 10' Concrete "J" Fence Line Bunks; (11) Rubbermaid Tanks 300, 100, 50 gal.; Cattle Head Gate w/2 Part Panels; (18) 16' Wire Cattle Panels; Assorted Metal Swinging Gates 4' - 16'; Approx. 400 Electric Fence Posts w/Insulators; 13 - Rolls of Electric Fence Wire 1/2 mile each; (2) Gallagher 12V Fencers; 110V Squirrel Cage Fan; Used Tin-Galvanized 10'-20'; Bundle of 2"x4" Lumber 12'-20'.



Rod Stewart 785-747-8216 Joel Marreel 402-936-3016 Ryan Stewart 785-406-0359

Online bidding available with Equipmentfacts!



Go to Washington Sales Pavilion FACEBOOK Page for MORE!!

Terms of Sale: Cash or Valid Check Accepted. Settlement must be made day of sale. All property bid in at bidder's risk and cannot be removed until settled for. Must have proper ID for Bidder's Number. Not responsible for accidents or loss. Due to the possibility of incorrect information and typographical errors, the auctioneer, owner, and printer will not be responsible for any errors that might appear in this advertisement. However, every effort has been made to describe the sale items accurately. The auctioneer's announcements on sale day will take precedence over printed material.

### STORAGE UNIT AUCTION

**MONDAY, AUGUST 10, 2020 \* 6:00 PM**  
10245 MILITARY TRAIL ROAD, MANHATTAN, KANSAS  
12 UNITS (Owner's may pay back rent and claim prior to Auction) to be sold by entire units. All items must be removed by August 13, 2020, 5 PM or forfeit \$75 deposit.

MABERRY RFD SELF STORAGE \* 785-539-0266  
GANNON REAL ESTATE & AUCTIONS  
VERN GANNON, AUCTIONEER  
785-770-0066 • MANHATTAN, KANSAS • 785-539-2316  
[www.gannonauctions.com](http://www.gannonauctions.com)

## 2-DAY AUCTION

9:30 AM SATURDAY, AUGUST 15, 2020  
11:00 AM SUNDAY, AUGUST 16, 2020  
NORTHEAST KANSAS HERITAGE COMPLEX, 12200 214th RD - HOLTON, KANSAS

APPROXIMATELY 650 PCS TRACTORS, MACHINERY & INDUSTRIAL TOYS

Precision Farm show - Toy Show - Special Edition - Anniversary - Farm Museum & Collector's Edition; 1/16, 1/32, 1/64 scale (Photos on website); Very nice Collection. John Deere; International; AC; Steiger; Versatile; White; Ford; Duetz Allis; Hesston; Oliver; Massey Ferguson; Case; Cockshutt; Coop; Black Hawk; McCormick Deering; Fordson; Waterloo Boy; Minneapolis Moline; Case IH; Caterpillar; Gleaner; New Holland; Claas Lexion; Twin City; Big Red; Big Bud; Nylint; Terex; Hubley; Tonka.

Tractors; combines; trucks; school bus; mailbox; U-Haul; gas engine; drills; plows; Airplane; manure spreader; loaders; Industrial; Cub Cadet; lawn mowers; Bobcat; side delivery rake; balers; disk; field choppers; swathers; feed trucks; elevator; drills; Phillips 66 gas pump; JI Case farm set with deluxe barn; tin barn; Coca-Cola truck.

Independence Hall (repo); Smiling Save, IXL safe, 2 bear with honey pot, parlor stove, Newfoundland dog. Eagle & eaglets mechanical bank; Mammy Bank; 6 still state banks-smaller to larger; Imswiler & Saylor 1 of 500-50th Anniversary of Hawaii penny Pineapple bank; **James Capon banks** Bad accident, Professor, Pug & Frog, 2 frogs, Magic bank, Horse race, Monkey bank, trick dog.  
2 cast iron fire pumps; Boston Bulldog doorstop; flower doorstop.

**BOOKS OF KNOWLEDGE BANKS**  
Trick Pony, William Tell, Leap Frog, Trapsey, 2 Always did spise a Mule, Batting Buffalo, Paddy & pig, organ grinder, Uncle Sam, Magician, Owl turning head, Columbus, Teddy & Bear, cat & mouse, cabin, 2 US Space. **JOHN WRIGHT BANKS** Model T, Arab oil bank, Milking cow, tennis bank.

Mason mechanical bank; Birdie Putt mechanical bank; **Taiwan Mechanical Banks:** Baseball player; 2-Dentist; 2 Uncle Sam, Artillery, Calamity, Bulldog, 2 Elephants, Clown on Globe, Humpty Dumpty, Bear on Stump, Indian & Bear, Jolly N, Stump Speaker, Jonah & Whale, Punching Judy, Organ Grinder, Paddy & Pig, Butting Buffalo; various other banks.

**SELLING SUNDAY BEGINNING AT 11:00 AM**  
Extra nice old 3x5' Southwest wool blanket/rug; 20 'donkey nodder' mule team & wagon;

Metz Beer clock/light; Budweiser neon; Budweiser mugs; newer Cast Iron 8-horse beer wagon; Rolltop desk & chair  
**7 Bronze, pewter & Montana Silversmith statues/figurines:** Maverick Calf, Surprise Encounter etc; egg scales; milk bottles; DeLaval collectibles; DeKalb sign; Redman advertising items; crocks; antique vacuum; lots of baseball cards & related items.  
**POTTERY**  
14 PCS Van Briggle including lamps with original shades, Garzio, Hull, & McCoy; Franciscan china; Steiff bear; Fenton lamp, bell, basket, clock, fairy lamp; small White Mountain ice cream freezer; perfume bottles; Swarovski; Opalescent; plates; bowls; crystal; cut glass; pie bird; lots of figurines; dresser set with perfumes; hair receiver; Nippon chocolate set; souvenir glass; cups & saucers; perfume bottles; pewter miniatures & figurines; cast iron flower; cast iron retriever & bulldog doorstops; glassware; vases; Halloween paper mache pumpkin; 4 donkey noddars; Fagan; Western stoneware; chicken waterer; egg case; Fontanini Nativity set; 2 smaller Pipka's; Pyrex; Hallmark Sports ornaments; 4 Lone Wolf pictures; Cupid Awake & Asleep pictures; Lone Elk & other prints; straight edge razors; knives; steels; approximately 175 pcs red glass including Fostoria; approximately 100pcs Cobalt Blue glass; Black Amethyst/clear pitcher & 6 tumblers; coin glass bowl; covered Turkey & ship candy dishes; lots more!

NOTE: Be jerry & Pat collected for years. Very nice Auction! Pictures on website.  
**COLLECTIBLES OF PAT ERICKSON & THE LATE JERRY ERICKSON**

GANNON REAL ESTATE & AUCTIONS  
VERN GANNON, AUCTIONEER  
785-770-0066 • MANHATTAN, KANSAS • 785-539-2316  
[www.gannonauctions.com](http://www.gannonauctions.com)

pt. 6' tandem disc; Oliver metal manure spreader; JD sickle mowers inc: 10-1659 mounted; 3 pt. 2 bottom JD plow; 3 pt. 6' blade; 3 pt. 4 row cultivator; swather 2 wheel trailer; wench on 2 wheel trailer; 3 pt. 2 row planter; JD loader; cement mixer w/electric engine; metal loading chute; rotary hoe; Arts Way grinder mixer been setting; 2 wheel metal trailer; JD 3 pt. cultivators; American Truck Equipment 3 pt. ladder; many lawn mowers inc: (Massey no 7 lawn tractor, Ford WT 12.5 & LT 114, walk behind sickle, many others); David Bradley walk behind w/equipment; John Deere stationary 4 cy. engine; mobilift; Holbart generator welder; **Horse machinery inc:** 2 row Hoosier corn planter; unusual road grader; dump rakes; dirt slips; cultivators; disc planters.

**MOTORCYCLES, ANTIQUES, COLLECTIBLES, TOOLS & OTHER**  
Cushman Vespa Piaggio scooter; Honda 70 motorcycle; Kawasaki KM 100 motorcycle; Horse power grinder; Morganville school gym scoreboards; Clay Co. High School Honor Roll large display; wood cabinet w/40 drawers; cast iron slide steps; pedal grinders; well pumps; oil cans; large amount of car parts some new

old stock; yard gates; yard fence; cast iron park bench; metal beds; iron wheels; horse harness, hames; threshing machine water pumps; buzz saw blades; Singer 229-4 leather sewing machine; yard gates; hay fork; cast iron pillar; forge; wire fence; metal beds; buggy parts; tin seats; 6' wood table; windmill tail; wood & metal corn sheller; walking plows; coaster wagons; bicycles; jacks; light reflectors; wooden wash tub holder; safety can; wood & metal barrels; boat motors; cattle panels; portable corral panels; cattle gates; bricks; drive belts; many radiators; hyd cylinders; gas engines; 20' 1" pipe; front weights for 40 series JD tractors; IH weights; JD implement pieces; 1970's gas generator; upright twin cy. air compressor; band saw; Souix value grinder; Forney welder; table saw; drill press; antique power hack saw; top links; many pumps; chicken equipment; ornamental windmills; assortment of iron.  
**Buildings to be moved within 30 days:** 5 metal grain bins 500 bu to 1000 bu; 8'x12' building; out house; Hundreds of other items. This is a very unique auction, probably one of the last old time farm auctions.

**CLARENCE & MARJORIE URBAN ESTATE**  
Auction Conducted By: THUMMEL REAL ESTATE & AUCTION LLC  
785-738-0067

## AUCTION

**SATURDAY, AUGUST 15, 2020 — 9:00 AM**  
Auction will be held at the farm 2224 Hackberry Road (West of Clay Center, Ks on Hwy. 24 to Hackberry go North 5 miles, or from Morganville 3 miles West on 23 Road then 1 mile South on Hackberry)

**TRACTORS, COMBINE, TRUCKS & MACHINERY**  
1971 John Deere 4400 gas combine 2200 hours cab in the shed; 1961 John Deere 3010 diesel tractor w/GB 800 loader, needs some work; Oliver Super 55 gas utility tractor runs; JD 170 skid loader good; Massey 65 propane tractor, 3 pt. 13.6-38 tires runs; Ford 9N tractor; Allis WC unstyled tractor on rear steel; Moline 5 Star tractor; Moline Z tractor; 1940s Cat D4 tractor; C40-322 LaPlant Choate pull scraper; Cletrac E-76 wide track tractor Hercules engine stuck; 2-F20 tractors; IHC F12 tractor; 1929 Ford Model A flatbed truck; Model A & T parts; 1969 Chevrolet C50 truck 13 1/2 cy, 4 sp. 2 sp.; 1964 Chevrolet 1 1/2 truck, 14' bed needs work; 1975 Chevrolet 3/4 4 wheel drive pickup auto, 350 engine; 1992 Chevrolet 1/2 4 wheel drive pickup auto, don't run; 2 wheel pickup box trailer; tandem axle trailer; Payloader w/3' bucket; John Deere 2270 diesel swather 14' head-er runs; 400 bu. 2 wheel grain cart; tandem axle 4'x10' flat bed trailer; John Deere L & M wood box manure spreader, hardly used; John Deere 3 bottom roll over plow; John Deere 214T & 24T balers; 3 pt. Dempster 2 row 50 planter; 3

NOTE: Clarence went to sales for over 60 years. He always brought something home. There are many unusual pieces. The tractors have been in the shed, most ran when put in shed. Come spend the day, you will find things you haven't seen in years. There are many items that have not been uncovered yet. We will sell tractors & machinery at 1:00 p.m. Check our web site for pictures at [www.thummelauction.com](http://www.thummelauction.com). Please wear your mask, if you are not feeling well please stay home and call in your bids to 785-738-0067. Be sure to check to make sure everything is still OK for the auction. THANKS





# BAXTER BLACK

ON THE EDGE OF COMMON SENSE

## David and Goliath of Television

"The farmer has always been a peasant." - Richard Blinco, Idaho

When the market crashed in 1975, Richard had a ranch, feedlot, dairy, potatoes, alfalfa and a packing house.

Here we sit 45 years later and not much has

changed. Today less than 1.3% of the American population, (and 7% in Canada), is involved in production agriculture. We who are left have the responsibility of feeding the ever-growing population that now stands at 331 million people. We do it. It is lots of work. We have an enormous amount of scientific, technical, medical, and mechanical research and dedication looking over our shoulder as we break the ground, plant the wheat, brand the calf or drive the truck.

Imagine a 'Nóngmín' bent over in a rice field a thousand years before Christ came, not much different than a farmer bent over a furrow, feeling the

soil today. What is our motive... inspiration? Do we say, "We're feeding the world?" "I'll get famous!" "The big money?"

No. It is as simple as "It's what I do."

There are people who have a deep heart, have a conscience, are dedicated to those we work for, are close to God, maybe have guilt, or just kindness and care. They don't think 'money first.' Occasionally, the consumer has a chance to make farmers' lives easier, nicer, more satisfying.

Let me suggest... their own television channels. Television waves are controlled by a handful of global companies. They have brought wonderful communication worldwide

with hundreds of channels. 99.9% are dedicated to the majority polled, which are suburban folks.

The ag rural television, which is not 'about us' but 'for us', are limited to pillars like and Orion Samuelson and some local weeklies that are an hour long.

RFD-TV Channel is the only exception; RFD-TV content is exclusively rural and agriculture, 24 hours a day. They are leading the effort to have Congress vote on HR 2682 that would ensure at least one percent, 0.01... 1%, is devoted exclusively to the ag rural market.

Like ag publications and ag radio, ag television

is part of what holds all of our ag community together. To those of us in ag media, it's not just a job. I think it has something to do with our souls.

If you want to help, contact your Representative or Senator about passing HR 2682.

HR 2682: Agricultural News and Rural Content Act of 2020

This bill requires certain video programming distributors, such as cable providers, to use at least 1% of their channel capacity to transmit channels of programming that serve the needs and interests of rural areas.

www.baxterblack.com

## 10, 12 & 14 Bale Hay Trailers



- Cradles can be lifted w/one hand • Cradles are removable
- Safety locks for cradles in both the up & down positions, located at the front of trailer
- 1-Year Mfg. Warranty on axles & tires • 2-Year Warranty on trailer
- Heavy duty tubular construction
- 10-bale trailer has 7,000 lb. tandem axle with brakes & 10 ply tires
- 12-bale trailer has 10,000 lb. tandem dual axle w/brake & 10 ply tires
- 14-bale trailer has 12,000 lb. tandem dual axle w/brake & 14 ply tires
- Comes with a spare tire
- Now have options of hydraulic dump & 14 ply tires

# DENNING

## MACHINE SHOP, INC.

Toll-Free: 866-293-5450

THE WORKHORSE OF WESTERN KANSAS

Lafins Power Bull 9748 won reserve grand champion bred-and-owned bull at 2020 Kansas Junior Angus Preview Show, June 6-7 in Hutchinson. Tate Lafin, Olsburg, owns the September 2019 son of S Powerpoint WS 5503. Ryan Sweeney, Stillwater, Okla., evaluated the 96 entries.



Photo by Jeff Mafi, American Angus Association



Photo by Jeff Mafi, American Angus Association

# Farmers & Ranchers AUCTIONS EVERY MONDAY & THURSDAY

**Selling Cattle every Monday**  
**Hog Sales on 2nd & 4th Monday of the month only!**

RECEIPTS FOR THE WEEK: 3,608 CATTLE & 112 HOGS.

STEERS		HEIFERS	
300-400	\$199.00 - \$208.00	16 blk	Assaria 873@139.25
400-500	\$177.00 - \$184.50	122 blk	Bison 889@137.00
500-600	\$168.00 - \$176.00	114 blk	Herington 967@131.75
600-700	\$152.00 - \$167.00	<b>HEIFERS</b>	
700-800	\$143.00 - \$149.50	5 mix	Belvue 245@197.00
800-900	\$137.00 - \$144.25	2 mix	Sylvan Grove 463@160.00
900-1,000	\$125.00 - \$131.75	3 red	Marquette 468@159.00
		3 blk	Marion 477@158.00
		3 blk	Inman 485@156.00
		18 mix	Barnard 519@155.00
		5 blk	Salina 509@152.50
		4 mix	Lindsborg 318@152.00
		3 mix	Newton 580@149.00
		30 blk	Geneseo 571@149.00
		21 mix	Lehigh 631@148.00
		9 blk	Gypsum 601@148.00
		9 blk	Inman 551@148.00
		10 blk	Marion 563@147.00
		11 blk	Alma 541@145.00
		8 mix	Marquette 650@144.50
		2 blk	Durham 660@143.50
		5 mix	Bushton 681@142.50
		9 mix	Assaria 629@140.00
		5 blk	Assaria 685@140.00
		2 blk	Ada 738@139.50
		10 mix	Gypsum 669@137.50
		14 mix	Gypsum 586@136.50
		5 blk	Brookville 752@135.00
		3 mix	Durham 763@135.00
		23 mix	Galva 749@135.00
		4 blk	Buhler 759@134.50
		7 blk	Lost Springs 763@134.50
		46 mix	Inman 694@134.25
		13 blk	Brookville 797@132.50
		6 blk	Durham 810@132.00
		5 mix	Ada 807@130.00
		5 blk	Alma 882@128.00
		60 mix	Wilsey 849@128.00
		64 mix	Wilsey 914@127.00
		17 mix	Wilsey 877@126.50

### THURSDAY, JULY 30, 2020:

STEERS		HOGS	
3 blk	Lindsborg 358@208.00	4 fats	Esbon 278@32.00
2 mix	Ellsworth 375@206.00	4 sows	Hill City 670@1.50
3 blk	Whitewater 382@201.00	6 sows	Moundridge 456@31.00
1 char	Beloit 380@199.00	5 sows	Abilene 574@30.00
8 mix	Alma 471@184.50	4 sows	Hill City 566@30.00
4 blk	Ellsworth 463@180.00	5 sows	Abilene 587@30.00
2 mix	Marquette 465@177.00	10 sows	Abilene 533@30.00
7 blk	Geneseo 534@176.00	8 fats	Moundridge 299@28.00
3 mix	Sylvan Grove 518@176.00	20 fats	Galva 282@26.50
6 mix	Lehigh 558@175.00	6 sows	Abilene 413@25.00
5 blk	Abilene 530@175.00	9 sows	Abilene 413@25.00
3 blk	Salina 503@174.00	7 pigs	Herington @30.00 per head
8 blk	Marion 538@174.00	<b>CALVES</b>	
4 blk	Barnard 520@174.00	2 blk	Lindsborg 183@510.00
6 mix	Hillsboro 506@171.00	3 mix	Lindsborg 277@475.00
16 mix	Barnard 585@169.50	1 blk	Cawker City 180@475.00
13 blk	Geneseo 594@169.00	1 blk	Marquette 125@400.00
2 blk	Lost Springs 518@168.00	1 blk	Ellsworth 115@400.00
5 blk	Alma 602@167.00	1 blk	Assaria 85@150.00
12 mix	Ellsworth 585@165.50	1 blk	Ellsworth 60@135.00
4 mix	Galva 611@165.00		
14 blk	Marion 623@164.25		
27 mix	Barnard 654@164.25		
7 mix	Bushton 634@160.75		
7 blk	Gypsum 665@159.50		
38 blk	Bison 605@155.25		
5 blk	Marion 694@154.50		
7 mix	Marquette 671@152.50		
4 mix	Ada 701@149.50		
77 blk	Bison 682@149.00		
27 blk	Herkimer 790@148.00		
69 blk	Salina 768@147.75		
58 blk	Herkimer 859@144.25		
63 blk	Salina 840@144.10		
192 blk	Salina 838@143.85		
287 blk	Bison 766@143.75		
20 mix	Assaria 825@142.50		
19 mix	Salina 822@142.25		
25 mix	Galva 831@141.00		
61 blk	Salina 893@140.50		
122 blk	Salina 899@140.35		
56 mix	Chapman 883@140.25		

### MONDAY, JULY 27, 2020:

HOGS		CALVES	
4 fats	Esbon 278@32.00	2 blk	Lindsborg 183@510.00
4 sows	Hill City 670@1.50	3 mix	Lindsborg 277@475.00
6 sows	Moundridge 456@31.00	1 blk	Cawker City 180@475.00
5 sows	Abilene 574@30.00	1 blk	Marquette 125@400.00
4 sows	Hill City 566@30.00	1 blk	Ellsworth 115@400.00
5 sows	Abilene 587@30.00	1 blk	Assaria 85@150.00
10 sows	Abilene 533@30.00	1 blk	Ellsworth 60@135.00
8 fats	Moundridge 299@28.00		
20 fats	Galva 282@26.50		
6 sows	Abilene 413@25.00		
9 sows	Abilene 413@25.00		
7 pigs	Herington @30.00 per head		

**IN STOCK TODAY:**

- Heavy Duty Round Bale Feeders
- 42' ROUND BALE DUMP TRAILERS
- HEAVY DUTY FEED BUNKS (Silage & Grain)
- HEAVY DUTY 5000# GRAIN TOTE

# Livestock Commission Co., Inc. Salina, KANSAS

SALE BARN PHONE: 785-825-0211  
 MONDAY — CATTLE • HOG SALE 2nd & 4th MONDAY  
 Hogs sell at 10:30 a.m. on the 2nd & 4th Monday of the month.  
 Cattle at 12:00 Noon. Selling calves and yearlings first, followed by Packer cows and bulls.

THURSDAY — CATTLE ONLY  
 Selling starts at 10:00 a.m. Consign your cattle as early as possible so we can get them highly advertised.

AUCTIONEERS: KYLE ELWOOD, BRANDON HAMEL & GARREN WALROD

For a complete list of cattle for all sales check out our website [www.fandrive.com](http://www.fandrive.com)

**CATTLE USA.com LIVE CATTLE AUCTIONS**  
**FARMERS & RANCHERS HAS SWITCHED BACK to Cattle USA.com for our online auctions.**

BULLS		COWS	
1 blk	Hutchinson 1835@106.50	2 red	Halstead 1578@76.50
1 rwf	Randolph 2020@104.00	1 brown	Lindsborg 1325@76.50
1 blk	Marquette 2315@100.00	1 blk	Lyons 1295@76.00
1 blk	Salina 1870@99.00	1 blk	Durham 1445@75.50
1 blk	Gypsum 1430@98.50	1 blk	Durham 1600@75.00
1 rwf	Randolph 1685@98.00	1 red	Abilene 1210@75.00
1 wf	Abilene 2140@95.00	1 red	Clay Center 1390@75.00
1 red	Ellsworth 1900@94.50	1 blk	Buhler 1410@74.50
		1 blk	Lyons 1295@74.50
		1 blk	Wilsey 1360@74.00
		1 red	Clay Center 1115@72.50

**Time Is Running Out to get your horses consigned to the FALL CLASSIC HORSE SALE or Annual Weanling & Yearling Sale ON OCTOBER 10-11, 2020.**  
 Deadline to consign is August 1st.

## EARLY CONSIGNMENTS FOR THURSDAY, AUGUST 6, 2020

- 250 Black Steers, grass, South Dakota origin 850-900
  - 55 Black S&H home raised, 2 round vacc 600-700
  - 650 Black Steers native grass 800-875
  - 60 S&H home raised, long time weaned, grass 700-750
  - 300 Mostly Black Steers Native grass 775-825
  - 210 Steers Natives grass 750-850
  - 155 Steers long time weaned, vaccs, grass 700-750
  - 30 S&H home raised, vacc 500-600
  - 62 Black Steers home raised, grass 750-900
  - 60 Steers long time weaned, home raised, grass 500-800
  - 20 S&H home raised, off grass 750-850
  - 60 Black Steers no sort, Native, grass 900-925
  - 130 Black Steers 1 Iron, Wyoming origin 825-875
  - 13 CharX long time weaned, off Brome, Fink Genetics 700
  - 20 Black Steers home raised, grass 750-900
- PLUS MORE BY SALE TIME

## NEXT COW SALE IS TUESDAY, AUGUST 11, 2020

- BULLS**
- 3 yearling bulls-Black Angus semen check, virgin
  - 2 yr old Angus semen & Trich tested
- COWS**
- 350 Black, BWF & Char X cows 3-5 yrs, bred Char 50-60 calves on ground, start calving September 5th
  - 20 Red cows 3-6 yrs, bred Red Angus
  - 68 Red Angus cows 3-6 yrs, Janssen Red Angus genetics, bred Red Angus, calve September 12
  - 30 Black cows 3-4 yrs, bred Angus
  - 175 Angus cows, Reg & PB cows 3-7 yrs, bred Lucky 7 Angus bulls September 1
  - 43 Black & BWF 4-8 yrs bred Gardiner Angus, few bred Hereford, September 10 (November 15) vacc, all raised calf last year

For Information or estimates, contact:

Mike Samples, Sale Mgr., Cell Phone 785-826-7884  
 Kyle Elwood, Asst. Sale Mgr., Cell Phone 785-493-2901

Check our listings each week on our website at [www.fandrive.com](http://www.fandrive.com)

Jim Crowther 785-254-7385 Roxbury, KS  
 Lisa Long 620-553-2351 Ellsworth, KS  
 Cody Schafer 620-381-1050 Durham, KS  
 Kenny Briscoe 785-658-7386 Lincoln, KS  
 Kevin Henke H: 785-729-3473, C: 785-565-3525 Agenda, KS  
 Austin Rathbun 785-531-0042 Ellsworth, KS

