



# Schwieterman Market Outlook

*A marketing commentary by Bret Crotts*

We finished the last full week of October on a soft note, but it looks like the corn, wheat, and soybeans will all finish the month of October higher than where they started. The harvest lows came early for the corn and the soybeans and the strength has continued through the first third of the fall. We have plenty of grain on hand, so supplies are not the least bit of a concern, but we are also contending

with very good demand, which is one of the key elements keeping the markets supported. The other key is that there seems to be money flowing into some commodity markets because they got too cheap. Money flow can only support the market for so long, but for the time being the trends are generally up for the grains.

On the charts, I am still looking for a move up to

\$3.67 in the December corn. For the soybeans there are a lot of folks talking about a move up to the \$10.60-\$10.80 in the January contract, since we cleared the \$10.20 resistance for a little bit. As for the wheat, I still don't have much positive to say about the wheat and if we do get some more strength in the corn and beans, I hope the wheat will at least be able to follow along.

Hedgers have to keep in

mind that with such large supplies on hand, if the speculative buying/short covering dries up, there won't be anyone to fill the void. As the December of 2017 corn nears the \$4.00 level, selling interest will grow and that market will probably have a very hard time clearing that resistance. The same thing applies to the \$10.00 level in the November 2017 soybeans and the closer the July 2017 KW gets to \$5.00 the more difficult it will be to pass up pricing some wheat.

The cattle market had a decent week. The December live cattle contract closed above the 50-day moving average for the first time since mid-August, which has the chart looking a little better. We still have to see the cash cattle market moving higher every week to

Grass & Grain, November 1, 2016

Page 17

keep the futures moving higher and it remains to be seen if that can happen. The increased volume on the Fed Cattle Exchange is encouraging. The cattle need less captive supplies and more free markets.

The feeder cattle did not look nearly as good as the live cattle this week and Friday's close was pretty poor. Traders keep looking at the live cattle futures and they aren't seeing much hope, especially when you get past the April contract. Next week will be an important test from a technical standpoint. The November feeders need to be able to hold above \$120 for the week and a positive close for the week would be very encouraging.

*Schwieterman Marketing, L.L.C. specializes in risk management and cash grain and livestock marketing plans.*

For information on the markets or our marketing service you can contact Bret Crotts at 888-437-9131 or [bret@swbell.net](mailto:bret@swbell.net).

The information contained herein is based on data obtained from recognized statistical services and other sources believed to be reliable. However, we have not verified such information and we do not make any representations as to the accuracy or completeness. Past results are not necessarily indicative of future results. All statements contained herein are current opinions, which are subject to change. The risk of loss in trading commodity future contracts is substantial. You should therefore carefully consider whether such trading is suitable for you in light of your financial condition. Neither the information, nor any opinion expressed shall be construed as an offer to buy or sell any futures or options on futures contracts.

# MANHATTAN



1-800-834-1029

Toll-Free

STARTING 10:00 A.M. ON WEIGH COWS  
FOLLOWED BY STOCKER FEEDERS — 11:00 A.M.

OFFICE PHONE 785-776-4815 • OWNERS MERVIN SEXTON & JOHN CLINE

## COMM. CO. INC. CATTLE AUCTION EVERY FRIDAY



Our CONSIGNMENTS can now be viewed after 12 Noon on Mondays by going to [www.grassandgrain.com](http://www.grassandgrain.com) & logging onto the online subscription

**For our sale Friday, Oct. 28th steer and heifer calves were selling \$2-\$4 higher with the most advancement on the steers. Stocker feeder cattle were selling \$4-\$6 higher, especially on the steers. Cull cows and bulls sold on a lower trend with many low dressing cows offered.**

### STEER CALVES— 425-550 LBS.

Tonganoxie	7 blk	437@152.00
Oskaloosa	6 blk	465@144.00
Alma	3 blk	458@144.00
St. George	5 blk	472@142.50
Wakarusa	8 blk	494@141.50
Havensville	13 blk	502@140.00
Dwight	6 blk	510@138.00
Bonner Springs	5 blk	496@137.50
Manhattan	4 blk	518@136.00
Ottawa	5 blk	482@134.50
Blaine	3 Cross	480@134.00
St. George	3 Cross	430@133.00
Bonner Springs	19 blk	546@132.75
St. George	3 blk	540@130.50
Easton	3 Cross	546@120.00

### STEERS — 550-1,025 LBS.

Burns	10 blk	824@132.75
Hoyt	4 blk	561@132.50
Onaga	62 Cross	859@132.00
Burns	8 blk	825@131.50
Onaga	24 Cross	779@131.00
Wakarusa	6 blk	575@131.00
Lawrence	5 blk	634@130.50
Manhattan	7 blk	622@130.50
Manhattan	9 blk	780@130.25
Auburn	18 Cross	827@130.00
Lawrence	9 blk	717@130.00
Manhattan	4 blk	731@130.00
St. George	14 blk	575@130.00
Alma	9 blk	583@127.50
Dwight	8 blk	596@127.50
Oskaloosa	6 Cross	769@127.00
Havensville	24 blk	585@126.00
Oskaloosa	5 blk	571@125.50
Manhattan	11 blk	585@125.00
Blaine	6 bwf	570@125.00
Holton	10 blk	612@124.50
St. George	4 Cross	648@124.50
Manhattan	7 blk	633@123.50
Wamego	8 blk	638@122.50
Wheaton	5 Hereford	756@122.50
Alma	4 blk	718@121.50
Onaga	18 Cross	1023@121.00
Bonner Springs	15 blk	629@121.00
Easton	4 Cross	662@121.00
Onaga	6 Cross	605@120.50
Holton	6 blk	726@120.00
St. George	3 blk	616@117.50
Manhattan	3 mix	558@115.00
Manhattan	4	903@115.00
Onaga	7 Cross	795@114.50
Manhattan	3 blk	643@112.00
Manhattan	3 Cross	673@111.50
St. George	4 mix	878@106.50
Manhattan	3 blk	750@104.50

### HEIFERS — 325-550 LBS.

Tonganoxie	7 blk	435@140.00
Manhattan	4 blk	475@129.00
Manhattan	5 blk	456@127.50
Bonner Springs	3 blk	433@124.00

Bonner Springs	29 blk	518@121.00
St. George	8 blk	465@121.00
St. George	3 blk	426@120.00
Havensville	11 blk	525@118.50
Alma	4 blk	505@117.50
Wakarusa	6 blk	507@117.00
Alma	4 blk	546@116.00
Blaine	6 blk	540@116.00
Holton	5 blk	530@115.50
Oskaloosa	4 blk	482@112.50
Blaine	3 blk	445@110.00
Leavenworth	3 Cross	538@102.00

### HEIFERS — 550-925 LBS.

Burns	14 blk	797@125.25
Manhattan	16 blk	726@125.00
Onaga	7 blk	732@120.00
Baldwin City	9 blk	847@118.25
Manhattan	8 blk	550@117.50
Alma	16 blk	638@114.75
Manhattan	6 blk	594@114.75
Hoyt	4 blk	603@114.50
Bonner Springs	16 blk	595@114.00
Manhattan	6 blk	571@114.00
Manhattan	7 blk	669@114.00
Leavenworth	4 blk	727@114.00
Burns	6 blk	893@113.75
Holton	14 blk	634@113.50
Manhattan	3 bwf	613@113.50
St. George	6 blk	556@112.00
St. George	17 Cross	555@111.75
Manhattan	4 blk	793@109.00
Wakarusa	4 blk	646@108.50
	3 Cross	710@107.50
Mayetta	4 blk	697@107.00
Onaga	7 Cross	645@106.50
Holton	3 Cross	696@106.00
Wheaton	4 Hereford	695@104.00
Manhattan	4 blk	627@100.00

### COWS & HEIFERETTES — 675-1,750 LBS.

Bonner Springs	1 blk	995@106.00
Burlingame	1 blk	1015@105.00
Westmoreland	1 bwf	985@105.00
Frankfort	1 Hereford	1030@104.00
Oskaloosa	1 blk	770@101.50
Burlingame	1 bwf	945@101.00
Manhattan	3 blk	1016@101.00
Oskaloosa	1 blk	685@101.00
Westmoreland	1 blk	1035@100.00
Westmoreland	1 bwf	1070@100.00
Cedar Point	1 Char	1155@97.00
Alta Vista	1 blk	10000@96.00
Wamego	1 blk	700@94.00
Cedar Point	1 blk	1100@85.50
Salina	3 blk	1118@80.00
Westmoreland	1 blk	1075@79.00
Wamego	1 Cross	1070@79.00
	1 Char	1285@75.00
Wamego	1 blk	1180@69.00
Soldier	2 blk	1707@65.50
Basehor	1 blk	1505@65.00
Randolph	1 blk	1695@65.00
Burlingame	1 blk	1130@64.50
Easton	1 blk	1355@63.50
Maple Hill	Hereford	1420@62.50
Olsburg	1 blk	1750@61.00
Wamego	1 blk	1250@61.00
Wheaton	1 blk	1605@60.50
Mayetta	1 blk	1240@60.00

Easton	1 Cross	1485@60.00
Olsburg	1 blk	1470@59.00
Manhattan	1 Char	1390@59.00
Manhattan	1 blk	1405@58.00
Wheaton	1 blk	1435@57.50
Wamego	1 blk	1505@56.75
Meriden	1 blk	1245@56.00
Wamego	1 blk	1260@56.00
Manhattan	1 Hereford	1235@56.00
Meriden	1 blk	1325@55.50
Westmoreland	1 blk	1185@55.50
Holton	1 blk	1380@55.50
Frankfort	1 Hereford	1115@55.50
Wamego	1 blk	1395@55.00
Oskaloosa	1 blk	960@54.00
Oskaloosa	1 blk	1100@52.00
Onaga	1 blk	1470@52.00

### BULLS — 1,200-2,175

## SPECIAL SIMMENTAL INFLUENCE SALE, FRIDAY NOV. 4TH IN CONJUNCTION WITH OUR REGULAR SALE

155 choice reputation Sim-Angus str & replacement quality hfrs, 550-700 lbs

100 blk Sim & SimAngus str & hfrs, 550-750 lbs

65 Sim x str & hfrs, 1 rd shots, 550-675 lbs

35 choice Sim-Angus str & replacement quality hfrs, 550-700 lbs

30 reputation Sim/Angus str, 2 complete rds shots, weaned 40 days, 550-700 lbs

85 blk str & hfrs, weaned 40 days, 2 complete rds shots, 550-700 lbs

40 Angus str & hfrs, 1 rd shots, 500-550 lbs

39 blk str & hfrs, 2 complete rd shots, weaned 3 weeks, 600-700 lbs

25 blk & bwf str & hfrs, Spring shots, 600-700 lbs

20 Fancy blk & bwf str, longtime weaned, 650-750 lbs

7 blk & Char str, long time weaned, 400-500 lbs

1 5 yr old Hols. nurse cow. Fresh 90 days, very gentle

### EARLY CONSIGNMENTS FOR NOV. 11:

100 choice reputation Angus str & hfrs, all pre-weaning shots, 550-750 lbs

10 blk str & hfrs, weaned 3 weeks, 625-700 lbs



## SPECIAL STOCK COW & BRED HEIFER SALE, NOV. 16TH STARTING AT 11:00 AM - Bulls Selling First

70 big choice reputation OCV blk 1st calf hfrs bred to low birth weight Hereford bulls to start calving Feb. 15th

20 choice Angus OCV 1st calf hfrs w/ early Oct. Angus calves by side. Hfrs & calves all sired by Nelson Angus bulls.

8 blk & bwf cows, 8 yrs old w/ Sept. Cow Camp Sim Angus sired calves by side.

4 red Angus Herf. x cows, 4 yrs old w/ Sept. Cow Camp SimAngus sired calves by side

3 blk cows, short & solid with calves by side

2 registered Angus bulls, 17 mo. & 2 yrs old. 1 for hfrs, 1 for cows. Semen & Trich tested.

1 polled Herf. bull, 3 1/2 yrs old

### COMPLETE HERD DISPERSAL

1 Angus bull 3 yrs old

11 Angus cows coming with 3rd calf, bred Angus for Spring calving

12 Angus cows, 5 yrs and older, bred Angus for Spring Calving

3 older Angus cows w/ big calves by side

**IF YOU HAVE ANY CONSIGNMENTS FOR THIS SPECIAL BULL & COW SALE, PLEASE GIVE US A CALL SO WE MAY ADVERTISE THEM FOR YOU!**

## CLINE CATTLE COMPANY FALL EDITION BULL SALE SUNDAY, NOV. 6TH @ 1:30 PM

**SPECIAL STOCK COW & BRED HEIFER SALE DATES: WEDNESDAYS STARTING AT 11:00 AM – OCT. 19TH, NOV. 16TH, DEC. 14TH**

**VISIT US ON THE WEB FOR DAILY CONSIGNMENT UPDATES AT [WWW.MCCLIVESTOCK.COM](http://WWW.MCCLIVESTOCK.COM)**

### FIELD REPRESENTATIVES

JOHN CLINE  
ONAGA  
785-889-4775  
Cell: 785-532-8381

SAM GRIFFIN  
BURNS  
620-726-5877  
Cell: 620-382-7502

BRENT MILLER  
ALMA  
785-765-3467  
Cell: 785-587-7824

ALAN HUBBARD  
OLSBURG  
785-468-3552  
Cell: 785-410-5011

MERVIN SEXTON  
MANHATTAN  
Cell: 785-770-2622  
Home: 785-770-2622

BILL RAINE  
MAPLE HILL  
785-256-4439  
Cell: 785-633-4610

TOM TAUL  
MANHATTAN  
785-537-0036  
Cell: 785-556-1422

JEFF BROOKS  
BEATTIE  
785-353-2263  
Cell: 785-562-6807

BRYCE HECK  
LINN  
785-348-5448  
Cell: 785-447-0456

DAN COATES  
BALDWIN  
785-418-4524



# Cover Crop Road Show planned November 17 in southwest Kansas

Agricultural producers can get an up-close look and discussion about cover crops in several southwest Kansas settings at K-State



Research and Extension's Cover Crop Road Show, Nov. 17. The U.S. Department of Agriculture-Natural Resource Conservation Service is the tour's co-sponsor.

The tour starts near Jetmore at the Brit Hayes Farm and ends with lunch and discussion in Ford.

The goal of the program is to foster dialogue between producers, university researchers and specialists, government officials, and industry, said A.J. Foster, K-State Research and Extension southwest area agronomist.

The schedule includes:

8:30-9 a.m. - Registration - Brit Hayes Farm, 22918 N. Hwy 156, Jetmore.

9-10 a.m. - Cover Crop in a Cow-Calf System, including Q&A and presentation on cover crop choices - Brit Hayes Farm.

10:30-11:30 a.m. - Cover Crop in a Stocker System,

including Q&A and presentation on maximizing the benefit of cover crops - Dennis Bradford Farm, 28326 S.E. D. Rd., Jetmore.

Noon-1 p.m. - Grazing Cover Crop, including Q&A and presentation on the multiple reasons for using cover crops - 128 Rd. & War-

rior Rd., Bucklin.

1-2 p.m. - Lunch and discussion - The Blue Hereford, 807 Main, Ford.

Participants are asked to register by Nov. 11 at [www.southwest.k-state.edu](http://www.southwest.k-state.edu) or contact Norma Cantu at [cantu@ksu.edu](mailto:cantu@ksu.edu) or 620-275-9164.

**New, Remanufactured and Recycled Ag Replacement Parts**

**AbileneMachine**  
Ag Replacement Parts

**Affordable & Reliable Harvest Parts**

**Abilene Machine Prices Blow Away the Competition**

**Draper Center Feeder Belts**  
#AXE12533 for John Deere®  
625D, 630D, 635D, 640D

- 25', 30', 35' or 40'
- 55.30" x 58.01"

**QPOWER Belts**

**Cutting Parts**

**THEIR Price \$538 ... OUR PRICE \$310**

**Toll Free: 800-255-0337 • [www.AbileneMachine.com](http://www.AbileneMachine.com) • See Us on Facebook**

**Land Auction**  
**Tuesday November 15, 2016**  
**7:00 P.M., Courtyard by Marriott, 3020 Riffel Drive, Salina**  
**140 acres +/- Native grass pasture**

Part of the NW/4 26-13-4, Saline County, Kansas. The property includes 140 acres +/- native grass pasture with a pond and Saline County Rural Water District #4 hookup.

Sellers: Gregory Roberts

For More Information:

information available on the auction page at [ksallink.com](http://ksallink.com)

**COLDWELL BANKER**

ANTRIM-PIPER  
WENGER, REALTORS  
631 E CRAWFORD SALINA KS  
785-821-3641 ORI-800-276-3641

Chris Rost: 785-493-2476 seller's agent  
Mark Baxa: 785-826-3437 auctioneer/seller's agent

**CLINE CATTLE CO.**  
**Fall Edition Bull Sale**  
**Sunday, November 6 ~ 1:30 p.m.**

Manhattan  
Commission Co.  
Manhattan, KS

**Join us for Lunch  
before the sale!**

**SELLING ATHLETIC FALL YEARLING  
& 18 MONTH OLD BULLS.**

- **Angus • Red Angus • SimAngus • Horned Hereford**
- First Breeding Season Guarantee
- Free Local Delivery
- Winter Care Available

*"Where Success is built on Solid, Proven Foundations"*

For further info, to view the offering, or to receive a catalog please call:

**Austin, Shenan & Dorothy Cline:**  
**785-565-3246**

**Lance, Lynette & Lex Cline:**  
**785-564-1744**

UNAGA, KS • FRANKFORT, KS

Check us out on the web at [www.clinecattlecompany.com](http://www.clinecattlecompany.com)

**We specialize  
in Trucks and  
Sport U's!**

**MILLER**  
**785-584-5850**  
**MOTORS**

**OPEN**  
Monday thru  
Saturday:  
9 AM-6 PM

**"NOW AVAILABLE!" New Flatbeds & Trailers**  
**Visit our website: [www.millermotors.biz](http://www.millermotors.biz)**

<p><b>DODGE RAM 2500 4DR, 4X4</b></p> <p><b>\$16,988</b></p> <p>5.9 Cummins Turbo Diesel</p>	<p><b>CHEVY SILVERADO 1500 4X4</b></p> <p><b>\$6,995</b></p> <p>Reg. Cab, V-8, AT</p>	<p><b>DODGE RAM MEGA CAB 4X4</b></p> <p><b>\$15,988</b></p> <p>Loaded</p>
<p><b>CHEVY SILVERADO 2500HD</b></p> <p><b>\$14,988</b></p> <p>Duramax Diesel Allison AT</p>	<p><b>CHEVY SILVERADO 2500HD 4X4</b></p> <p><b>\$17,988</b></p> <p>Duramax Diesel, AT, 130k miles</p>	<p><b>CHEVY 2500HD SILVERADO</b></p> <p><b>\$21,000</b></p> <p>V8, 4WD, Super Clean, Only 43,000 miles.</p>
<p><b>CHEVY SILVERADO 3500 SW 4X4</b></p> <p><b>\$14,995</b></p> <p>Reg. Cab, 6.0, AT</p>	<p><b>FORD F250 SUPER DUTY</b></p> <p><b>\$19,995</b></p> <p>V8, 4WD, Low Miles! Bale Bed.</p>	<p><b>CHEVY CREW CAB 1-TON 4X4</b></p> <p><b>\$9,995</b></p> <p>Duramax Diesel, Leather</p>
<p><b>DODGE CUMMINS TURBO DIESEL</b></p> <p><b>\$16,995</b></p> <p>Brushgard, 4x4 3500</p>	<p><b>CHEVY SILVERADO 3500 HD</b></p> <p><b>\$21,000</b></p> <p>6.6 Duramax, AT, w/dump bed, only 66k mi. Won't last!</p>	<p><b>GMC SIERRA 2500 HD CREW CAB</b></p> <p><b>\$21,000</b></p> <p>Duramax Diesel</p>
<p><b>CHEVY 2500HD 4X4 EXT CAB</b></p> <p><b>\$12,988</b></p> <p>6.0 Gas, 4x4, LOCAL TRADE!</p>	<p><b>DODGE RAM 2500 CREW CAB</b></p> <p><b>\$17,988 * \$12,995</b></p> <p>4x4, 5.9 Cummins Diesel, FULLY LOADED!</p>	<p><b>CHEVY SILVERADO 3500</b></p> <p><b>\$12,988 * \$9,995</b></p> <p>Reg. Cab, 4x4</p>
<p><b>CHEVY SILVERADO 2500 HD 4X4</b></p> <p><b>\$12,988</b></p> <p>Quad Cab, Duramax Diesel</p>	<p><b>DODGE RAM 3500 REG CAB</b></p> <p><b>\$12,988 * \$9,998</b></p> <p>4x4, LOW MILES!</p>	

**NO REASONABLE  
OFFERS REFUSED!**

**"MANY DIESELS  
IN STOCK"**

**MILLER MOTORS - 225 W. Hwy. 24, Rossville, Kansas**  
**For Sales Call: 785-584-5850**

**ESTATE AUCTION**  
**SATURDAY, NOVEMBER 12 — 10:00 AM**  
**LOCATED: 110 West 2nd Street — BARNES, KS (Follow signs)**

**TRACTOR, PICKUP, VAN, TOOLS, COLLECTIBLES, PHONOGRAPHS**  
1951 JD A tractor, redone; 1996 Dodge 4x4 Dakota pickup, auto w/133,000 miles; 1999 Chrysler Grand Caravan Sport; **Tractor & Vehicles sell at 12:30:** Sears 10HP riding lawn mower w/42" blade; Agri-fab lawn wagon; Red Devil pull behind lawn spreader; 8'x20' steel storage container; JD #9 7' sickle mower; manure spreader; all steel "Iron Age" 2 row planter; IH 12' vibrashank chisel; 6'x10' flatbed trailer w/hoist; 2-JD running gears w/hoist; McCormick running gears; 4'x10' flatbed steel trailer; 7'x12' hay wagon w/hydr. hoist; 2 wheel pickup bed trailer; 1 sect. harrow; hog feeders; water tanks; 300 gal. fuel tank; AC/WC piston head, complete overhaul kit; 5-100 lb. propane bottles; 250 gal. propane tank; Snapper push mower; propane weed burner; 60"x76" pickup topper; steel posts; el. fence posts; electric fencing supplies; fence stretcher; 15 sm. sq. prairie bales; **Horse Drawn:** 2 row lister; ox pull plow; MM 1 row planter; 1 row curler; 2 bot. plow; JD 2 bot. plow; sod plow; JD planter boxes; **Collectibles sell at 1:00:** Oak Columbia table top Grafonola; Victor table top talking machine VV-IV; Edison Standard phonograph type D; Edison home phonograph; Victor victrola; Columbia Grafonola; Fuch & Stemmer phonograph; Sonora phonograph; Ingraham & Waterbury mantle clocks; Pianolin; Harpanola; cuckoo clock; clock works; 2 violins in cases; 72 slot Barnes post office boxes; 5 metal yard gates; sq. wash tub on stand; old implement wrenches inc. JD; RR tie hammer; 100 lb. platform scale; cream cans; screen doors; bottle capper; cast iron skillets; wringer washer; bushel baskets; plastic train cars; Louis L'Amour books; apple corer; sad irons; Jars, few blue; **Tools:** Forney arc welder; Craftsman wood shaper on stand w/bits; Master Mechanic 8" drill press; Sears drill press; Craftsman 10" radial arm saw; Olson MFB. steel cut-off saw; Wilton #3230 metal band saw on stand; bench grinder on stand; power hand tools inc. drills; jig & circular saws; 220V 1.5HP air compressor; port. air compressor; Jr AC centrifuge; PowerKraft transit; 3'x5' steel work shop table; 2-3'x5' steel frame wood cabinets w/20 drawers; sq. hole drill; 4" bench vise; bolt bins; B&D Workmate; metal tool boxes; router guides & templates; corner vises; pipe clamps; lots of C-clamps; wood furniture clamps; carpenter & mechanic tools; 3/8, 1/2, 3/4 Thorsen socket sets; sockets/ratchets; wood planes & levels; hand saws; corner brace & bits; 1/4" & 5/8" tube benders; files; chisels; punches; hole saws; hammers; pipe wrenches; bolt cutters; come-along; concrete tools; riveter; axes; log chains; metal car ramps; alum. step ladder; metal pails; cross cut saws; el. gear, breakers; long handled tools; 2 wheel cart; ext. cords; apple picker; garden hose; fishing gear; ammo cans; **Household:** Card tables; folding chairs; metal wardrobe; Sears women's bicycle; 2013 Whirlpool refrigerator; microwave; metal trash cans; wood cabinets; picnic table; charcoal grill; walking canes; wood porch swing; other items.

**REAL ESTATE sells at Noon: 110 W. 2nd St., Barnes, KS:** Acreage home setting that includes 6 acres on the SW edge of town with a move-in-ready mobile home, sunroom addition (24x24 ft), double carport, steel-frame building (36x50 ft), several other outbuildings and all city utilities. **Terms:** 10% down payment day of sale & balance due in full on or before Dec. 12, 2016. Buyer & Seller equally split cost of title insurance and standard attorney fees (contract, deed & escrow). 2016 real estate taxes will be paid by Seller. **For pictures see websites.**  
[www.olmstedrealestate.com](http://www.olmstedrealestate.com) • [www.marshallcountyrealty.com](http://www.marshallcountyrealty.com)

**TERMS:** Cash Sale Day. Statements sale day take precedence. Seller & Auctioneers not responsible for accident or theft. **Lunch served by Washington County Boy Scouts.**

**GERALD RICARD ESTATE • FLOYD SUTTON ESTATE**  
**AUCTIONEERS**

Rob Olmsted 785-353-2210	Tom Olmsted 970-231-6107	Tim Olmsted 785-353-2487	Jeff Sandstrom 785-562-3788
-----------------------------	-----------------------------	-----------------------------	--------------------------------



## Kansas Rural Center Farm & Food Conference to feature NCR-SARE farmer forum

The Kansas Rural Center's 2016 Farm & Food Conference will offer a wealth of information around the theme of transforming our farm and food system to better meet future environmental, economic and social challenges. With three dynamic keynote presentations and over 25 breakout sessions, the conference promises to appeal to a broad spectrum of attendees. The conference will be held at the Four Points Sheraton Hotel in Manhattan on November 18-19, 2016. A complete agenda and registration information can be found at <http://kansasruralcenter.org/conference-2016>.

This year's conference includes a track sponsored by North Central Region-Sustainable Agriculture Research & Education (NCR-SARE), titled "The Farmer Forum." This track will highlight SARE-funded farmer research projects, with presentations by eight farmers from across Kansas, Missouri and Nebraska.

The farmers will discuss their research projects, which include creating a depository of local honey bee strains from feral hives; the economics of haying/grazing cover crops; economic analysis of cover crops, soil health and livestock; evaluating the roller crimper for cover crop control; mobile processing units for poultry; growing mushrooms with ag byproducts; and reduced tillage. NCR-SARE staff will also offer a workshop on grant writing for farmers who might be interested in applying for a SARE farmer/rancher grant, or other grant proposal.

Other workshops, presentations, and panel discussions will cover a wide range of topics, offering very practical how-to information for farmers and ranchers, community organizing ideas for civic leaders and engaged citizens, and policy analysis, discussion of issues, and inspiring models of paradigm shift around farming and food systems for all who attend.

Topics to be covered include opportunities in organics; pollinator habitat on the farm; specialty crop planning, production and profitability; the state of local foods in Kansas; weathering hard times on the farm; the food safety modernization act; stories of lessons learned and challenges overcome when starting out in farming; adding livestock to small and urban farms; the farm bill; grazing management for all seasons; spray drift impacts and implications; tree and forest management for climate change and biodiversity; farm transitions; food hubs; expanding opportunities for small-scale meat producers in Kansas; soil health and diversity; engaging Kansas policy makers; renewable energy and more.

The conference will feature three keynote speakers

who will focus on the importance of pollinators and soil health to diversified farming systems, and the critical role of connections and networks in creating healthy, viable local food systems. Keynote speakers include entomologist and award-winning researcher, Dr. Jonathan Lundgren; author and Stanford University lecturer, Dr. Liz Carlisle; and senior pollinator conservation specialist Jennifer Hopwood.

Duane Goossen and Heidi Holliday, Kansas Center for Economic Growth, will also provide a special overview of the Kansas economy and the issues and challenges that the State Legislature and citizens of Kansas will face in 2017.

Lunch featuring locally sourced ingredients will be provided each day, offering conference attendees a hearty, healthy meal and time for networking and visiting exhibitor booths in order to connect with and learn more about the great people and exciting things happening in farming, food production and the environment, in Kansas and beyond.

A social hour with live music and locally crafted beverages and snacks will immediately follow the final

workshop sessions on Friday, November 18. Don't miss this chance to continue the conversations of the day, catch up with old friends or get to know new ones in a relaxed and fun atmosphere.

Cost to attend the conference is \$65 per day, or \$120 for both days. Registration includes access to all presenters, lunch and snacks both days, and the Friday evening social hour. Student scholarships may be available.

To learn more about becoming a sponsor, registering, or scholarships at this year's conference visit <http://kansasruralcenter.org/conference-2016/>, or call Natalie Fullerton at 866-579-5469 Extension 701, or email [info@kansasruralcenter.org](mailto:info@kansasruralcenter.org).

The mission of KRC, a non-profit research, education and advocacy organization founded in 1979, is to promote the long-term health of the land and its people through research, education and advocacy that

advance an economically viable, ecologically sound, and socially just food and

farming system. For more information, visit [www.kansasruralcenter.org](http://www.kansasruralcenter.org).

### GRASSLAND IN MARION COUNTY • 2 TRACTS

## REAL ESTATE AUCTION

**FRIDAY, DECEMBER 2, 2016 — 2:00 PM**  
AUCTION LOCATION: Lincolnville Community Center,  
213 W. 6th St., LINCOLNVILLE, KANSAS 66858

### ESTATE OF MERLIN & VERLENE KAUFMAN

**TRACT 1: 312.6 ACRES**, located on the West side of Hwy. 77, 5 miles North of Florence, KS or 3.5 miles South of the Jct. of Hwy. 150 & Hwy. 77 (East of Marion).  
**TRACT 2: 480 ACRES**, located 7 miles North on Hwy. 77 from the Jct. of Hwy. 150 & 77, or 1 3/4 miles South of Lincolnville, KS on Hwy. 77 to Rd. 270 then East 2 1/2 miles to the pasture gate on the south side of the county road and the pasture pens. Road 270 is on the north & Road. 260 is on the south

For complete information, terms & photos go to  
[www.GriffinRealEstateAuction.com](http://www.GriffinRealEstateAuction.com)

**RICK GRIFFIN**  
Broker/Auctioneer  
Cell: 620-343-0473

**Griffin Real Estate & Auction Service LC**

**CHUCK MAGGARD**  
Sales/Auctioneer  
Cell: 620-794-8824

305 Broadway  
Cottonwood Falls, KS 66845  
Phone: 620-273-6421 • Fax: 620-273-6425  
Toll Free: 1-866-273-6421  
In Office: Nancy Griffin, Heidi Maggard  
Email: [griffin123r@gmail.com](mailto:griffin123r@gmail.com)  
[www.GriffinRealEstateAuction.com](http://www.GriffinRealEstateAuction.com)



## 75 GUNS AUCTION

**SUNDAY, NOVEMBER 6, 2016 — 2:00 PM**

601 S. Broadway, SALINA, KS • OPEN FOR VIEWING AT 12:00

**AUCTIONEER'S NOTE:** Seller involved in harvest and slow getting guns in. This is what we have at this time and we will probably have more by sale time. Sale ends with a beautiful group of SAKO (Finland) rifles most new and never shot. Gun condition notes as provided by seller.

### GUNS

5. Glenfield Marlin mod.75C 22 LR cal semi auto rifle ser # 20603032
6. F.A. Gradoga mod.967 6.35mm (25 cal?) pistol made in Italy ser # 4118
7. Ruger mod. Mark II 22 LR cal pistol (very good) ser # 18-73631
8. Mossberg mod.464 30-30 WIN cal lever action rifle (excellent) ser # LA003957
9. Emilio Rizzini 12 ga over/under shotgun single trigger engraved ser# B03408
10. AK-47 7.62x39 cal missing clip
11. H-R mod.922 22 cal revolver 6" bbl (good) ser # L28845
13. Savage mod.93 22 MAG cal bolt action rifle stainless steel bbl laminated stock thumb hole ser # 2328566
14. Stevens Favorite mod.30 22 LR cal single shot rifle (excellent) ser # 0028843
16. Smith & Wesson mod.229 44 MAG cal pistol stainless steel 6" bbl ser # AYP5657
17. Browning mod. Nomad 22 LR cal pistol ser # N/A
18. Browning mod. BL-22 22 S-L-LR cal lever action rifle maple wood (excellent - NIB) ser # 0169ZT242
19. CZ mod.75 Compact 9mm pistol ser # B417700
20. Browning mod. BPS Hunt 28 ga pump shotgun w/chokes & vent rib (excellent - NIB) ser # 02325ZW121
22. Baikal over/under 410 ga & 22 cal (excellent) ser # N/A
23. Ruger Old Model Single Six 22 cal revolver mfg 1960 (excellent) w/holster ser# 308573
24. E. R. Amantino mod. Uplander 410 double barrel shotgun (exec.) ser #517086-03
25. Sig Sauer mod.P238 380 cal pistol 2-tone w/night sights & holster ser # 27B120448
26. Smith-Wesson mod.MP 9mm shield pistol w/extra clip (nice) ser # HNF2329
27. ARMSCOR mod.M5 12 ga pump shotgun nickel (nice) ser # R1A1760356
28. Eagle Arms Armalite mod.AR15 556 cal semi auto rifle (nice) ser # M22-11306
30. Beretta mod.71 Jaguar 22 LR cal pistol made in Italy ser # 4601
31. Remington mod.R15 5.56 cal semi auto rifle camo stock (very good) ser # RK1008948
32. Winchester mod.70 270 WIN cal bolt action rifle w/scope ser # 760025
33. Marlin mod.1894 CB Limited Cowboy 45LC cal lever action rifle (excellent) ser # 98202667
34. Sig Sauer mod.1911 45 cal pistol (excellent) ser # 54B105728
35. LIAI mod. Target 762 cal semi auto rifle w/sling ser # UBA11L1882
36. Mossberg mod.935 12 ga MAG pump shotgun camo (excellent) ser # AM009746 (extra bbl sells separately)
37. Stevens A&J Co mod. Crack Shot 22 LR cal heavy half round half octagon bbl (very good) ser # 41316
40. DPMS mod.AR15 5.56 cal semi auto rifle (nice) ser # FFA024286
43. Ruger mod. New Model Single-Six 22 cal revolver stainless steel (excellent) w holster ser # 263-99409
44. German Luger 9mm pistol (taken from German officer w/original holster, 2 clips, field glasses) ser # 5240
45. Winchester mod.70 225WIN cal bolt action rifle w/sling (very rare - nice) ser # 758264
46. William Parkhurst 28 ga side-by-side w/hammers shotgun (very rare-double triggers-very nice) ser # 7922
47. Ithaca mod.1911 45 cal pistol WWII production 1944 US Property ser # 1835948
48. US Postal Meter M1 Carbine 30 cal (nice) ser # 423 0633
49. Colt mod. Single Action 38-40 cal revolver 5-1/2" bbl ser # 141310
50. Colt mod. Frontier 6 shooter 44 cal single action revolver w/bone grips ser # 107382
51. Sharps Carbine 50-70 Civil War used (nice) ser # N/A
52. Winchester mod.1890 22 short cal pump rifle octagon bbl (excellent) ser # 694757
53. Winchester mod.1906 22 S-L-LR pump rifle half-nickel (excellent) ser # 552469
54. Winchester mod.68 22 S-L-LR bolt action rifle ser # N/A
55. Winchester mod.1200 12 ga pump riot gun ser # 287437
56. Winchester mod.1906 22 S-L-LR pump rifle (excellent) ser # 399692
58. Colt mod.1862 Police 36 cal revolver mfg 1862 Civil War gun (good) ser # 23425
59. Colt mod.1878 DA 44-40 cal revolver mfg 1890 nickel ser # 26660
61. Winchester mod.1892 32-20 cal rifle octagon bbl (mint condition) ser # 845915
62. Winchester mod.1873 Carbine 44-40 cal First Model ser # 8698
64. H&R 243 WIN cal single shot rifle w/3x9 scope ser # CBA 138992
65. Ruger mod.10/22 Carbine 22 LR semi auto w/Weaver scope ser # 122-92316
66. GSG mod.522 22 LR semi auto rifle ser # A489015
67. H&R Topper Jr mod.88 20 ga single shot shotgun ser # AU462486
68. Hi-Point mod.4095 40 S&W cal semi auto rifle w/sling & BSA night scope ser # H18938
69. Remington mod.700 243 WIN bolt action rifle w/3x9x40 scope camo ser # G7169537
70. New England Firearms mod. Handi Rifle 223 REM single shot rifle w/3x9x40 McStar scope ser # 258722
71. Hi-Point mod.4595 45 ACP cal semi auto rifle ser# 24763
72. Sig Sauer mod. Mosquito 22 LR cal semi auto pistol ser # F300729
73. Rug mod.M77 7mm REM MAG bolt action rifle ser # 771-78775
74. Winchester mod.1866 44 rim fire cal lever action rifle w/saddle ring ser # 123763
75. SAKO mod.AV 416 REM MAG cal bolt action rifle new, never shot ser # 800535
76. SAKO mod.L579-Forester 308 cal bolt action rifle never shot ser # 22351
77. SAKO mod.L57-Forester 243 cal bolt action rifle ser # 9195
78. SAKO mod.L61R-FinnBear 338 MAG cal bolt action rifle never shot ser # 38539
79. SAKO mod.VL63-FinnWolf 243 cal lever action rifle w/3x9 Leupold scope VARI-XII ser # 10972
80. SAKO mod.L61R Finn Bear 7mm REM MAG cal bolt action rifle never shot ser # 39153
81. SAKO mod. V 375 H&H MAG cal bolt action rifle never shot ser # 954499
82. SAKO mod.AV 6.5 x 55 SE bolt action rifle never shot ser # 605749
83. SAKO mod.L579-Forester 22-250 cal bolt action rifle never shot ser # 311359
84. SAKO mod.AV 338 WIN MAG cal bolt action rifle never shot ser # 615493

### UPCOMING AUCTION

**CONSIGNMENT SALE: Saturday, November 26, 2016 at 10:00 am, 601 S Broadway, Salina, KS**  
Contact auction staff, consign early and benefit from \$\$\$ advertising in newspapers and web sites. The last sale filled up early and consignments were shut off - the time to bring in your consignments is now! WATCH OUR WEB SITE FOR SALE BILL.

**CALL TO BOOK YOUR FARM, HOUSEHOLD, OR MACHINERY AUCTION!**

**Wilson Realty & Auction Service**

P.O. BOX 1305, SALINA, KS 67401 • (785) 827-5563  
LONNIE WILSON - OWNER/BROKER/AUCTIONEER • (785) 826-7800  
DAVE HUNT - SALES MANAGER • (785) 201-5257  
CAROLYN HUTCHINS - OFFICE MANAGER • (785) 823-1177  
Website & Contact Email Addresses: [www.soldbywilson.com](http://www.soldbywilson.com)



For Latest Update & Pictures  
go to website:

[www.soldbywilson.com](http://www.soldbywilson.com)

Any announcement made the day of sale  
takes precedence over any printed matter.

## AUCTION

**SATURDAY, NOVEMBER 5 — 10:00 AM**

East of Topeka, KS. on Hwy 24, 1/8 mi. past K4, to Allen Rd.  
2 mi. South — 1303 Allen Rd.

**POWER & OTHER TOOLS, COLLECTIBLES & MISC.**

**MR. INGENTHON WAS A LONG TIME CABINET MAKER  
& WOOD WORKER.**

See Complete Listing & pictures at [www.kansasauctions.net/edgecomb](http://www.kansasauctions.net/edgecomb)

**TOM INGENTHON ESTATE**

EDGEComb AUCTIONS: 785-594-3507; Les' Cell: 785-766-6074



Wichita, KS

**866-643-0555**

[www.edisonlightingsupply.com](http://www.edisonlightingsupply.com)

**× Heavy Duty Interior  
& Exterior LED Lights**

**× Top Quality  
Components**

**10% OFF**  
Listed Price

**PLUS FREE**

**SHIPPING**

On ALL

Show Orders

**SHOW SPECIALS**

Stop By Annex Booth #N6-10 At The Wichita Farm Show!



## Intercropping: intersection of soil health, production

Plant scientist Ann Bybee-Finley says her first field experiment was humbling. "I felt like a very small scientist in a very big world," she said.

Bybee-Finley researches intercropping at Cornell University. Intercropping is a complex practice of farming where different plant species are grown in the same space. Most conventional farmers only plant one crop per field or plot. This practice, called monoculture farming, is more

convenient for farmers, but it can make the plants more vulnerable. For example, if one plant gets a disease, the others are likely to catch it. Weeds are more likely to find a home in spaces that are very similar. As a result, monoculture farming can be dependent on expensive synthetic chemicals to ward off weeds and diseases.

Droughts and other weather events can also damage entire monoculture fields. Bybee-Finley says a bad drought in 2012 shaped

her vision of agriculture. "The stories of crop failure made me want to understand how to make farming practices more resilient, especially as climate change makes extreme weather events more frequent."

Intercropping gives farmers more options if one of their crops fails. "It's like a diversified stock portfolio," said Bybee-Finley. Plant diversity leads to more diversity below ground too. Plants that add organic matter and nutrients when they decompose replenish the soil.

In her experiment, Bybee-Finley planted four cover crops, which are plants that add fertility to the soil and protect it from

erosion. She planted two grasses, pearl millet and sorghum, and two legumes, cowpea and sunn hemp. The grasses are well known for their ability to add organic matter to tired soils whose nutrients have been depleted by years of farming. Legumes are also good for the soil because their roots release nitrogen when they decompose. These cover crops are also a feed source for cows and other livestock, providing farmers another source of income.

In her experiment, Bybee-Finley found the grasses and legumes that grew at the same pace were more productive because they weren't competing for space and resources as

much as plants that grew at different rates. On the other hand, she found that some plant combinations grew more, while others had more nitrogen.

"I'm sure there's a sweet spot," said Bybee-Finley, "There's so many unexplored avenues and questions to ask: Which species should I plant together? And how many of each?"

Bybee-Finley said the next step for this experiment is to see which plant combinations were the most nutritious for animals.

For experiments with lots of variables like this one, Bybee-Finley says you end up with a complex set of conclusions. "When you're looking at an entire system it makes it harder to have an immediate take-away," she said. "It takes longer to come up with a definite conclusion."

But Bybee-Finley is com-

fortable with complexity. "Diversity begets diversity," she said. "Agricultural science is beginning to look beyond the simplified strategy of planting only one crop per rotation."

For Bybee-Finley, intercropping is full of tradeoffs, and the life lesson of agriculture is that plants don't always behave the way you expect them to. "The miracle of biology is that plants, no matter what you do, will do exactly what they want to do."

Read more about this research in *Crop Science*. Cornell University, National Institute of Food and Agriculture, U.S. Department of Agriculture, Hatch Project 2013-14-425: Expanding the role of cover crops in sustainable cropping systems, and NE SARE Graduate Student Project GNE14-073 funded this research.

### PERSONAL PROPERTY AUCTION

**SUNDAY, NOVEMBER 6 — 1:00 PM**

AUCTION LOCATION: T-Building, Swope Park, COTTONWOOD FALLS, KANSAS 66845

**Sellers: Partial Estate of GRETA MARIE MILLER & Others**

ANTIQUES & COLLECTIBLES, VINTAGE TESTING EQUIPMENT, CAMERAS & RADIOS, GLASSWARE & POTTERY, PRIMITIVES, TOYS & GAMES, TOOLS, LAWN & OUTDOOR ITEMS, FISH EQUIP., HAND TOOLS, HOUSEHOLD & MISC. & MORE!

See last week's Grass & Grain for listings & go to [www.GriffinRealEstateAuction.com](http://www.GriffinRealEstateAuction.com)

**RICK GRIFFIN**  
Broker/Auctioneer  
Cell: 620-343-0473

**Griffin Real Estate**



**& Auction Service LC**

**CHUCK MAGGARD**  
Sales/Auctioneer  
Cell: 620-794-8824

305 Broadway  
Cottonwood Falls, KS 66845  
Phone: 620-273-6421 • Fax: 620-273-6425  
Toll Free: 1-866-273-6421

In Office: Nancy Griffin, Heidi Maggard  
Email: [griffin123r@gmail.com](mailto:griffin123r@gmail.com)  
[www.GriffinRealEstateAuction.com](http://www.GriffinRealEstateAuction.com)



### FARMLAND AUCTION

**TUESDAY, NOVEMBER 15, 2016 — 7:00 PM**

Clay Center National Guard Armory at 12th & Bridge Sts., CLAY CENTER, KANSAS

**486.99 ACRES OF CLAY COUNTY, KANSAS  
CROPLAND, PASTURE & HABITAT**

**TRACT 1:** The E2NW4 of Section 28-7-1, Clay County, Kansas. This tract consists of 79.78 acres according to FSA records. The entire tract is classified as cropland which includes 74.04 tillable acres and 5.74 acres of waterway. Soil types are primarily Class II Crete (Cs) and Class I Crete (Cx), with smaller areas of Class III Geary (Gc) and Class I Muir (Mu) at the southern end of the farm. This is a nice 80.2015 property taxes were \$1,050.90. Tract 1 is located from the west edge of Clay Center, Kansas 11 miles west on Highway 24 to Cherokee Rd. then 2.5 miles north to the southwest corner of the tract.

**TRACT 2:** The SE4 of section 20-7-1, Clay County, Kansas. This tract consists of 163.39 acres according to FSA records. There are 62.95 acres of cropland which include 60.84 tillable acres and 2.11 acres of waterway. The remaining 100.44 acres includes pasture, trees, pond, and an old building site to north along the south side of 22nd road. Soil types on this tract are nearly all Class II through Class IV Crete and Geary soils. There is an area of Class II Hobbs (Ho) to the southeast along the creek. 2015 property taxes were \$1,051.04. Tract 2 is located from Clay Center, Kansas 12 miles west on Highway 24 to Buffalo Rd., then 3.5 miles north to 22nd Rd., and 1/2 mile east to the northwest corner of the tract.

**TRACT 3:** The E2NE4 of Section 29-7-1, Clay County, Kansas. This tract consists of 80.43 acres according to FSA records. There are 34.14 acres classified as cropland which include 22.38 acres currently under cultivation and 11.76 former CRP acres which are still in grass. The remaining 46.29 acres are pasture, creek and trees. There is very good wildlife habitat on this tract. Soil types on this farm are all Class II Crete (Cs), Class III Geary (Gc), and Class II Hobbs (Ho) along the creek. 2015 property taxes were \$685.90. Tract 3 is located from the west edge of Clay Center, Kansas 11 miles west on Highway 24 to Cherokee Rd. then 2.5 miles north to the southeast corner of the tract.

**TRACT 4:** The W2NE4 and the E2NW4 of Section 29-7-1, Clay County, Kansas. This tract consists of 163.39 acres according to FSA records. There are 84.10 acres classified as cropland which include 80.33 tillable acres and 3.77 acres of waterways. The remaining 79.29 acres are pasture, trees and other very good wildlife habitat. Soil types on the cropland are Class II Crete (Cs) and Class III Geary (Gc). The remainder of the tract is primarily Class II Geary along and around the cropland, Class II Hobbs (Ho) along the creek to the northeast, and Class IV Lancaster (Lc) to the northwest. This farm joins Tract 3 on the east, and the west half of Tract 2 on the north. 2015 property taxes were \$1,335.98. Tract 2 is located from Clay Center, Kansas 12 miles west on Highway 24 to Buffalo Rd., then 2.5 miles north to the easement road which runs 1/4 mile east to the southwest corner of the tract.

**NOTE:** This auction includes good farms which have been in the Dunn and Hosler families for many years. Most of these farms have great habitat and offer great hunting. These farms are in compliance with FSA requirements. These farms are contiguous with only Cherokee Road dividing Tract 1 from the rest of the land. There is no east/west road between sections 20 and 29. 22nd Road runs along the center line of section 20 and along the north side of Tract 2. Part of Cherokee Rd. is not an all weather road. In the event of adverse weather all farms can be best accessed via Buffalo Rd., 22nd Rd., and then south on Cherokee Rd. We plan to sell the farms in the order they are listed unless additional information is brought to bear. If any changes are made it will be posted at our website.

**For the sale bill, FSA tract maps and other FSA records, along with any changes, updates, or additional information go to [kretzauctions.com](http://kretzauctions.com) or [kansasauctions.net](http://kansasauctions.net).**

**TERMS:** The buyer is to pay 10% down day of sale with the balance due at closing. Title insurance and escrow fees to be paid 1/2 each by the seller and the buyer. Seller will pay 2016 and all prior years property taxes. 2017 property taxes are to be paid by the buyer. The Mark Germann family are the tenants and the farm is sold subject to their rights. All of the cropland will be planted to wheat. The new buyer is to receive the landlords 1/3 share of the wheat crop and will pay the landlords 1/3 share of related expenses incurred after closing. The new buyer will receive possession of the wheat ground at the completion of the 2017 wheat harvest. In order to allow the Germann time to remove hay and other property the buyer of Tract 2 will receive possession of non crop acres on January 1st, 2017 or at closing, whichever is the latter. The buyer of all other tracts will receive possession of non crop acres at closing. The new buyer will receive all mineral rights. The contract, deed and down payment are to be escrowed at **Clay County Abstract & Title, 509 Court St., Clay Center, Kansas.** Announcements made sale day are to take precedence over printed matter. Sellers and agents are not responsible for accidents. The auction firm is working for the sellers.

**DAVID & KATHLEEN L. DUNN, SELLERS  
DARRELL & NANCY E. HOSLER, SELLERS**

Auction conducted by: **Clay County Real Estate  
Greg Kretz, Salesman & Auctioneer**  
Phone: (785) 456-9724, Cell: (785) 630-0701

### COMMERCIAL REAL ESTATE & PERSONAL PROPERTY AUCTION

**WEDNESDAY, NOVEMBER 9 — 3:00 PM**

515 Riley Avenue — OGDEN, KANSAS

**Commercial property building, 7501 sq. ft.,  
zoned C2, lot 24450 sq. ft.**

**PERSONAL PROPERTY**

Neon bar lights, commercial oven and stove, deep fat fryer, cash register, walk-in cooler, chairs, bar stools, tables, electronic Bingo equipment, ping pong table, beer keg coolers, commercial popcorn popper, misc. bar and kitchen equipment, filing cabinets, flag poles, military tent, Foosball table, piano, candy vending machine, janitorial supplies, Christmas decorations, Coke vending machine **AND MUCH MORE.**

**AUCTIONEERS NOTE:** This was previously the American Legion Post 207 in Ogdén, KS. Great opportunity to buy commercial property on the East side of the gate to Fort Riley. High Traffic count passes this property.

**Terms:** Prospective real estate buyers will need to register at the auction and have bank letter of credit to be able to bid on this property. 20% earnest money non refundable deposit will be collected day of sale. Property is selling "as is where is." Closing to occur on or before December 9th, 2016. Announcements made day of auction take precedence over previous printed material.  
**Contact Auctioneer to view property**



**Jeff Ruckert, Auctioneer**  
Manhattan, KS 66502  
785-565-8293  
[jctt.97@gmail.com](mailto:jctt.97@gmail.com)

[www.RuckertAuctions.com](http://www.RuckertAuctions.com)

### THE HEIENS LAND 445 ACRES

**Dickinson County Farmland  
Offered in 3 Tracts**

#### GENERAL INFORMATION:

These farms have been owned by the Heiens family for a number of years and offer the opportunity to purchase good, productive, well-located farmland in areas where land seldom changes hands. Take a Sunday afternoon drive and give these properties a look. Visit [www.riordanauction.com](http://www.riordanauction.com) for soil maps, FSA photos and other information.

**TRACT #1:** NE 1/4 of 24-12-1E. 108.58 acres tillable (all open), 2.4 acres CRP, 9.63 acres waterways and approximately 37 acres grass, timber and waste. Predominately Muir Silt Loam, Class I soil. 2015 taxes were \$1,937.48 based on 157.6 taxable acres.

#### FSA INFORMATION:

	Farmland Acres	Cropland Acres	Wheat Base/Yield	Sorghum Base/Yield	Soybean Base/Yield	Corn Base/Yield
Tract #1	156.59	120.85	64.2/35	17.4/53	15.0/16	n/a
Tract #2	212.00	189.34	75.3/35	40.2/53	17.3/16	6.1/55
Tract #3	76.52	66.86	34.9/35	9.6/53	n/a	n/a

The above are FSA estimates only and are not guaranteed.

**TRACT #2:** W/2 NE 1/4 and NW 1/4 lying East of Railroad right-of-way in 5-13-2E and 2.1 acre tract located in NE corner of 6-13-2E. 159.80 acres tillable (all open), 2.7 acres CRP, 43.0 acres creek, timber and waste. Predominately Muir Silt Loam, Class I soil. 2015 taxes were \$2,596.25 based on 212.64 taxable acres. (6.06 surveyed acres containing home and outbuildings are **NOT** included in the sale).

**TRACT #3:** N/2 SE 1/4 of 8-13-2E. 46.86 acres tillable (all open), 18.2 acres CRP and 10.14 acres creek timber and waste. Predominately Muir Silt Loam, Class I and Elsmere Sandy Loam Class II soils. 2015 taxes were \$795.12 based on 75.2 taxable acres.

#### RECREATIONAL POSSIBILITIES:

Have you ever wanted to purchase a highly productive farm with timber and a beautiful creek meandering through it that allows for outstanding deer/turkey hunting and enough firewood to last for generations? Take a look at Tract #2. A versatile, well located farm of this type is seldom offered at public sale.

**SELLERS:** Heirs of WR and Gladys Heiens

### FARMLAND AUCTION

Thursday, November 17, 2016  
7:30 p.m.

Sale held at the Abilene Civic Center  
210 NW Second, Abilene, Kansas

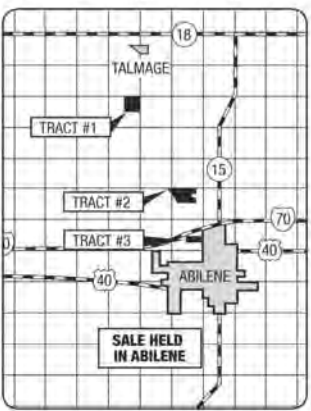

#### TERMS AND CONDITIONS:

10% due day of sale, with balance due 12-29-2016. If for some reason title conveyance cannot be completed by 12-29-2016, buyer to pay 10% per annum interest on unpaid balance from 12-29-2016 until date sales are closed.

2016 real estate taxes and prior years paid by Seller. Title Insurance will be used with cost split equally between Buyer and Seller. All mineral rights owned sell with property. Property selling "as is" with no guarantees or warranties made by seller.

Announcements made at the auction take precedence. All information given is from sources deemed reliable, but not guaranteed. Property selling subject to easements, restrictions and reservations if now existing. Auction Company is representing the sellers in this transaction.

**POSSESSION:** All ground is open. Possession given at closing.

**SALE CONDUCTED BY:**



**SELLERS:** Heirs of WR and Gladys Heiens

### AUCTION

**SATURDAY, NOVEMBER 12 — 1:00 PM**

1007 W. Silver — GENESEO, KANSAS

**Enjoy the Veterans Day Celebration — then spend the afternoon at the auction!**

**Selling: TOOLS & EQUIPMENT:** Wheel House Garden Tractor, Sears Craftsman Riding Mower, Commercial size air compressor, Floor model drill press, Mechanic and large selection of general line of tools, Work bench and shelves.

**HOUSEHOLD & COLLECTIBLES:** Antique baby bed, Bunk beds, Mickey Mouse & Coca-Cola Items.

**IRENE & SHERMAN HART ESTATE**

Check website for details and pics

[www.strohsrealestateandauktion.com](http://www.strohsrealestateandauktion.com)

Statements made sale day take precedence over printed material.



### MORRIS COUNTY REAL ESTATE AUCTION

**SATURDAY, DECEMBER 3 — 12:30 PM**

2476 Diamond Creek Road • BURDICK, KANSAS

**Tract 1:** 38.7 acres with 3 bedroom ranch style house 12.6 acres farmland, balance pasture.

**Tract 2:** 93 acres, 29 acres of creek bottom farmland, balance pasture and timber.

**Tract 3:** 24.5 acres, 9 acres farmland, balance hay meadow & creek.

**Tract 4:** 8.8 acres pasture.

**MISER & FISCHER FAMILIES**

**See next week's Grass & Grain for complete sale bill**

### HALLGREN REAL ESTATE & AUCTIONS, LLC

**ALTA VISTA, KANSAS • 785-499-5376**

**GREG HALLGREN**  
785-499-2897

**JAY E. BROWN**  
785-223-7555

e-mail: [ghallgren@live.com](mailto:ghallgren@live.com)

[www.hallgrenauctions.net](http://www.hallgrenauctions.net) • [KSALink.com](http://KSALink.com)

### PERSONAL PROPERTY AUCTION

**SUNDAY, NOVEMBER 13 — 11:00 AM**

**Location: Louisville Gym, 3 Miles North of Wamego on Hwy. 99**

**BOAT:** 17' Harters Canoe w/weighted Keel; 17' Canoe Trailer; 12' American Fiber-Lite Sport Canoe; Old Fire Chief Boat Motor; Sling Shot Para Sail (2). **HORNS, FURS, & BONES:** Mounted Cobra Snake; lg. mounted Texas Longhorns; Deer & Elk Antlers; Prehistoric Bones; Indian Artifacts; Willy Mammoth, spine & hip; Kansas Camel; Animal Skulls (fish, bison, camel); Furs (beaver, fox, etc.); Pre-Kansas Elk Sheds; Deer Hydes; petrified wood; Iron wood animals. **ANTIQUES & COLLECTIBLES:** Bar & Cabinet out of Grieves Café (Wamego); Various Antique wood chairs; Myers Pump (Feb. 15, 1921); C.I. Stove parts: screen door; gal. wash tub; Kalimba African Finger Musical Harp; 35 Day Centurian Clock; 31 Day Brookwood Clock; Ingraham Mantel Clock; tractor seat & tractor seat stool; cream separator; child's wagon wheels; pocket watches; belt buckles (Tony Lama State of Kansas Seal, 10th Anniv. of Ranch Saloon, McFarland, KS 1887-1987 & many more); 1930s Lamp Post w/Glass Globes (NICE); smoke stand; fishing reels & lures; Budweiser mugs; Buick HD oil can (unopened); Top Cigarette Tobacco Tin; Singer oil can; Allis-Chalmers Repair Parts #507628 Tin (unopened); lots of bottles; lighters; automobile ornaments; kerosene lamps & parts; barn lanterns; draw knife; cameras; glass doorknobs; radio; ice tongs; sev. crocks (some handled, 2 & 4 gal. & others); creamers; sev. glass insulators (Pinto, GE, Purple & others); magazines; sev. Navy Books; Korean helmet; WWII helmet; framed Civil War pictures; Lone Wolf picture; Lone Elk picture (unique); Augers Hollis Pheasant picture; White Tiger pictures; 1984 Cougar picture—Ron Fehr; 1946 Film picture; Finson water color Buffalo picture; Pott. Co. Pork & Bean Band Framed picture by Lou Borgendale; various Pott. Co. Pork & Bean Band Posters & other posters; Lineman posters (Equi Zone & others); Metal Fall Out Sign; Metal Wild Turkey Reward Sign; C.I. Bear Welcome sign; Bear signs; Jack Daniels, Corona, Southern Comfort & Coors mirrors; Jack Daniels tray; Miller Racing Tin sign; Michelob Light; Budweiser pool table light; Miller Light RC Boat; Bols Ballerina Liquor bottle & other liquor bottles; Coca-Cola items. **TOOLS:** Companion drill press; bench grinder; GB HD Sidewinder bender (like new); 2 table saws; 10" band saw; 6.0hp 30 gal. Craftsman air comp; chop saw; cordless drills; sanders; chain saw; axes & hatchets; welding table; sm. solvent cleaners; chisels; drill bits; woodworking tools; leather tools; screwdrivers, vise grips, pipe wrenches, sockets; C-clamps; log chains; saw blades (sev. sizes); hand saws; mitre boxes; levels; surveying tripod; levels; air hose; misc. automotive parts; creepers; car ramps; 2T floor jack; rope winch lines; wood pulleys & blocks; Reese hitch; receiver; pendel hitches; air tank; ext. ladder; cobbler's vise; metal cabinets; organizers; nuts, bolts, screws. **LINEMAN, ELECTRICAL & PLUMBING:** Hot Sticks; Lineman Saddles; tool belts; Underground Secondary Cable; Elect. Pannels, Wire, Boxes, etc.; Lighting Arrestors (var. sizes); Lots of Plumbing & Electrical Supplies.

**SELLERS: REX & ANGIE FAIR**

**Lots more ... see website!**



**7840 E US Hwy 24, Manhattan 785-539-2732**  
**Andrew Sylvester, Auctioneer 785-456-4352**  
**Terri Hollenbeck, Broker/Owner, 785-223-2947**  
**[www.crossroads.com](http://www.crossroads.com) • LUNCH SERVED!**



# BLACK ink

## Limits? What limits?

By Steve Suther

Your cows may be held in by fences, but there are few limits on where you go or what you can do with the herd. Perceived barriers these days are just untested assumptions where imagination and technology are opening new gates.

Granted, the beef community is not flush with cash as it was a couple of years ago, but markets will emerge from these dark days, still rewarding premium quality, efficiently produced beef.

Your limit could be "knowing" what is not so. Folks in harsh environments often resort to operating herds of "tough" cattle that can take whatever nature dishes out – but also maintain a tough profile when chefs try to create a beef dish for consumers.

Arizona rancher Chuck Backus recently won a national award for challenging conventional wisdom and developing a herd in the high desert that can produce mostly Prime grade beef. Heat synchronization, artificial insemination (AI), genomic testing and good records were his main tools. Feed efficiency is the next target to acquire without backing away from quality. Solely solar powered since the 1970s, the ranch is always weighing new technology.

Genetics have become increasingly predictable, especially within breeds that access millions of data points, bolstered by individual genomic tests. The rest of cattle ranching is about to catch up, starting with high-tech breeding systems.

This year Japan-based Fujitsu unveiled its "Connected Cow" system that uses pedometers and transmitters to determine peak heat and project ideal AI time. Success for one-time breeding has increased from 44% to now 90%, the

tures irrigated by sprinklers on biostat switches and "cloud-based systems in the internet of things." That concept spread from its start in "smart homes" and office buildings to micro-electronic machine control all over the world and even into space.

GPS and radio-frequency identification (RFID) tags have paved the way to automatically enhanced beef production. You may reject such high-tech ideas or simply remain on the fence while waiting to see what's next.

"Next" may be now, considering nose prints have been investigated for ID since 1921. We don't yet know of commercially available programs, but they're as unique as fingerprints and machine-learning systems claimed 94% accuracy

company says.

If you're into crop farming as well as livestock, you know how global positioning systems (GPS) have increased efficiency in field operations.

Cattle already graze pas-



Ava Crist earned champion junior meat goat showman honors at the Central Kansas Free Fair in Abilene.

## 2-DAY AUCTION

SATURDAY, NOVEMBER 19 — 11:00 AM  
SUNDAY, NOVEMBER 20 — 11:00 AM

721 Levee Drive — MANHATTAN, KANSAS

### HUGE BUILDING MATERIALS AUCTION DAY! Saturday, November 19 — 11:00 AM

Featuring: 3 Semi Truck loads, huge selection of Kitchen cabinets, Granite counter tops, interior and exterior doors, windows, hardwood and tile flooring, lumber, lighting, Sinks, faucets, vanities, Appliances all from major distributors and much, much, more. Auctioneers Note: If you're looking for materials to remodel your kitchen or rental ... DON'T MISS THIS AUCTION.

### RILEY COUNTY POLICE DEPT. SEIZED ASSETS Sunday, November 20 — 11:00 AM

(5) 2011 Crown Victoria police cars, 2011 Ford Explorer, 04 Lexus hard top convertible, Bicycles.

• Several estates including furniture, household, antiques, collectibles and gardening items. Much more on sale day. Auctioneers Note: 2 outstanding Auctions. We will be adding more as we get closer to auction day. Concessions will be available both days. Adding more each day. Keep an eye on our website at [totallyauktion.com](http://totallyauktion.com)

TERMS & CONDITIONS: 10% buyer's premium applies to all sales. Forms of payment: Credit Cards, Cash or good check. Announcements day of sale take precedence over previous printed materials.

## TOTALLYAUCTION.COM

QUESTIONS? Contact: Auctioneer, Jeff Ruckert  
785-565-8293 • [jctt.97@gmail.com](mailto:jctt.97@gmail.com)

## NORTHEAST KANSAS MULTI-PAR HOME & LAND AUCTION

THURSDAY, NOVEMBER 10, 2016 — 7:00 PM

(Registration starts at 6:15)

AUCTION LOCATION: Ozawkie Township Hall, 524 Kiowa Drive, Ozawkie, KS  
OPEN HOUSE PROPERTY PREVIEWS (Property information packets available):  
Tuesday Nov. 1, 4-6 pm and Sunday Nov. 6, 1-3 pm

PROPERTY BEING SOLD: 12002 K4 HIGHWAY, OZAWKIE, KS

**TRACT 1:** Location, location! Help yourself to this 4 bedroom, 1 bath, 1 1/2 story farm home. Nestled at the end of a long, tree-lined drive, this 1,376 sq. ft. m/l home has been cared for by the seller for the past 48 years. Situated on 47 acres m/l, the property features a barn and numerous other outbuildings. Acreage includes grass, trees, and nice pond. Frontage on K-4 and 122nd Street. Welcome to the country life!

**METHOD:** The properties will be offered via the multi-par auction method. Tracts 1 and 2 will be offered individually and then as a whole. Individual and whole tract bidders will have the opportunity to increase their bids until all bidding is complete. Contact auction company with questions.

\*\*\*NOTE: DRONE VIDEO FOOTAGE AND PHOTOS AT: [WWW.UCNEASTKANSAS.COM](http://WWW.UCNEASTKANSAS.COM)

**Partial terms:** Non-refundable \$5,000.00 earnest money EACH for Tracts 1 & 2. \$10,000.00 earnest money for Tract 3. Buyers must show bank letter of credit in order to register to bid. Property(ies) sell as-is with any faults. Statements made at time of auction take precedence over advertising and previous statements. Full terms & conditions available on our website, at property preview events, or by contacting auction company.

SELLER: ROBERTA E. HAGEMANN TRUST



Heart of America  
Real Estate  
& Auction

Andy Conser, CAI-UCMA/Auctioneer/Realtor  
Becky Wise, Broker  
785-806-6921 • 785-863-3322  
email: [andy@ucheartofamerica.com](mailto:andy@ucheartofamerica.com)  
[www.ucnortheastkansas.com](http://www.ucnortheastkansas.com)

in 2014. Now they're learning to include other biometrics like hair whorls further up the muzzle and actual face recognition.

Precision livestock systems that use "conventional" RFID, GPS and transmitters now allow companies to manage cows in rotational grazing cells. They monitor biomass and activate a cake feeder while opening the next gate or advance rolling fences like traveling irrigation pivots.

More than that, they are developing into systems that constantly fine-tune management to optimize health and welfare, pinpointing any problems that require human intervention on location the minute they show up, i.e., "real time." This technology is available today.

Chitale Dairy in India uses it to manage 200,000 cows on 10,000 family farms, matching cows with sires and the best local forages. More efficient grazing has opened thousands of acres for crop farming.

Applied analysis of "big data" from continuously monitored cows can ratchet tomorrow's beef herd toward higher efficiency and marbling while documenting environmental and animal welfare gains.

This isn't a dark future with corporate, robotic cowboys taking over from family ranchers, though we can expect the usual economies of scale. Tech companies will



GSI

GRAIN BINS

ALL SIZES AVAILABLE

Hopper Bins Available

FINANCING AVAILABLE

Harder AG PRODUCTS

West Highway 50

PEABODY, KANSAS 66866

Phone 620-983-2158

[www.grainbinsusa.com](http://www.grainbinsusa.com)

## HERINGTON LIVESTOCK COMMISSION CO.



CATTLE SALE EVERY WEDNESDAY: 11:30 AM

SELL HOGS 1ST & 3RD

WEDNESDAY OF EVERY MONTH

10/26/16

Steer and heifer calves sold \$4-\$5 higher. Feeder steers and heifers sold \$5-\$10 higher depending on quality and condition. Cows and bulls sold \$2-\$3 higher.

COWS			
Wht Cty, 1 rwf	1160@70.00	Tampa, 1 blk	1455@60.00
Herington, 6 blk	1249@67.00	Herington, 1 blk	1285@58.50
Herington, 1 blk	1685@65.50	Herington, 1 blk	1390@58.50
Marion, 1 blk	1650@65.50	Tampa, 1 blk	1535@58.00
Marion, 1 red	1745@65.50	Tampa, 1 blk	1430@56.50
Herington, 1 blk	1725@65.00	Woodbine, 1 red	1350@56.50
Herington, 1 blk	1415@65.00	Herington, 1 blk	1290@53.50
Marion, 1 blk	1960@65.00	BULLS	
Marion, 1 red	1530@65.00	Hillsboro, 2 blk	345@136.00
Cncl Grve, 1 blk	1385@65.00	Hillsboro, 5 blk	530@116.00
Cncl Grve, 1 blk	1450@65.00	Lncnlvle, 1 wht	1700@82.50
Marion, 2 red	1840@64.50	Herington, 1 blk	1720@75.00
Marion, 1 red	1640@64.50	Durham, 1 blk	2030@75.00
Marion, 1 red	1975@64.50	STEERS	
Cncl Grve, 1 blk	1395@64.00	Wht Cty, 4 blk	435@141.50
Cncl Grve, 1 blk	1350@64.00	Cncl Grve, 3 blk	413@141.00
Cncl Grve, 1 blk	1535@63.50	Lncnlvle, 33 red	837@134.10
Ramona, 1 red	1570@63.00	Lncnlvle, 66 red	854@132.75
Herington, 1 blk	1425@62.50	Lncnlvle, 65 red	863@131.00
Marion, 1 red	1410@62.50	Wht Cty, 6 blk	474@131.00
Tampa, 1 blk	1210@60.00	Hope, 61 blk	887@129.25
Tampa, 1 rwf	1340@60.00	Lncnlvle, 52 blk	772@129.00
		Woodbine, 19 mix	848@125.50
HEIFERS			
Herington, 27 mix	815@124.00	Cncl Grve, 3 mix	340@125.00
Cncl Grve, 3 blk	585@122.00	Hillsboro, 11 blk	440@119.00
Herington, 17 blk	863@121.00	Herington, 41 mix	812@118.00
Herington, 6 blk	578@120.50	Hope, 6 blk	791@115.25
Wht Cty, 8 blk	616@118.00	Herington, 7 blk	800@115.00
Herington, 24 mix	823@116.50	Wht Cty, 10 mix	484@115.00
Wht Cty, 18 mix	591@116.25	Herington, 12 blk	535@113.00
Ramona, 4 blk	763@115.50	Lncnlvle, 6 Char	688@112.00
Herington, 36 Char	963@114.35	Wht Cty, 13 mix	588@108.75
Tampa, 52 mix	1014@113.00	Herington, 13 mix	906@107.35
Tampa, 52 blk	1049@111.35		
Herington, 7 blk	747@110.00		

## EARLY CONSIGNMENTS FOR NOVEMBER 2:

- 20 blk str, 450-600 lbs, home raised, weaned, all shots, poured
- 29 blk hfrs, 450-600 lbs, home raised, weaned, shots, calf hooded
- 12 mix str & hfrs, 500-600 lbs
- 18 mix str & hfrs, 500-600 lbs, weaned
- 10 mix str & hfrs, 500-600 lbs, weaned
- 28 mix hfrs, 800-825 lbs
- 20 mix str, 750-800 lbs
- 60 blk str, 825-850 lbs
- 69 blk str, 875-925 lbs, coming off grass
- 60 mix str, 850-900 lbs, pending

MORE CATTLE BY SALE TIME!

## THANKSGIVING SPECIAL SHEEP AND GOAT SALE: NOVEMBER 17 @ 6:30

Our Consignments can now be viewed after 12 Noon on Mondays by going to [www.grassandgrain.com](http://www.grassandgrain.com) & logging onto the online Subscription.

View Our Auction Live at [LMAAUCTIONS.COM](http://LMAAUCTIONS.COM)

KFRM AM 550, Every Wed., 8:00 a.m. • Barn Phone 785-258-2205

Bill Mathias, Manager • 785-258-0102

Gary Suderman - 913-837-6785 • Rick Parkerson - 620-767-2738  
Bob Kickhafer, Cell - 785-258-4188 • Dave Bures - 402-766-3743



# MARSHALL MOTORS IS YOUR HD TRUCK HEADQUARTERS!

## We have a truck for just about every need, New or Used.



**\$27,995**

**2012 Ram 2500**  
Single cab 4x4, 5.7L HEMI, vinyl floors,  
power equipment, 6 spd. auto,  
Hydra Bed bale bed,  
Thunderstruck front end replacement.



**\$43,997**

**2015 Ram 2500**  
6.4 Hemi, Laramie,  
ONLY 7,000 MILES!



**\$37,994**

**2011 Ram 4500**  
Crew Cab, Big Horn, power equipment,  
dually 4x4, 19.5" alloy wheels,  
6.7L I6 Cummins diesel w/exhaust  
brake, 6 spd manual,  
EBY aluminum flatbed



**\$31,997**

**2010 Ram 2500**  
LARAMIE  
Diesel



**HOURS: Mon-Thurs.: 8-8**  
• Fri: 8-8 • Sat: 8-6  
**785-827-9641**

Check out our inventory online at [marshallmotor.com](http://marshallmotor.com) or stop by at 3500 N. 9th, Salina, KS (on the corner of 9th & Water Well Rd.)

## Farmers & Ranchers

### AUCTIONS EVERY MONDAY & THURSDAY

#### Selling Hogs & Cattle every Monday

RECEIPTS FOR THE WEEK TOTALED 4,701 CATTLE & 90 HOGS.  
BUTCHER HOG TOP ON MONDAY WAS \$26.50

STEERS			HEIFERS		
300-400	\$140.00-\$154.00		300-400	\$130.00-\$143.00	
400-500	\$130.00-\$154.00		400-500	\$118.00-\$139.00	
500-600	\$121.00-\$142.50		500-600	\$116.00-\$132.00	
600-700	\$118.00-\$131.00		600-700	\$112.00-\$128.75	
700-800	\$121.00-\$132.25		700-800	\$110.00-\$125.50	
800-900	\$120.00-\$133.75		800-900	\$103.00-\$121.50	
900-1000	\$111.00-\$126.00		900-1,000	\$105.00-\$115.00	
RESULTS FROM TUESDAY, OCT. 25 CALF SALE					
STEERS			HEIFERS		
2 blk	McPherson	380@154.00	2 blk	McPherson	365@139.00
6 blk	Ellsworth	390@154.00	5 blk	McPherson	415@134.00
18 blk	Ellsworth	444@154.00	6 blk	Longford	433@134.00
12 char	Ada	429@153.50	16 blk	Lindsborg	417@134.00
2 blk	Kanopolis	378@152.00	1 bfw	Galva	430@127.00
1 blk	Ellsworth	330@151.00	25 blk	Randolph	763@127.00
7 blk	Brookville	413@150.00	26 mix	Lindsborg	481@126.50
1 bfw	Ellsworth	385@149.00	44 blk	Durham	759@125.50
7 mix	Sylvan Grove	399@148.50	5 blk	Galva	670@125.50
1 bfw	Chase	410@147.00	70 mix	Salina	723@125.25
2 blk	Kanopolis	443@147.00	1 blk	Culver	505@125.00
2 blk	Ellsworth	468@145.00	9 blk	Assaria	765@124.50
1 bfw	Clay Center	400@145.00	46 mix	Hamilton	688@124.50
6 blk	Ellsworth	443@145.00	69 blk	Cedar Point	787@123.00
6 blk	Clay Center	449@144.00	54 mix	Concordia	816@121.50
11 blk	Sylvan Grove	466@144.00	4 blk	Durham	659@121.00
9 blk	Ellsworth	450@143.50	28 blk	Hamilton	638@121.00
2 blk	Lorraine	473@143.00	5 blk	Galva	732@119.00
1 blk	Ellsworth	375@143.00	64 mix	Whitewater	805@118.75
30 blk	Geneseo	502@142.50	26 mix	Hamilton	781@118.50
29 mix	Ellsworth	496@142.00	4 blk	Dorrance	743@118.00
16 mix	Lorraine	499@141.50	8 blk	Cedar Point	657@117.00
12 blk	Geneseo	465@141.25	8 blk	McPherson	831@116.00
28 char	Ada	504@140.00	5 blk	Kanopolis	891@115.00
6 blk	McPherson	515@136.50	9 blk	Kanopolis	917@115.00
20 blk	Brookville	523@136.50	9 mix	Tampa	804@114.00
39 blk	Ellsworth	542@135.50	68 blk	Whitewater	874@113.75
5 mix	Galva	503@135.00	2 blk	Canton	810@113.00
13 blk	Geneseo	558@135.00	1 bfw	Assaria	915@112.00
7 bfw	Beverly	587@135.00	15 mix	Randolph	1059@101.00
19 mix	Lorraine	549@134.00	BULLS		
20 blk	Galva	539@134.00	1 blk	Abilene	2070@80.00
13 blk	Ellinwood	553@133.00	1 blk	Concordia	1670@77.00
31 char	Ada	592@133.00	CALVES		
1 blk	Ellsworth	515@132.00	1 blk	Salina	170@400.00
2 blk	Little River	530@132.00			
48 blk	Geneseo	583@131.75			
2 blk	Minneapolis	515@131.00			
32 blk	Ellsworth	590@130.00			
18 blk	Ellsworth	588@129.75			
22 blk	Minneapolis	626@129.50			
77 blk	Ellsworth	623@128.50			
19 blk	Ellsworth	631@128.25			
8 blk	Little River	615@127.00			
15 blk	Minneapolis	637@127.00			
10 blk	Ellsworth	645@126.50			
41 blk	Brookville	608@126.50			
16 mix	Alma	608@125.50			
14 blk	Ellinwood	623@125.00			
20 blk	Ellsworth	670@124.50			
7 mix	Beverly	648@124.50			
5 char	Lorraine	630@124.00			
21 mix	Galva	614@123.00			
4 blk	Beloit	650@123.00			
10 blk	Sylvan Grove	632@123.00			
21 blk	Brookville	674@121.50			
20 blk	Ellsworth	710@121.50			
34 blk	Minneapolis	720@121.00			
29 blk	Little River	740@118.00			
6 mix	Alma	726@116.00			
3 blk	Murdock	755@115.50			
10 blk	Clifton	701@114.00			
2 blk	Canton	793@114.00			
2 blk	Sylvan Grove	738@114.00			
13 blk	Minneapolis	790@112.00			
HEIFERS					

**IN STOCK TODAY:** • Heavy Duty Round Bale Feeders  
• 6'8" X 24' GOOSENECK STOCK TRAILER METAL TOP  
• 6'8" X 24' GOOSENECK STOCK TRAILER • 6'8" X 24' GR Stock Trailer Metal Top  
• 6'8" X 24' GR Stock Trailer Metal Top • 6'8" X 20' GOOSENECK STOCK TRAILER 3/4 TOP

For information or estimates, contact:

**Mike Samples, Sale Mgr., Cell Phone 785-826-7884**

**Kyle Elwood, Asst. Sale Mgr., Cell Phone 785-493-2901**

Jim Crowther  
785-254-7385  
Roxbury, KS

Lisa Long  
620-553-2351  
Ellsworth, KS

Cody Schafer  
620-381-1050  
Durham, KS

Kenny Briscoe  
785-658-7386  
Lincoln, KS

Kevin Henke  
H: 785-729-3473, C: 785-565-3525  
Agenda, KS

Austin Rathbun  
785-531-0042  
Ellsworth, KS

**Cattle Sale Broadcast Live on [www.cattleusa.com](http://www.cattleusa.com)**

1150 KSAL, Salina 6:45 AM - MON-FRI \*\*\*\*\* 880 KRVN 8:40 AM - WED-THURS. \*\*\*\*\*550AM KFRM - 8:00 am, Wed.-Thurs.

## Livestock Commission Co., Inc. Salina, KANSAS

### SALE BARN PHONE: 785-825-0211

#### MONDAY — HOGS & CATTLE

Hogs sell at 10:30 a.m. Cattle at 12:00 Noon. Selling calves and yearlings first, followed by Packer cows and bulls.

#### THURSDAY — CATTLE ONLY

Selling starts at 10:00 a.m. Consign your cattle as early as possible so we can get them highly advertised.

#### — AUCTIONEERS —

**KYLE ELWOOD, ANDREW SYLVESTER & GARREN WALROD**

For a complete list of cattle for all sales check out our website [www.fandrive.com](http://www.fandrive.com)

63 mix	Beloit	988@114.25
3 mix	Assaria	930@113.50
63 blk	Beloit	1004@112.00
HEIFERS		
2 blk	McPherson	365@139.00
5 blk	McPherson	415@134.00
6 blk	Longford	433@134.00
16 blk	Lindsborg	417@134.00
120 blk	Gypsum	691@130.85
3 red	Hillsboro	435@130.00
19 blk	Randolph	674@128.75
1 bfw	Galva	430@127.00
25 blk	Randolph	763@127.00
26 mix	Lindsborg	481@126.50
44 blk	Durham	759@125.50
5 blk	Galva	670@125.50
70 mix	Salina	723@125.25
1 blk	Culver	505@125.00
9 blk	Assaria	765@124.50
46 mix	Hamilton	688@124.50
69 blk	Cedar Point	787@123.00
54 mix	Concordia	816@121.50
4 blk	Durham	659@121.00
28 blk	Hamilton	638@121.00
5 blk	Galva	732@119.00
64 mix	Whitewater	805@118.75
26 mix	Hamilton	781@118.50
4 blk	Dorrance	743@118.00
8 blk	Cedar Point	657@117.00
8 blk	McPherson	831@116.00
5 blk	Kanopolis	891@115.00
9 blk	Kanopolis	917@115.00
9 mix	Tampa	804@114.00
68 blk	Whitewater	874@113.75
2 blk	Canton	810@113.00
1 bfw	Assaria	915@112.00
15 mix	Randolph	1059@101.00
BULLS		
1 blk	Abilene	2070@80.00
1 blk	Concordia	1670@77.00
CALVES		
1 blk	Salina	170@400.00

#### SPECIAL COW SALES SCHEDULE

All Tuesday Sales start @ 12 Noon

Tuesday, Nov. 15, 2016  
Tuesday, Dec. 20, 2016  
Tuesday, Jan. 17, 2017  
Tuesday, Feb. 21, 2017  
Tuesday, Mar. 21, 2017  
Tuesday, April 18, 2017  
Tuesday, May 2, 2017

#### SPECIAL CALF SALES

All Tuesday Sales start @ 12 Noon

Tuesday, Nov. 8, 2016  
**WEANED/VACCINATED SALES**  
Tuesday, Dec. 6, 2016  
Tuesday, Jan. 3, 2017  
Tuesday, Feb. 7, 2017

1 blk	Miltonvale	155@325.00
COWS		
1 blk	Hillsboro	1620@62.00
1 bfw	Abilene	1590@61.50
1 blk	Hillsboro	1465@60.50
1 blk	Wichita	1390@59.00
1 blk	Lindsborg	1435@58.50
1 blk	Salina	1400@58.50
1 blk	Lindsborg	1535@58.00
1 red	Wichita	1385@58.00
1 blk	Salina	1365@57.00
1 red	Delphos	1410@56.00
1blk	Salina	1285@56.00
SOWS		
4 wht	Abilene	636@24.00
3 wht	Abilene	608@24.00
1 wht	Abilene	520@23.50
4 wht	Abilene	546@22.50
HOGS		
1 hamp	Netawaka	265@26.50
15 mix	Tescott	266@25.85
6 wht	Tescott	272@25.25

#### EARLY CONSIGNMENTS FOR THURSDAY, NOVEMBER 3:

58 blk/bwf str & hfrs, 450-650 lbs., home raised, no implants; 12 wf str & hfrs, 600 lbs.; 25 strs, 850-900 lbs., off grass; 50 str & hfrs, 500-600 lbs., fall vacc.; 15 blk Angus hfrs, 500-600 lbs.; 62 str & hfrs, 850 lbs.; 60 mostly blk strs, 850 lbs., off grass. PLUS MORE BY SALE TIME!

#### EARLY CONSIGNMENTS FOR TUESDAY, NOVEMBER 8 CALF SALE:

50 blk/bwf str & hfrs, 300-550 lbs.; 200 blk/Char str & hfrs, 550-600 lbs., Bar S sired; 21 str & hfrs, 600-650 lbs., Green Garden sired; 65 str & hfrs, 500-650 lbs.; 14 strs, 450-550 lbs.; 400 str & hfrs, 450-600 lbs.; 70 blk str & hfrs, 500-600 lbs.; 70 blk str & hfrs, 500-700 lbs.; 32 blk/bwf str & hfrs, 450-650 lbs., homeraised, no implants; 58 str & hfrs, 550-600 lbs., 2 rnds fall vacc.; 65 blk str & hfrs, 450-650 lbs., homeraised; 75 str & hfrs, 500-600 lbs., fall vacc.; 400 blk str & hfrs, 500-650 lbs.; 194 blk/bwf str & hfrs, 550-650 lbs. PLUS MORE BY SALE TIME!

#### EARLY CONSIGNMENTS FOR TUESDAY, NOVEMBER 15 COW SALE:

**BULLS:** 2 Horned Hereford bulls, 18 mo. old, good EPDs, semen checked; 6 yr old Angus bull Rocking R Angus bull LBW, semen & trich tested. **BRED HEIFERS:** 150 blk hfrs, OCHV'd, bred Angus, Montana origin, calve Jan. 25; 29 Red Angus hfrs, pelvic measured, bred to LBW Angus bulls, OCHV'd, start Feb. 14 for 60 days; 14 blk Angus hfrs, pelvic measured, bred to LBW Angus bulls, start Feb. 14 for 60 days; 65 Angus hfrs; 61 blk hfrs bred to registered blk Angus sons of Ten X w/neg BW EPD, start Feb. 2; 80 Angus & Angus/CharX hfrs, AI bred to ABS Angus/Angus clean up Feb. calves.; **HEIFER PAIRS:** 40 blk hfr pairs, AI sired calves, 30+ days old, worked. **COWS:** 100 blk cows, 3-5 yrs, spring bred to blk bulls; 65 blk cows, 3-5 yrs, spring bred, bred/bred to blk bulls; 50 blk/red cows, 3-5 yrs, spring bred/bred blk & Char bulls; 40 blk/bwf cows, 4-6 yrs; 12 Red Angus cows, 3 to running age, bred to registered Red Angus bulls; 85 blk/bwf/Red Angus 3-5 yrs, bred Angus; 50 cows, 3-7 yrs, bred Angus Jan. 15 for 90 days; 100 Angus cows, 3 yrs, bred to Apex Windy 078 sons, March/April calvers; 85 blk/bwf/red cows, 4-6 yrs, bred hrn wf bulls March 1 calvers; 10 bred cows, running age, bred to LBW Angus bulls; 45 blk/bwf cows, 3-6 yrs bred to Mushrush Red Angus March 1 for 60 days, BVD neg, vacc., all raised calf, good disposition; 15 broken mouth cows, spring calvers, bred blk Angus; 200 Angus & Char X cows, 3-8 yrs, bred Angus, March calvers. PLUS MORE BY SALE TIME!

Check our listings each week on our website at [www.fandrive.com](http://www.fandrive.com)



# CLASSIFIEDS

**CLASSIFIED AD DEADLINE IS 10:00 A.M. FRIDAY**

Although complete name, address and phone number need not appear in your ad, we must have this information for our records.

Name: \_\_\_\_\_ Phone #: \_\_\_\_\_

Address: \_\_\_\_\_ City: \_\_\_\_\_ State: \_\_\_\_\_ Zip: \_\_\_\_\_

**WRITE YOUR AD HERE**

**RATES AND DISCOUNTS**
**FIGURE YOUR COST HERE:**

RATE: 65¢ a word.

Number of words: \_\_\_\_\_ @ 65¢ each

Cost for one week: \_\_\_\_\_

Multiply one-week cost times number of weeks you want ad to run.

Run ad \_\_\_\_\_ consecutive weeks.

Category: \_\_\_\_\_

Cost for \_\_\_\_\_ weeks: \_\_\_\_\_

**DISCOUNTS:** (with cash or credit card orders only)  
deduct 10% if ad runs 2 or 3 weeks;  
deduct 25% if ad runs 4 weeks.

Less discounts: \_\_\_\_\_

**TOTAL: \$** \_\_\_\_\_

**PAY WITH (PLEASE CIRCLE ONE):**

**CHECK MASTERCARD VISA DISCOVER**

Card No. \_\_\_\_\_ Exp. Date \_\_\_\_\_

V-Code \_\_\_\_\_ (required) last 3 digits (see sample: 567) located on the back of your credit card on the signature panel.

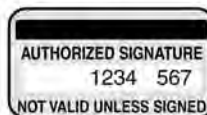

Signature: \_\_\_\_\_

**CLASSIFICATIONS**

CATTLE	GOAT
SWINE	SHEEP
HORSES	POULTRY
FERTILIZER	TRAILERS
FEED & SEED	MACHINERY
AUTOMOTIVE	EMPLOYMENT
REAL ESTATE	ANTIQUES
SERVICES	PASTURE
IRRIGATION	WANTED
HARVESTING	PETS
LIVESTOCK OTHER	
LIVESTOCK EQUIPMENT	
BUILDINGS-BUILDING MATERIALS	
BINS - DRYERS - VACS	
MOBILE HOMES	
SPRAY EQUIPMENT	
BUSINESS OPPORTUNITIES	
WELDING	
MISCELLANEOUS	

**REMINDERS**

- Please notify us of any errors at once. We cannot be responsible beyond the first insertion.
- **NO REFUNDS!**
- **BY PHONE:** Ads not accompanied by payment have \$1.00 billing charge added, and discounts are not available.

**GRASS & GRAIN**

**Four Ways To Place Your Ad**  
**CALL: 877-537-3816 TOLL-FREE OR 785-539-7558**  
**MAIL TO: AG PRESS, Box 1009, Manhattan, Kansas 66505**  
**FAX: 785-539-2679 ONLINE: www.grassandgrain.com**

**CATTLE**

**HIGH TECH BEEF**

**Cow Herd Reduction & Top 20 Bull Sale**

Saturday, November 12  
1:00 pm • At the Ranch near Leonardville, Kansas

Selling Close to 100 Head of Reg. Angus and SimAngus

Michael & Sharon Lindell  
(785) 293-5282  
www.hightechbeef.com

**HEREFORD BULLS**

Good bulls with balanced EPD's, practical development, good disposition & eye appeal.

**Oleen Cattle Co.**  
Falun, KS

GLENN 785-668-2368 CHUCK 785-668-2454

PUREBRED "INFOCUS" Angus Bull: 785-313-0449

**CATTLE**

**Wheatland Farms**  
Yearling-18 months old  
Registered Angus Bulls  
AI Sired, Good Disposition  
Larry Shippy  
Hope, Kansas

785-479-2103 785-479-1725



**Registered Angus Bulls**

18-20 month old  
Sired by Sitz Wisdom, Sitz Dash, Connealy Consensus.  
Performance Tested, Fertility Tested. Free Delivery.  
Guaranteed Sight Unseen Purchases. Excellent Disposition. **Priced to sell!**  
Holton, Ks  
785-845-5272 or  
785-817-2328  
rinkescattle@gmail.com

Production Sales held on the Second Saturday in October & February

**BLACK HEREFORDS**

**J&N Ranch**  
(913) 727-6446  
Leavenworth, Kansas  
www.blackhereford.com

**CATTLE**

**HOFMANN**  
*Simmental*  
**F A R M S**

Red & Black Simmental / SimAngus bulls for fall breeding available now - select group

**BUY YOUR WAY BULL SALE**  
February 25 - March 4, 2017  
selling 60 Simmental & SimAngus bulls

**Rodney & Kim Hofmann**  
Clay Center, Kansas  
785-944-3674  
www.honestbulls.com  
hsfcows@gmail.com



SENECA, KS

**Private Treaty**  
24 Month Angus Bulls  
AI Sired  
Registered  
Calving Ease  
Gentle Disposition  
David J. & Doris,  
Dustin & Darren Ronnebaums  
785-294-1511

**REGISTERED VIRGIN ANGUS**  
Bred heifers. AI'd Angus. Cleaned up calving ease SimAngus. Due Feb 1st for 45 days. OCV, Pelvic Measured, PI tested, "Sunflower Supreme Certified" \$1800 - \$2000 call Mark 785-258-0173

**HOMOZYGOUS BLACK & Homozygous polled Simmental & SimAngus Bulls** \$2500-\$4000.  
www.hauckcrockcreekranch.com, Jeff: 620-344-0233. Allen, KS

**CATTLE**

**PRIVATE TREATY**

High Performance Angus Bulls For Sale. Sires Represented: SAV Angus Valley, Cole Creek Cedar Ridge, Baldridge Xceed X712, GF32 Right Answer.

Bulls are 18 months old. All bulls have been fertility checked, ultrasounded, and PI tested negative.  
**Haddam KS.**

Heath Allen 785.556.8982  
Bob Allen 785.556.8980  
www.flatironangus.com



**FOR SALE**  
**PRIVATE TREATY**  
18 Month and Yearling Bulls

Calving Ease • Performance Efficient • Docile

Plan to join us  
March 18, 2017  
On Target Bull Sale

Dave Stump  
Blue Rapids, KS  
(785) 556-0124

Visit us at  
SpringhillHerefords.com  
A Gold TPR Breeder

**FOR SALE: 15 HEAD OF 1ST** calf commercial Angus cross fall pairs. DD Angus. Ronnebaums, Seneca, KS. 785-294-1511

**FOR SALE: HEREFORD** bulls horned and polled, ready for service. Fall heifers 4H & FFA spring heifer projects. Davis Herefords, Maple Hill, KS. 785-256-4643 or 785-256-4010

**CATTLE**

**JOEL HARRISON**  
**ESTATE DISPERSAL**  
Sunday, November 20, 2016  
12 PM

**At the Ranch, Enterprise, KS**  
Over 300 head sell  
Including young Registered Pairs and Service age, calving ease Bulls

**Brooke & Jason Woodworth**  
**785-479-2188**

**Brooke's Cell**  
**785-479-0403**  
Larry Shippy  
**785-479-1725**

**COW CAMP RANCH:** black SimAngus Bulls 30 head of Coming 2 yr old Bulls Available Private Treaty at the Ranch, Lost Springs, KS Complete BSE, Big, stout and ready to turn out, also available, registered SimAngus bred heifers (A.I.). Kent (785) 466-6475 or Nolan (785) 466-1129.

**IRVINE RANCH**  
**ANNUAL**  
**PRODUCTION SALE**  
**NOVEMBER 5th 2016**  
At the Ranch!

**Selling:**  
• 50 Simmental & SimAngus Bulls  
DNA Enhanced EPD's.  
Calving Ease & Performance!

• 20 Fall Cow/ Calf Pairs  
Registered, Young, and Productive

• 10 Spring Bred ET Heifers  
www.IrvineRanchGenetics.com  
Manhattan, KS

See our ad on page 15

**(785) 313-7473**  
johngrivine@sbcglobal.net

**CATTLE**

**High Quality**  
**Red Angus and Charolais**  
**Bulls in Quantity!**

**Red Angus Sired by:**  
Boxed Beef, Epic, Conqueror, Sovereign, Anticipation, Mission Statement

**Charolais Sired by:**  
All State, Bluegrass, Assertion  
• An Extremely nice set of Fall 18-month old & Spring Yearling bulls available.

• All scanned by ultrasound, fertility tested and guaranteed.  
• EPD Balance and High Quality

• **Your Private Treaty Headquarters.** No Pressure, No Politics. All cattle are sold by private treaty. Come visit us and together, we'll invest the time necessary to identify the right bull(s) that best fit your program and help you gain a competitive edge.

• Short on Time - We have extensive experience with sight unseen purchases. Satisfaction guaranteed.  
• Videos, data, and catalog available on our website  
• Contact us for a catalog

**Contact our Partner in Progress.**

We look forward to the opportunity to EARN your business.

**HARMS**  
**PLAINVIEW**  
**RANCH**

Mark & Kim Harms  
2528 250th Street  
Lincolnville, KS 66858  
Email: hprbulls@tctelco.net  
www.HARMSRANCH.com

**620-924-5544**  
**Mark Cell:**  
**620-382-6388**

THE LAND OF **John C. Oswald & Sons**  
GELBVIEH - BALANCERS

**SPRING BULLS**  
*Fall 2015 ET Red Angus Bulls & Heifers, Spring Cow/Calf Pairs*

620-960-1189 • Ken Schmucker  
Hutchinson, KS



## GRASS & GRAIN DIRECTORY

### AUCTIONEERS

**JEFF RUCKERT,**  
OWNER/  
BROKER/AUCTIONEER  
2708 Amherst Ave  
Manhattan, KS  
785-565-8293



www.ruckertauctions.com

**RUCKERT**  
REALTY & AUCTION

Homes, Farms, Ranches, Land,  
Auctions & Recreational Property



**ARMSBID.COM**  
Kull's Old Town  
Station invites con-  
signments for our  
Spring, Summer &  
Fall Auctions. If you  
have 1 or 1,000, we'd like to talk to you.

We will also buy collections or  
individual guns.

Dan@ArmsBid.com or  
785-862-8800 • 800-466-5516  
Topeka, Kansas

**purple wave**  
AUCTION

**BUY & SELL**

Ag Equipment  
Const. Equipment  
& Vehicles

1.866.608.9283

purplewave.com



**STEVE MURRAY**  
Broker/Auctioneer  
MURRAY  
AUCTION & REALTY  
Real Estate - Farm - Household  
785-556-4354  
murrayrealtyandauction@yahoo.com  
www.murrayauctionandrealty.com

**GENE FRANCIS**  
& ASSOCIATES  
REAL ESTATE BROKERS & AUCTIONEERS

Serving all 105 Kansas  
counties with more than  
30 years of experience.

Offices located in Wichita,  
Manhattan & Anthony.  
Call us today at  
316.524.8345

www.genefrancis.com

A bid above the rest!



**GANNON REAL ESTATE**  
& AUCTIONS  
VERN GANNON, CAI  
Broker/Auctioneer  
Manhattan, Kansas 66502  
785-539-2316  
785-537-9003  
www.gannonauctions.com  
The Experienced Sound In Selling

**Cattleman's**  
Livestock Services  
FALL AND WINTER  
employment on livestock  
operation. Can supply  
truck with cake feeder  
&/or a fencing truck. Am  
retiring from owning fencing  
business. Wages are  
flexible, as on social secu-  
rity. Lifetime of experi-  
ence. Provide references.  
785-214-9532

**HOOVER**  
TARP SALES



Abilene, KS  
Toll Free 1-800-536-2348

"DON'T GO TARPLESS"  
www.hoovertarpsales.com

**GENUINE SHUR-LOK**  
NOTHING LESS!  
FAX 785-598-2282

Custom Manure  
Hauling & Spreading  
Big to Small Jobs!  
**Chore-Boyz Services**  
913-636-1099

**HALDEMAN**  
WELL DRILLING &  
PUMP SERVICE



**WELL DRILLING**  
COMPLETE PUMP SERVICE  
SOLAR PUMPS  
MANHATTAN, KS  
Day or Night  
785-539-9295

Blue Valley Drilling, Inc.  
Water Well Drilling & Service  
Family Business Over 70 Years!  
CONTACT ERIC STRADER  
785-363-7353



**D. ROCHE**  
FENCING  
INC.

QUALITY BUILT FENCES  
DON ROCHE  
785-292-4271  
FRANKFORT, KS

### CATTLE



**Available Now: 20**  
**ANGUS BULLS**

For Sale by Private Treaty

Featured Sires:  
Hoover Dam, Emblazon,  
Regis, Thunder, Dash &  
Plainsman

Performance Tested; Fertility  
Tested; Fully Guaranteed;  
Free Delivery in KS & NE.  
Volume Discounts  
See Price List at:  
www.WolfCreekAngus.com  
LURAY, KANSAS  
785-698-2225

### CATTLE



**Fall Edition Bull Sale**  
Sunday, Nov. 6, 1:30pm  
Manhattan Commission Co.  
Manhattan, KS

Selling Athletic Fall Yearling  
and seasoned 18 month old  
bulls ready for service.  
• First Breeding Season  
Guarantee  
• Free Local Delivery  
• Winter Care Available  
See Oct. 25 Grass & Grain  
page 8 for Color ad! or Call  
785-565-3246  
785-564-1744  
www.clinecattlecompany.com  
Email: clinecattle@yahoo.com

### CATTLE



**REGISTERED**  
**ANGUS BULLS**

Sired by:

Confidence, Absolute, Com-  
plement, Thunder, Cedar  
Ridge, Bismarck, Hoover  
Dam, Full Power, Substantial  
and many others.

• Quality in Volume - over 250  
bulls sell.  
• Generations of problem-solv-  
ing genetics. Low to moderate  
birth weight bulls by high accu-  
racy sires and out of dams  
backed by several generations  
of low BW, excellent growth  
and positive carcass traits.

• Your Private Treaty Head-  
quarters. All cattle sold private  
treaty - no pressure, no polit-  
ics. Come visit us and to-  
gether, we'll invest the time  
necessary to identify the right  
bulls(s) that best fit your pro-  
gram and help you gain a  
competitive edge. No pres-  
sure, no rush decisions.

• Each bull fertility tested and  
guaranteed.

• All bulls scanned by ultra-  
sound and negative for  
PI-BVD.

• Short on Time- We have ex-  
tensive experience with sight  
unseen purchases. Satisfac-  
tion Guaranteed!

• Your Partner in Progress -  
We want the opportunity to  
earn your business.

• Fall 18 month old bulls and  
Spring Yearlings bred and  
managed for dependable per-  
formance with reasonable  
EPDs. Fed to be fit — not  
fat.

• Videos, Data and Catalog  
available on our website

• Contact us for a catalog

**HARMS**  
**PLAINVIEW**  
**RANCH**

Mark & Kim Harms  
2528 250th Street  
Lincolnville, KS 66858  
Email: hprbulls@tctelco.net  
www.HARMSRANCH.com

620-924-5544  
Mark Cell:  
620-382-6388

### BUSS ANGUS

ANGUS BULLS  
14 to 20 Months Old

Featured Sires:

Thunder  
Consensus 7229  
Angus Valley  
Pioneer  
Wisdom  
Thunderbird  
Net Worth  
Image Maker

SEVERAL SETS OF FULL  
BROTHERS

**GARY BUSS**  
Leonardville, Kansas  
785-293-4444 • 785-410-3006

**POLLED**  
**HEREFORD**  
**BULLS**

Bred for Complete  
Performance

• Growth  
• Muscle  
• Maternal  
• Disposition

Fertility Tested and  
Guaranteed

### DETTKE FARMS

Call:  
**ANDY DETTKE**  
Marysville, KS  
785-268-0423  
785-562-6257 Brian

### ANGUS FALL BULLS

75 head to Select From  
Plus 8 Sim-Angus Bulls  
20 coming 2-year old bulls

This is a stout set of  
artificially sired bulls, with  
over 20 years of artificially  
breeding.

Semen checked, ready to go

**Nelson Angus**

Raymond & Alan & Mike  
Nelson  
Riley, KS  
785-485-2378

Alan's Cell: 785-770-7054  
Mike's Cell: 785-565-8477

### CATTLE



**ANGUS BULLS**

20 months old  
Calving Ease  
Growth & Carcass  
Fertility Tested, DNA tested  
Ready to go to work!

**Blythe Angus**

White City, KS  
Debbie Lyons-Blythe &  
Duane Blythe  
785-349-2652  
785-466-1338

**Bull & Female Sale**  
**SAT., MARCH 11**  
**2017**



**MILL BRAE**  
**RANCH**

Mark Nikkel, Managing Partner  
Maple Hill, Kansas  
785-256-4327  
millbraeranch.com



**For Sale:**  
**18 Month Old**  
**Angus Bulls**

Performance Data Available  
Good Maternal Traits  
Fertility Tested  
Continuously raising Angus  
cattle for 67 years.

**Vering Angus**

Greg Vering  
Marysville, KS  
785-562-7164 Cell  
785-562-3988 Home



"Proven Flexibility"  
**Annual Bull Sale**  
Saturday, Nov. 19

NW of Eureka, KS  
Selling 140 yrlg and  
coming 2 year olds

Call for a catalog today!  
mattperrier@dalebanks.com

620-583-4305  
tperrier@dalebanks.com  
620-583-6956  
www.dalebanks.com

**ANGUS &**  
**SIMMENTAL-ANGUS**  
**BULLS**

• Priced for the Commercial  
Cattleman  
• Yearlings & 2 yr. olds with  
calving ease & growth  
• Excellent Selection with Vol-  
ume Discounts  
• Performance Data Available  
• Good Maternal Traits

**Huninghake Angus**

FRANKFORT, KS  
Leo Huninghake  
785-292-4537  
Cell: 785-556-2648

**EXCELLENT COUNTY FAIR**  
shorthorn steer and heifer pro-  
jects for 4-H and FFA. 10 steers/  
heifers available including 1  
Blue-Roan steer and 1 Blue  
heifer. Papers available. Please  
call w/questions. Rick Blush  
Topeka, KS. H:785-286-3040.  
C:785-554-8990

### CATTLE

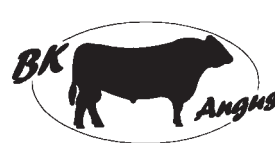

**ANGUS BULLS**

Calving Ease  
Virgin 2 year old bulls  
BRIAN KOSTER  
TESCOTT, KS  
785-488-6219 • 785-392-0345  
bkangus.wix.com/bull



**ANGUS-CROSS**  
**BRED HEIFERS**

Heifers AI bred for Feb. 2017

Bred to Connealy Comrade  
1385

Pasture exposed for 65 days  
to registered Blythe Angus  
Bulls: low birth weight & calv-  
ing ease.

Heifers are:

• Vaccinated  
• Pelvic measured  
• GeneMax Scored  
• Calm Disposition  
• Black & BWF

**Blythe Angus**  
**Heifer**

**Development**

White City, KS  
Debbie Lyons-Blythe &  
Duane Blythe  
785-349-2652  
785-466-1883  
785-466-1338

**POLLED**  
**HEREFORD**  
**BULLS**

Calving ease, good growth  
and disposition  
Semen tested, poured,  
vaccinated

Delivery available  
785-865-3444  
**Flory**  
**Polled Herefords**

### SWINE

**H A R M S**  
 **H A M P S**

**TOP QUALITY HAMP BOARS**  
AVAILABLE YEAR AROUND  
**GALEN & ROBERTA HARMS**  
Whitewater, KS 316-799-2382

**FOR SALE: DIRT RAISED**  
hogs, butcher or feeders. Call  
Mary Leigh Myers,  
785-580-7702

**BOARS & GILTS**  
Duroc, Chester, York, Hamp,  
& Hamp/Duroc

**SLEICHTER**  
**DUROC FARM**  
ABILENE, KS  
785-263-1898 785-479-6694

### SWINE

**EQUIPMENT**

Buildings — Ventilation  
Flooring — Feeders  
Waterers — Heaters  
Crates — Nursery Equip.

**K & N**  
**Swine Systems**

RICK HENRY  
785-336-2130  
SENECA, KANSAS

### HORSES

**BUYER FOR all types of**  
horses. 785-556-5740.

### GOAT

**REGISTERED ALPINE DAIRY**  
goats for milk and show.  
620-767-5728, www.PuckettsAl-  
pines.com, PuckettsAlpine@tcte  
lco.net

### LIVESTOCK EQUIPMENT



Making tough jobs easier

**Luco Mfg. Co**  
**1-888-816-6707**  
www.lucoinc.com

Hydraulic Chutes • Working  
Circles • Cake Feeders  
• Continuous Fencing  
• Panels & Gates  
• Hog Haven affordable  
portable confinement units  
Go to [www.lucoinc.com](http://www.lucoinc.com)  
PO Box 385  
Strong City, Kansas 66869



THE ORIGINAL



Hay Conserver Feeder  
The only 1 that is tested  
and Proven. The only 1  
with an Unconditional  
Guarantee  
**1-855-880-7964**  
[gobobks.com](http://gobobks.com)

**HOLD 'EM Fence Company-**  
barbed wire, welded continuous  
fence, pipe, custom tubs, gates,  
alleyways. Cell 785-313-4552,  
<http://www.holdemfence.com/>



Portable Corral 785-263-3436  
Introducing our New Rawhide  
Processor by John McDonald  
Used Rawhides for sale also  
www.  
[rawhideportablecorral.com](http://rawhideportablecorral.com)

**MIRAFOUNT 2 WHOLE HOG**  
waters, suitable for hogs, sheep  
or goats. 785-282-0396

**TRACTOR TIRE**  
**FEEDBUNKS**  
**FOR SALE**

Contact Corey @  
**800-295-3345**

### PIPE & RODS

2 7/8" ..... \$35  
2 3/8" ..... \$30  
2 3/8" Lined..... \$25  
Cut posts also available  
We have 4, 5, & 7" pipe  
Good Clean Pipe!

Rods and Delivery available  
Ask about free Semi load  
delivery or pick up @ our  
yard. **DEALERS WANTED!**  
Ask About Our Summer  
Specials!  
**4S Land & Cattle Co. LLC**  
Call: 785-452-8498

• 4.5" Pipe \$4.00  
• 2 7/8" Pipe \$1.90  
• 2 3/8" Pipe \$0.95  
• 1 1/4" Pipe \$0.45

**WILL DELIVER**  
**POST CUT TO ORDER**  
**Quantity Discount**  
**Ray's Pipe**  
Council Grove, Kansas  
**620-767-2907**

**WANTED: USED 12 VOLT** cat-  
tle fogger. 785-388-2442

### FEED & SEED

**2016 BROME AND PRAIRIE**  
hay for sale, 5'6" net wrapped  
bales, Topeka, KS.  
785-218-9622

**CERTIFIED EVEREST,** Kan-  
mark, and 1863. Duane John-  
son, Lindsborg. 785-227-2519

**BROME SEED, CLEAN 50lb.**  
bags. 785-449-7200



## FEED & SEED

**BROME PRAIRIE HAY.** SMALL square, big square and big rounds, good quality. Emporia, KS. 620-794-4293

**FEYH FARM SEED CO**  
**ALMA, KANSAS**  
Native Grass Seed  
Wildflowers  
Smooth Brome Grass  
Erosion Control Products  
Cover Crop Seed  
**866-765-3415**  
nativeseed@feyhfarmseed.com  
www.FeyhFarmSeed.com

## Cattle & Hog Feed

**WHEAT MIDDINGS**  
Pelletized, crude protein not less than 14.5%. Call for pricing.

**WESTERN STAR MILL**  
Division of ADM - Salina, KS  
1-800-649-1541 (Kansas)

**TRITICALE SEED. \$6.99/** bushel, excellent quality, 59 test weight, 98% germination. Call Brock Baker, 316-249-1907

**LET US LOAD ON YOUR** Truck twine tied, high quality small square bales of prairie hay from good barns. 20 miles from Emporia. Davies Farm, Reading, Ks. 620-341-2100

**ALFALFA, BROME & PRAIRIE** Hay in small square and 5x5 round. Emporia, KS. Call 620-208-3217

**STAR SEED INC.**  
**Certified Seed Wheat**  
Agripro  
WestBred  
Agseco  
KWA  
Oklahoma Genetics  
Native Grass and Pollinators  
Turf Grass  
Outstanding Alfalfa Line-up  
**1-800-782-7311**  
www.gostarseed.com

**DAMAGED GRAIN WANTED STATEWIDE**  
We buy damaged grain, any condition-wet or dry-including damaged silo corn.  
**TOP DOLLAR!**  
We have vacs and trucks.  
**CALL HEIDI OR GARTON**  
**NORTHERN AG SERVICE, INC.**  
**800-205-5751**

**CLEAN 2016 BROME HAY** put up with no rain and net wrapped. \$70/ ton. Please call Jeff at 620-282-8364 for more information.

**BROME HAY, UP EARLY,** \$16/ton. 785-449-7200

**2016 AND 2015 PRAIRIE** hay. Auburn, KS area. Net wrapped, put up in July, excellent quality. 2016 \$30.00/ bale, 2015 \$25.00/ bale. Approx. wt. 1,100lbs./bale. 785-221-5517.

## WANTED DAMAGED GRAIN

We pay top dollar for damaged grain. Trucks and vac's available. Immediate response anywhere.

**Pruess Elevator, Inc**  
**1-800-828-6642**

**2015 LARGE MILO STUB** Bales, large tied. Tested 2015 low nitrates. \$10 each. 100+ call 785-820-7116.

**NET WRAPPED ROUND** bales, straw, prairie hay and alfalfa (1, 2, 4th cuttings); Small square alfalfa (1, 4th cuttings) Call 785-820-7116 for more information.

**CLEANED RYE SEED** FOR sale, germination tested, bulk and mini- bulk quantities. Emporia, KS. 620-794-4293

**BIG ROUND BALES** OF Brome hay, net wrapped. Baled 6/10/16. Olpe, KS. 620-475-3586 please call evenings.

## PASTURE

**NEED PASTURE FOR 2017** and beyond, lifetime cow/calf producer. Burger Farms. Salina, KS. 785-823-3821

**PREMIUM RANGE CUBES** now available, competitive pricing. Call Brock Baker, 316-249-1907

## AUTOMOTIVE

**MIDWAY MOTORS**  
**SUPER CENTER**  
McPherson, KS  
Hutchinson, Kansas  
Hillsboro, Kansas

2015 GMC 2500 Sierra Denali, Crew, 4x4, 6.0 gas, loaded, 9k miles  
2012 Chevy Silverado 2500 HD LTZ crew, 4x4, diesel, loaded, 18k miles  
2015 Ford F-250 crew 4x4, Platinum, Diesel, auto, loaded, 29k miles  
2014 Ford F-250 crew 4x4 Lariat, loaded, diesel, auto, like new, 30k miles  
2013 Ford F-150 super crew 4x4, loaded, auto, very clean 36k miles  
2014 Dodge Ram Laramie crew 4x4, loaded, diesel, auto, 33k miles  
**Ask For Kris Hanschu**  
khanschu@midwaymotors.com  
**620-755-2824**

**Chuck Henry Sales**  
Trucks - Trailers  
Containers  
**Solomon, KS**  
785-655-9430  
www.chuckhenrys.com

**NOTICE OF SALE ON OCT.** 31st. 2010 Nissan, VIN #1N4AL2APAN45772, Call Kevin, 785-236-0611

## AUTOMOTIVE



2008 Ford F350, diesel, with Kelly Ryan 5 x 10 feed wagon with scales. \$33,500  
Several Daycabs available  
Feed Mixers and Manure Spreaders  
Kuhn Knight, new & used  
**Belleville, KS**  
**800-536-2293**



**2011 CHEVY 2500 HD Z71**, good condition, new rubber and brakes. \$17,900. 316-708-0888

**1973 FORD F600, 16FT** Knapheide bed, twin cylinder Harsh hoist, 56,616mi. barn stored, \$3500. 316-237-7421

2016 Dodge Challenger  
2016 Hyundai Sonata  
2013 Chevy Cruze  
2013 Dodge Avenger  
2009 Peterbuilt Semi Tractors  
2009 Honda Accord 2D  
2008 Chevy Impala  
2005 Mazda Rx8  
2004 Chevy Tahoe  
2003 Ford Expedition  
2001 Chevy Suburban 4x4  
2005 Chevy Crewcab Diesel 4x4  
2003 Chevy S10 4x4

**B. C. Motors**  
902 E. Trapp  
Herington, KS 67449  
**785-258-2818**

**FOR SALE 1984 IHC 4X4** truck, 1975 GMC 6500 truck, 785-840-8243



**Stock#2522A**  
2012 3500 Crew Cab Dually  
4x4 diesel LT Hydra bed, one owner, 88,000 miles, white.

**Stock#2627A**  
2012 Ram 2500 Reg. Cab 4x4, Gas, 55,000 miles, one owner. Super clean. Red.

**Stock#2682A**  
2014 F-350 Super Cab XL 4x4 Dually Hydra bed, 6.7 diesel, one owner, white.

**Stock#2711A**  
2012 F-350 Super Cab 4x4 Dually Lariat 60" cab to axle, 50,000 miles, LIKE NEW, red, ONE OWNER. 6.2 gas.

**Stock#2711M**  
2013 F-350 4x4 Dually Diesel XL Super Cab - C&M flat bed, White, One owner, CLEAN!

**Stock#2607A**  
2012 Ram 2500 Quad Cab natural gas 4x4 28,000 miles, super-super clean.

**Stock#2713M**  
2012 F-350 XL Cab & Chasis 4x4 Super Cab, 60" cab to axle, 6.7 diesel ONE OWNER, 77,000 miles, Red in color.

**Stock#2257A**  
2013 F-350 XL Crew Cab 4x4 60" cab to axle, 6.7 diesel ONE OWNER 78,000 miles, Dually, white, clean.

**Stock#P886A**  
2008 Dodge Ram 4x4 Quad Cab, 55,000 miles, Bale bed, red.

**Stock#2663A**  
2014 F-350 XL Reg. Cab 4x4 NEW BESSLER BALE BED, 6.7 diesel, super clean, 85,000 miles, ONE OWNER. Red.

**Lewis Ford Lincoln of Dodge City**  
200 Military Dodge City, KS 67801  
Service: (620)-227-3673  
Parts: (620)-227-3673  
Sales: (844)-327-8021

## AUTOMOTIVE

**Myronized Truck Works**  
**Centralia, Kansas**  
**785-857-3581**  
• Drop N Lock gooseneck ball  
• Economy Mfg. flatbeds  
• Luverne grill guards, nerf tubes, mud flaps, side steps

## REAL ESTATE

**LAND FOR SALE:**  
**262nd & J4 Rd**  
**Circleville, KS**  
**218 AC m/l**

Established grass acreage with tillable soils underneath. Cool season grasses. 8.5 acre watershed

**Roger Hower**  
**785-364-8272**  
rhower@kellermanrealestate.com

**80 ACRES M/L**  
Pasture/Hayground with Pond, Some Cross Fencing  
1/2 mile off Hwy 16 W. of Holton  
**Diana Rieschick**  
**785-364-0267**  
diana@kellermanrealestate.com

**441.59 Acres m/l surveyed** acres in one tract (with 3 legal descriptions) NW of Mayetta, KS.

Approximately 330 ac terraced tillable, 40 ac alfalfa, 30 ac waterways, 5 ponds. Current crop and hunting leases in effect for 2016 season. Possession of Ag Land shall be Nov. 1, 2016. Hunting lease expires December 31, 2016. Seller is retaining all lease payments.  
**Sellers: Adam, Jr. and Ruthann Nocktonick Trust**  
**Roger Hower**  
**785-364-8272**  
rhower@kellermanrealestate.com

**56 AC m/l of good brome grass.**

Very clean diversifiable land, would also make great building site and was previously terraced and broke out in the past. Seller has averaged 100-120 ton of hay since ownership. East of Hoyt on 118th road, north on 'U' road 1/16th of a mile, east side. Nice piece of hayground.

**Craig Fox**  
**785-305-1636**  
cfox@kellermanrealestate.com

**Kellerman Real Estate**  
101 West 4th Holton, KS  
**785-364-2000**

## REAL ESTATE

**68 A SECLUDED PARCEL** of Flint Hills in Morris Co., KS. Spring fed creek, timber, and rolling grassland with well, septic, electricity, and fiber optic connection to home site. Includes a 5 to 10 acre park like home site with picnic area, tree swing, and fire pits. Pack a picnic and come see for yourselves. Price 150K. kbaird49@windstream.net, 402 469 4769/ 402 463 2812.

## FOR RENT OAKHILL ESTATES

**LUXURY**  
**1 & 2 BDRM APTS.**  
Private Balconies and Patios  
Woodburning Fireplace  
Ceiling Fans  
Gas Heat/AC  
Exclusive area in Wamego  
**1-888-537-9064**

## WHITE CITY AREA

Beautifully updated 4 bdrms 2 bath ranch home on 4 acres. Call for more information. 54x81 machine shed. \$249,000.

**Call Dolly Anderson, Broker**  
**785-532-8801**  
dollyanderson.com  
**G&A REAL ESTATE**  
Manhattan, Kansas

**Let the CLASSIFIEDS work for you place your ad today**  
**GRASS & GRAIN**  
**1531 Yuma**  
**Manhattan, KS**  
**785-539-7558**  
**Don't forget to call or go online at grassandgrain.com!**

## HORIZON

**FARM & RANCH REALTY, LLC**

RAY SWEARINGEN - BROKER/OWNER  
• Farms & Ranches • Auctions • Value Assessments  
• Rural Homes • Hunting Property

**1-888-825-1199**  
**www.horizonfarmranch.com**

For more info visit our website or contact one of our agents!

## AG LAND

**New listing! ~ 240 Ac+/-** trophy deer NW of McPherson  
**New listing! ~ 320 Ac+/-** pasture East of Bennington. Good grass, fence, hunt.  
**160 Ac+/-** Tillable, CRP, & pasture 10 mi S of Solomon. Call Brad!  
**40 Ac +/-** Tillable on blacktop N. of Delphos. Call Ray!  
**320 Ac+/-** Excellent pasture just N of Wells. Spring water, pond, good pipe pens.  
**120 Ac +/-** On Burma Rd just N of Lindsborg. Call Ray!  
**~Owner Will Finance~ 300 Ac +/-** Mostly tillable on the Solomon River just SE of Bennington. Call Ray!  
**240 Ac +/-** Geary Co. blacktop frontage 190 pasture w/new fences, 3 big springs and 2 new wells. 45 tillable. Close to town. Seller is a Kansas licensed real estate agent. Call Ray!  
**105 Ac+/-** Upland tillable and CRP, N of Chapman at Rain Rd. and 18 Hwy.  
**158 Ac+/-** Excellent pasture with 2 ponds, creek bottom tillable, and timber with big deer at the OT/SA county line. Call Ray!  
**366 Ac+/-** Farm w/irrigated river bottom tillable at Lindsborg. Not another one like it! Call Brad!  
**160 Ac+/-** w/2000 hd feedyard, set up right and ready to sell @ Lindsborg.  
**160 Ac+/-** Upland irrigated tillable @Lindsborg. Call Brad!  
**Nice country home on 10 Ac+/-** @Lindsborg! Call Brad!  
**640 Ac+/-** Pasture/tillable at Bennington State Lake. New fence and ready to go! Call Brad!  
**145 Ac+/-** Past/till combo with creek timber and alfalfa. SE of Lindsborg. Call Ray!  
**Home/bldgs 3 Ac+/-** SE of Minneapolis Call Ray!

## UPCOMING AUCTIONS

**Oct. 27th ~ 295 Ac+/-** Auction results: TR1 - \$530,000 or \$3,312/AC. TR 2 - \$432,000 or \$3,660/AC.  
**Nov. 10th ~ 175 Ac+/-** Till/Past combo on 56 HWY just E of Delavan, poss bldg site w/pond NICE FARM. Call Sheila, 785-280-3564

**Thinking of buying or selling?**  
**Contact one of our agents today!**

Brad Budden: 785-280-0915	Ty Bryant: 785-366-0261	Sheila VanWinkle: 785-280-3564
Ray Swearingen: 785-452-8498	Rachelle Swearingen: 785-452-5115	Billy Randle: 785-479-1152
Tim Hamm: 785-392-4334	Calvin Carlson: 785-819-1480	Lucas Hamm: 785-366-3580

## REAL ESTATE

## FARM & RANCH

**Land For Sale**  
**Saline Co.-** AUCTION November 15, 2016: 138.25 Acres m/l. Native Grass Pasture. 1 pond. Rural Water Hook-Up. Chris, 493-2476

**Saline Co.-** 125 Acres m/l. Cropland North of Glendale. Chris 493-2476

**Saline Co.-** 15 Acres m/l. Building Site w/Great Views. North of Salina right off blacktop rds. Chris 493-2476

**Saline Co.-** 28.75 Acres m/l. Southeast of Saline. Pasture w/a Pond. Chris 493-2476

**Saline Co.-** 130 Acres m/l. Cropland and the balance in Timber and creek. Chris 493-2476

**Ottawa Co.-** 35 Acres m/l. Native Grass. Creek & Timber on East Boundary. Off Blacktop Rd. Chris 493-2476

**Ottawa Co.-** 6.4 Acres m/l. 5 1/2 Acres cropland. Potential rural home site. North Edge of Niles. Chris 493-2476

**Ottawa Co.-** 1.4 acres m/l. Wooded lot on the river. Perfect spot to fish. Chris 493-2476

**Ottawa Co.-** 640 acres m/l all native grass pasture, running springs, 5 ponds, 230th and Ivy Road. Chris 493-2476

**Ottawa Co.-** 480 acres m/l near Verdi with 350 acres excellent river bottom crop land and the balance in timber. Chris 493-2476

**Ottawa Co.-** 153 Acres m/l. Rolling Hills Pasture. Just West of Triple Tree, Close to Bennington. Sharon 826-0010

## Homes For Sale

**Saline Co.-** AUCTION November 19th. 1 1/2 story home just outside of Salina on 3.5 acres. Mark 826-3437

**Saline Co.-** 20 Acres m/l. Exquisite home w/many extravagant features. 5100 sq. ft. of Living Space. Barb 819-2789

**Saline Co.-** .64 Acres m/l. 1 1/2 story home on the edge of town. Lots of updates. Heidi 826-7962

**Saline Co.-** 6.67 Acres m/l. Grand 2 Story w/6000+ Sq. Ft. 5 Bdrms. Private Pond. Heidi 826-7962

**Saline Co.-** Manufactured Home. Eli-Saline School District. 3 Bdrms. Very Affordable. Amber 820-7472

**Saline Co.-** .43 Acres m/l. 3 Bdrms. 2 Baths. 1392 Sq. Ft. SES School Dist. Nancy 822-1960

**Ottawa Co.-** 4.36 Acres m/l. 5000+ Sq. Ft. Home w/Walk Out Basement. 5 Bdrms./6 Baths. Amber 820-7472

**Ottawa Co.-** 4.6 Acres m/l. Updated 2 Story Home. 5 Bdrms. 1 Car Garage. Vicki 452-8177

**Ottawa Co.-** Close to Benning State Lake. Completely Redone in 2015. Garage + 2 Out-buildings. Kimberley 822-8410  
**Farm & Ranch Division Of:**



**Antrim-Piper**  
**Wenger Realtors®**  
631 E Crawford Salina KS  
www.cbsalina.com  
**1-800-276-3641**

© 2016 Coldwell Banker Real Estate LLC. All Rights Reserved.  
Coldwell Banker® is a registered trademark, licensed to Coldwell Banker Real Estate LLC. An Equal Opportunity Company. Equal Housing Opportunity.

## TRAILERS

**FOR SALE 2005 TITAN G/N 25'** flatbed trailer \$4800 Call 785-840-8243

**Titan – Elite – Sharp**  
**Your Trailer Super Store!**  
**Mid-Plains Equipment**  
E. Hwy 30 & 10, PO Box 2526  
Kearney, NE 68848  
Delivery Available  
**308-237-5810**  
www.midplainsonline.com



**DONAHUE**  
**When There's Work To Do...**  
**DONAHUE!**  
**1-800-457-7406**  
www.donahuetrailers.com



## TRAILERS



Your Local Dealer for:  
TravAlong, PJ, Hillsboro,  
Sharp, Titan West, Hayliner,  
and Bradford Built.

**Hail sale:**  
**\$1,500 off Hillsboro.**  
**\$500 off Travalum.**

### Rocking "M"

**Trailer Sales**  
430 S. Colorado  
Waterville, KS 66548  
Office: 1-866-261-2526  
Shawn: 785-562-6614  
Kelsie: 785-313-3233  
[www.rockingmtrailers.com](http://www.rockingmtrailers.com)



**NEW STOCK, HORSE,  
FLATBED, &  
UTILITY TRAILERS**  
**TRAILER REPAIR BRAKES,  
LIGHTS, SAND BLAST,  
PAINT WELD**

**We Install Brake Controllers**

#### USED TRAILERS

'15 Quality 10x14 GN TIH.....  
\$4,500  
'98 Jims 5x14 BH utility...\$750  
'13 Land Pride FDR1660, like  
new .....\$1,800  
'13 Diamond C 20' GN utility...  
\$4,500

#### Blue Valley Trailers

225 South East St.  
Waterville, Kansas 66548  
**785-363-2224**  
**1-866-368-4826**



**HUSTLER**

**DROP 'N LOCKS**  
GOOSENECK HITCHES

### BOB'S TRAILER SALES

Pomona, Kansas  
**785-418-2227**

[www.bobstrailersales.com](http://www.bobstrailersales.com)

•2016 Travalum 24' gooseneck .....\$13,900  
•2016 Circle D 24' stock trailer.....  
\$8,500  
•2016 Circle D half nose stock  
trailer, loaded 24' .....\$9,500  
•2016 Elite 30' 10k axles  
Gooseneck flatbed .....\$7,500  
•2016 Elite 25', 2-7k axles  
Gooseneck flatbed .....\$5,400  
•2016 Elite 25' 10k axles  
Gooseneck flatbed .....\$6,950  
•2016 Elite 32' 10k axles  
Gooseneck flatbed .....\$7,800

#### Used Trailers

•2012 Big Tex 30' 2 10K Axles.....  
\$5800  
•2003 Gooseneck VW Stock  
Trailer, extra clean .....\$3500

### Trailers 4 U

**785-292-4166**  
Frankfort, KS



[www.trailers4u.com](http://www.trailers4u.com)

#### TRAVALONG TRAILERS

New steel & alum. stock  
New 20' to 31' flatbed  
Used 18', 22' stock- 14' dump  
Used 3 horse GN- slant  
2 used 14' GN flatbed

#### VISSER TRAILER SALES

Herington, KS • 785-258-2800

### CIRCLE D

**LIVESTOCK & HORSE  
TRAILERS**  
**FLATBED TRAILERS**  
• 1-800-526-0939 •  
[www.circle-dtrailers.com](http://www.circle-dtrailers.com)

#### MACHINERY

**Allis Chalmers Tractors**  
180 GAS Cab Loader.....\$5,500  
200D, 7020 loaders.....\$7,500ea  
7000D, 7050D cabs...\$7,500ea  
7040 CAH PST .....\$6,500  
Seneca, KS • 785-336-3158

## MACHINERY

#### USED TRACTORS

'08 Case IH Maxxum 125 MFD  
w/loader. 2110 hrs  
'97 Case IH MX120 MFD  
w/loader, 4080 hrs  
'65 IH656 gas w/loader  
'41 IH FarmAll A w/Woods  
belly mower

#### MISCELLANEOUS

'16 Brush Hog 1812 Batwing  
Mower, 12'  
'15 Sunflower 6631 VT 27'  
'13 CASE IH DC132 disk  
MOCO  
2010 Vermeer WR22 10 wheel  
rake  
'10 CASE IM 1250 planter  
12/30 Bulk fill  
Case IH 183 12 row 30 folding  
cultivator  
Rhino SR 120 3 pt rotary  
cutter  
'07 Case IH RMX340 25'  
IH 496 Disc, 22'

2 Case IH 4300 FC 26' and 33'  
IH 4500 F.C. 18.5'  
Case IH 6500 conser til chisel  
14'

Sunflower 1433 25' disk  
IH 470 disk 14'  
IH 55 chisel 7' trailing  
IH 9' chisel, 3pt  
'96 JD 9500, 4WD, 3275 eng.,  
2205 sep.

'91 JD 653A row head  
'89 JD 643 cornhead  
'98 CASE IH 2366 4WD 2220  
hrs. eng., 1550 hrs. sep.  
'91 Case IH 1680 combine  
4WD

'06 Case 1020 30'  
'05 Case 1020 30'  
'89 Case IH 1020 25'  
'99 Case IH 1020 20'  
'94 Case IH 1063 cornhead  
'89 Case IH 1083 cornhead  
IH 810 platform  
IH 863 cornhead  
IH 1250 Grinder/mixer  
'95 Case IH 8465, A. baler  
'88 Heston 550 rd. baler  
IH 2001 loader

60" rotary mower 2 pt. hitch  
Landpride 7' finish mower  
JD 913 V-ripper, 3 shank  
**NEW EQUIPMENT**  
CASE IH 1255 Planter  
Farmall 40C  
Farmall 55C, CVT cab  
Farmall 75C w/cab & loader  
Magnum 250 & 310  
340 disc 28"

Several Bush Hog rotary  
mowers and tillers



**ROSSVILLE  
Truck & Tractor**  
ROSSVILLE, KANSAS  
**785-584-6195**

#### NEW VERSATILE DEALERS

#### USED FORAGE

#### HARVESTERS & HEADS

'11 Claas 960.....Coming  
'10 Claas 980.....Coming  
'09 Claas 980  
'05 Claas 900.....Call  
'04 Claas 900.....Call  
Claas RU600, 8 row head.....  
From \$30,000  
\*\*\*\*\*

#### TRACTORS

2012 Case 315.....\$190,000  
Agco Star 8360 .....\$45,000  
\*\*\*\*\*

#### COMBINES

#### 0% For 5 years on all

#### 62 & 72 Series combines

'13 Gleaner S67  
'12 Gleaner S77  
'12 Gleaner S67  
'11 Gleaner S67  
(2) '10 Gleaner R76  
'05 Gleaner R75.....\$120,000  
'02 Gleaner R72.....\$85,000  
'99 Gleaner R72.....\$75,000  
'95 Gleaner R72  
'98 Gleaner R62.....\$67,500  
(2) '97 Gleaner R62...\$45,000  
'94 Gleaner R62.....\$40,000  
'13 3000 12R30.....\$55,000  
'11 3000 12R30.....\$50,000  
\*\*\*\*\*

#### MISCELLANEOUS

Sunflower Tillage equipment...  
.....Coming in daily



**ALLIS  
WHITE  
HESSTON**

**MASSEY FERGUSON**

**Kalvesta Impl.**

**Company, Inc.**

**620-855-3567**

**KALVESTA, KS 67856**

[www.kalvestaimplement.com](http://www.kalvestaimplement.com)

**GLEANER 318 FLEX HEAD** for  
L or M combine. \$2,500.  
785-836-7547 or 785-438-8946

## MACHINERY

WE ARE DEALERS FOR

**GEHL**

**BUSH HOG**

**Kelly-Ryan-  
Kewanee - Westendorf  
C.E. Attachments  
H&S**

**Just In**

**10', 12', 14', 16',**

**18', & 20' GATES**

**CORRAL PANELS**

8' corral panels.....\$60.00  
10' corral panels.....\$70.00  
12' corral panels.....\$80.00  
14' corral panels.....\$90.00  
16' corral panels.....\$100.00  
**HD Round Bale Feeders\$250**

#### SKID LOADERS

#### & ATTACHMENTS

Tobin flip blade for skid steer  
New Gehl R260 skid loader  
New Gehl V330 skid loader  
New Gehl RT210 track ldr.  
Used Gehl 5240  
2012 Gehl 5640 E skid loader  
Gehl CTL 70 Cab w/heat  
2013 Case, SV250 fully  
equipped, 1500 hrs  
Worksaver walk thru pallet  
forks 48".....\$800

CEA high dump 8' bucket  
Haugen bale grapple bucket  
New M&M tree shears &  
Graples

New CEA pallet forks  
New CEA tooth bars  
New Mensch, manure scrprs  
New Danuser and Lowe post  
hole diggers, skid loader  
mounts .....\$2,500

New brush grapples  
New Bale Spears for big  
rounds and square.....\$650

#### NEW EQUIPMENT

Enorossi 12 14 wheel hayrakes  
Meyer's manure 350 sprds.....  
\$15,000  
Cimmaron 6', 7', & 10' 3 pt. ro-  
tary mowers  
H&S GM170 grinder mixer

#### USED EQUIPMENT

Gehl 95 & 120 MX grinder/  
mixer  
Vermeer R23A rake. Twin  
parallel bar  
1999 NH TV140 bi-directional,  
w/ 7614 loader, 2700 hrs  
2009 JD 620I Gator w/cab en-  
closure

Kuhn 8132 manure spreader  
GB 660 loader CIH 5120 se-  
ries Maxum tractors  
Dual 800 loader  
Leon Loader w/AC 7000 series  
mounts

#### SENECA IMPL.CO.

Hwy. 36 West  
SENECA, KANSAS

Day ...785-336-2621

Night.....785-336-2502

#### PLANTER SALVAGE

IH 800-900-950-955 Cyclo  
JD 494-1280, 7000-7300,  
plate and plateless  
White 5100

#### Koelzer Repair

Onaga, KS 785-857-3257

#### — ITEMS FOR SALE —

ONE OF THE BIGGEST  
SELECTIONS OF ROW CROP  
CULTIVATORS IN KANSAS ..  
.....CALL

2008 JD 7330 TractorPQ-  
lethand reverser new KMW  
loader .....\$60,000  
2008 Challenger MT 465B  
MFWD .....\$42,000  
Ford 7740 tractor w/Koyer 500  
loader .....\$8,000  
Minn. Moline G1000/dozer blade  
.....CALL

1979 CIH 2090 tractor ...CALL  
Allis 9170 tractor .....CALL  
2000 JD 9650 combine .\$42,000  
2000 JD 930R Rigid Head ....  
\$8,500  
2004 JD 630F Flex head .\$9,000  
1990 JD 853A rowhead \$14,000  
JD 853A Row head ...10,000  
2004 CIH 1020 Flex 30' w/air  
reel .....CALL

Several CIH 1020 flexheads in  
stock .....CALL  
2003 CIH 2208 Cornhead 8R30  
.....\$12,000  
2010 CIH 2152 Draper 45' .....  
\$29,000  
JD 893 Corn head .....CALL  
JD 643 Corn head 6r ...\$3,000  
UFT Graincart .....\$1,500  
Dakon 250 gravity wagon \$1,200  
2000 JD 955 swather ...\$7,500  
Vermeer R2300 hyd. rake .....  
\$11,500

NH BR7090 Rd baler ...CALL  
2009 JD 568 Rd. baler ...\$19,500  
NH 273 sq. baler string ...CALL  
Maxilator MMG100 Bale fork ...  
\$3,250

## MACHINERY

#### OUR 64th YEAR

#### NEW TRACTORS

2016 JD 6155M

2016 JD 6155R

#### USED TRACTORS

2014 JD 8370R

2013 JD 8360R

2013 JD 8335R

2012 JD 8335R

2011 JD 8335R

2005 JD 8220

2009 JD 7930

2014 JD 6140R

#### USED PLANTERS

2015 JD 1795, 16/31

2014 JD 1790, 16/31

2013 JD 1770 NT 16 row

2005 JD 1760 12 row

#### COMBINES

2015 JD S670

2014 JD S660

2012 JD S660

2014 JD 608C

2011 JD 608C

2010 JD 608C

#### NEW EQUIPMENT

#### SPECIALS

2016 JD 3038E

2016 JD 1025R

#### USED EQUIPMENT

2015 JD 2510H, Dry 16 row

2011 JD 568 baler

2008 JD 568 baler

#### SOLID — STABLE

#### STILL JD

**TODD TRACTOR**

**COMPANY INC**

**785-336-2138 Days**

**785-548-5855 Nights**

Visit Us At

[toddtractor.com](http://toddtractor.com)

Seneca, Kansas

**JD 925 FLEX HEAD, GOOD**  
condition, new plastic skids.  
316-708-0888

#### NEW EQUIPMENT

6650 Baler

R2300 rake

VR1224

BPX 9000 Bale Processor

TE170 Tedder

MC 3700

#### USED EQUIPMENT

605G baler

605M baler

R2800 rake

M850 Mower Demo

3 pt tree shear

#### BERG REPAIR

**Vermeer**

**WINKEL**

**Deweze**

14200 Godlove Rd.

Westmoreland, KS

**785.457.3534**

#### • New Holland 351

grinder/mixer, shedded.

• Bush Hog 3pt post hole auger.

• International #10 white box

grain drill with grass seeder.

• JD #260 3pt disc mower.

• 480 International Disc

**785-448-4152**

1995 Meyer Chuckwagon .....  
\$7,000  
SF 1433 Disc 25' .....\$10,000  
Crustbuster 4000 8' spacing 25' ..  
.....\$10,000

Quinstar Fallow Master ...CALL  
IH 480 disc .....\$2,200  
JD 900 ripper .....CALL  
JD 2600 5 btm plow ...\$2,000  
White 5 btm. plow, ....\$1,500  
Orthman 9300 Cultivator 8R-W ..  
\$9,000  
JD 886 cultivator 8 rw, ...CALL  
Blu Jet II 7 shank, ....\$6,200  
JD 120 Flail Shredder ...\$5,500  
JD 7000 planter 8x30 ...CALL  
JD 7000 planter 4R .....CALL  
GP 2N-2410 Drill .....CALL  
Tree Shearer .....\$2,750  
Rhino SR20M-20 Batwing  
mower, .....\$7,500  
JD dozer blade, .....\$1,400  
Wemco header trailer 32 & 35 ft.  
NEW .....CALL

**Complete listing on our web:**  
[www.jonesmachineryinc.com](http://www.jonesmachineryinc.com)

**BUY/SELL/TRADE DAILY**  
Smith Center, KS  
**785-282-3000**

785-282-0432 Cell

785-686-4005

Evening Calls Welcome

**JONES**

**MACHINERY, INC.**

## MACHINERY

#### — USED IMPLEMENT —

1981 Hesston 1580 2WD  
tractor

Gehl 1870 rd. baler

2014 Gleaner S77 combine

Hesston 946 rd. baler

2013 Gleaner S-77

1998 Gleaner R72



## MACHINERY

### COMBINES

2007 Case IH 7010, 4WD  
2011 Case IH 7088, 4WD  
2007 CASE IH 2020 flex, 30', 35'

1995 Case IH 2188, 2WD  
2005 CASE IH 2208 8RN

### NEW TRACTORS

Case IH Magnum 250 CVT  
Case IH Maxxum 115 MFD  
Case IH Farmall 120U MFD  
Case IH Farmall 120C MFD

### USED TRACTORS

2013 Case IH Magnum 340  
2013 Case IH Maxxum 125 MC  
1996 JD 6300 2WD, cab, ldr  
1980 JD 2440 2WD, ldr  
1988 Bobcat 843 SSL

### MISCELLANEOUS

2010 Case IH 330 Turbo, 31'  
2006 Case IH RMX 370 disc 28'  
2013 Case IH 1245 16/31  
2010 Case IH 1240 16/31  
2008 Case IH 1240 16RN, BF  
1995 Case IH 4800 FC 32'  
1994 Case IH 8465, twine  
IH 490 disc 25'  
Landpride RB 55120 10' blade  
2004 JD 915-7 ripper



**McConnell Machinery**

1111 E. 23rd Lawrence, KS  
**785-843-2676**

or  
3313 Nebraska Terr. Ottawa, KS  
**785-242-1463**

Evenings  
**785-979-2271**  
www.mcconnellmachineryco.com

**2013 DEERE 1590 DRILL, DRY**  
fertilizer, 15ft., 7.5", less than  
1500 acres, \$38,500. Always  
shedded. 620-960-5628

**JD 530 TRACTOR, NFE** fend-  
ers, 3pt., PS, -JD BWA wheel  
disk 10t. Both are very nice.  
785-249-8751. Text for email.

## MACHINERY

**TREE BUSTER FLUSH CUT**  
tree saws clear pastures, all skid  
loaders, no moving parts, hard-  
ened steel. For video search  
Facebook tree buster-flush cut  
tree saws \$1,950 785 263 6224

**FOR SALE: JD 7000** planter,  
6-30, plateless, finger-pickup  
meters, Kinze planting meters,  
soybean and milo discs, sun-  
flower finger wheels, Keeton  
seed firmers, drag chains. Field  
ready. Denison area. \$3500.  
785-749-0827

**JD 653A LATE MODEL**, flexible  
drives, trailer, \$3750.  
785-532-9216

### FOR SALE: 2011 CIH 7088

Combine, 2100 engine hrs., ran  
through Bruna Implement Co.  
shop yearly, excellent,  
\$120,000; 2009 35' 2020 CIH  
Flex Head with Clary reel,  
\$22,500; 2010, 30' 2020 CIH  
Flex Head with Clary reel,  
\$22,500; 2010, 3408 CIH Corn  
Head, 3000 acres, \$35,000.  
785-336-1333 or 785-336-1339

Several new Hydra Beds in  
stock  
Used #3150 Besler Bale Bed,  
long box .....\$4,000  
Used M-F #35 with new rub-  
ber, nice .....\$1,935  
Used 3 pt post hole digger .....\$350



**WINCHELL'S, INC.**

Phillipsburg, KS 785-543-2118

**CAT D7 3T HYDRAULIC TILT**,  
90% undercarriage, good dozer,  
ready for work. \$10,500.  
785-933-2554

**1983 1460 IHC COMBINE**,  
good condition. 4667 hrs. 24'  
header. 785-545-6561

## MACHINERY

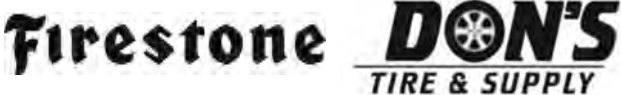

480/80R38 RAD AT 23 .....\$1,002  
30.5LX32 SAT 14pr TL .....\$1,978  
18.4X34 SATII 8pr TL .....\$621  
14.9 FST Irrigator 98% .....\$170

**TF-866-888-7838**

**www.donstire.net**  
**ABILENE, KS**



With 5 locations,  
**Abilene Machine** is one of the  
largest distributors of new,  
remanufactured and recycled  
ag replacement parts in the  
United States.



**800-255-0337**  
**www.AbileneMachine.com**

## MACHINERY



**NEW**

- 604-605N net
- 6640 net ramp
- R2300 & R2800 rakes
- TM800 & TM850 disc mowers
- VR1022 & VR1224 wheel rakes
- TM1400 Trail 18' disc mowers
- M205 with 16' disc head

*Please check our website,  
www.sloophook.com or give  
us a call at 785-828-4706  
to view all of our New  
and Used Equipment*

**MacDon**  
**Sloop Sales &  
Hook's Repair, Inc.**  
Lyndon, KS 66451

Grass & Grain, November 1, 2016

Page 27

## MACHINERY

**FOR SALE: GREAT PLAINS**  
turbo tiller 2200. 22ft \$19,500  
OBO contact Curtis, call or text  
@ 785-479-0274

### Case & IH Tractor Salvage

Case 300's thru 2096  
IH 460's thru 5488  
Over 1000 Tractors on shelf  
New & Rebuilt parts for all  
brands of tractors & combines

Want to buy  
Case & IH salvage tractors  
**Elmer's Repair**  
CENTRALIA, KS  
785-857-3248  
**www.elmersrepair.com**

**KELLY RYAN 5 X 12 WAGON**  
runs good, \$2500.  
785-366-6503 or 785-949-2430

### Gleaner Combines

'04 R75 RWA.....\$67,500  
'04 R65.....\$53,500  
'01 R62.....\$62,500  
'99 R62.....\$44,500  
EZ Trail Gravity Wagons,  
Grain Carts, and Header  
Trailers.

### Great Plains Tillage Tools

**81 Farm Eq. Service**  
McPherson, KS. 620-241-3100  
**1-800-357-3101**



**NEW**

Balers: 605N, 504N, 665  
Rancher  
Rakes: VR1428, VR1224  
BPX9000 Bale processor  
**USED**

4 604SM, 1 605M, 1 665  
Rancher, 1 504N, 1 605K  
2 R2800 twin rakes, 1 R2300,  
1 VR1428, 2 VR 1224

**LARGER BALE FORKS**  
**SPRING STEEL AVAILABLE**  
**METAL**  
**ROUND SQUARE TUBING**  
**ANGLE CHANNEL & FLAT**  
2 3/8", 2 7/8", 4 1/2" pipe  
3/4 & 7/8 sucker rods

**WELDING SUPPLIES**  
Oxygen CX125 & acet. Bottles  
for sale  
Welding rods & wire  
Top & bottom belts for all bal-  
ers  
Twine 4' & 5' netwrap  
Portable panels, Feed Bunks  
& Round Bale Feeders

### Forrest Johnson

LEONARDVILLE, KS 66449  
785-293-5583  
785-293-2235

### TIRE TOWN INC.

18.4-34 new, 10p .....\$575  
11L-15 rib 12p, new .....\$90  
800/70R38, 80% .....\$1,500  
16.5L-16.1, 10p, new .....\$235  
20, 8-38, 10p, new .....\$760  
18.4R46, new.....\$1,450

### Nationwide Shipping

### WE DEAL

**Other Sizes and Prices**  
**New & Used**  
**800-444-7209 800-451-9864**  
**913-441-4500 913-682-3201**

### FOR SALE OR TRADE

Gravity Wagons  
New Holland 258 rakes: 1  
ground driven, \$1,575; 1 hy-  
draulic driven, \$3,650

### Cooter's

**785-562-2027**  
**785-562-6131**

**MASSEY 883 CORN HEAD**  
8-30 used on Gleaner S77,  
good. 785-761-4554

### SALVAGING COMBINES

N5, N7, L, L2, M, F, G, C, CII,  
All, A&E, K Gleaner. 6620,  
7720, 8820, 7700, 6600, 4400,  
3300, 105, 95, 55, JD. 915,  
1480, 1460, 1420, 815 IHC.  
860, 760, 750, 510, 410, 300  
Massey. Several black and or-  
ange Gleaner cornheads.

### Jack Boyle

Vermillion  
785-382-6848 785-564-0511

**USED LOADERS: 8 UNITS** off  
older IH and Case tractors.  
Elmer's Repair. 785 857 3248

**1996 MF 8570 COMBINE**, straw  
chopper, 8 row corn head, good  
condition. 620-664-4123

## EMPLOYMENT

**Star Seed, Inc. in Osborne**  
**Kansas has an immediate**  
**opening for an Agronomy**  
**Sales position located in**  
**Southern Kansas.**

This person should hold a  
degree in agronomy or a related  
field & poses a valid Kansas  
Driver's License. This person  
will be responsible for sales &  
agronomic assistance in  
Southern Kansas. Please send  
cover letter & Resume to  
**Star Seed, Inc.,**  
**101 Industrial Ave., Osborne,**  
**KS 67473. Attn. Devon Walter.**  
Or email  
[devon@gostarseed.com](mailto:devon@gostarseed.com)



### General Manager Position

Phillips Seed Farms, Inc. of  
Hope, KS is a family owned  
seed business in Central  
Kansas, with three locations, is  
seeking a well-qualified individ-  
ual as General Manager.  
Individual should have at least  
5 years' experience managing  
people, sales, and assets. A  
strong background in account-  
ing and / or understanding of  
financials is required. Additional  
knowledge of the seed industry,  
grain markets, and excellent  
people skills is a must.  
**Please send resume to:**  
[Allison@phillipsseed.com](mailto:Allison@phillipsseed.com)  
Or Mail to:  
Phillips Seed Farms, Inc.  
Attn: Allison Sluder  
980 Highway 15  
Hope, KS 67451  
**No phone calls please**

**HELP WANTED: OFFICE/**  
Clerical PT Clerical Person  
needed from Monday- Friday,  
\$250.00 weekly. Computer skills  
are a must. Need to be detail  
oriented, possess good cus-  
tomer service skills, some cash  
& items handling skills, Must be  
able to do little errands. Apply  
Email: [loffber8887@gmail.com](mailto:loffber8887@gmail.com)

## BUILDINGS - BLDG MATLS

### SMITH POSTYARD

**Hedge Post**  
**Delivery Available**  
**JEFF SMITH**  
**620-496-8956**



**STEEL BUILDING**  
**INVENTORY SALE**  
**I-Beam Construction**  
**Easy Bolt-Up Design**  
**40x65, 60x90, 100x150**  
**Many Others Available**  
**(800) 369-3882**  
**www.toplinebuildings.com**  
**sales@toplinebuildings.com**



**29 ga 40yr ptd.....\$62/sq**  
**29 ga 20yr ptd.....\$55/sq**  
**29 ga Galvalume .....\$47/sq**  
**Complete Building**  
**Packages**  
Doors, Insulation, Livestock  
Equipment, Scales, Waters  
**\*Jobsite Delivery Available\***  
(prices  
subject to  
change)

### METAL PANELS & ACCESSORIES

**THE VALUE LEADER**  
**WE WON'T BE UNDERSOLD**  
**METAL \$54/ SQUARE**

• DELIVERY AVAILABLE •  
Prices subject to change  
**WESTERN METAL**  
**2 Locations • Best Service**  
**LOUISBURG, KANSAS**  
**1-800-489-4100**  
**HAYS, KANSAS**  
**1-800-770-2725**



**20% OFF JD Work-Site Attachments with**  
**Purchase of Pre-Owned Skid Steer**

\*Program Ends Oct. 28th 2016

13	JD	320D, 106 Hrs	\$31,000	B	10733
10	JD	326D, 590 Hrs	\$29,000	B	10820
15	JD	320E, 162 Hrs	\$35,000	B	10863
11	JD	333D, 1467 Hrs	\$45,000	E	11232
14	JD	320E, 91 Hrs	\$37,500	B	11296
15	JD	320, 153 Hrs	\$39,950	B	11319
12	JD	332D, 1150 Hrs	\$41,500	B	11320
12	JD	333D, 450 Hrs	\$49,500	B	11321
13	NH	C232, 958 Hrs	\$42,200	E	11360
05	JD	325E, 121 Hrs	\$18,000	E	11476
14	JD	332E, 536 Hrs	\$49,500	B	11481
07	JD	317, 550 Hrs	\$18,500	E	11502

### TRACTORS

2014 NH L225 Skid Loader  
85 hrs  
2015 JCB 280 skid loader,  
105 hrs.

2015 JD 323 E track skid  
loader, 140 hrs.

Cat 8' roll out bucket, off  
928G

2012 JCB260 skid loader

2013 JCB260 skid loader

New JCB 205 skid loader

2011 NH T6070 MFD KMW  
1660 ldr. 1500 hrs.

2008 JCB 536-60 Agra tele-  
handler 2,800 hrs

2006 NH TG215 MFD 1250  
hrs

2003 Case IH MX255 Mag-  
num, 6400 hrs

IH 806 w/loader

### HAY EQUIPMENT

New Hesston 2956A rd  
balers

2013 Hesston 2856A net  
baler

New H&S 1660 16 wheel Hi  
Cap rakes

### COMBINES

2010 MacDon FD70 40' flex  
draper JD mounts

2005 Case IH 2388, special-  
ity rotar, 1500 rotar hrs

2004 Case IH 2366

1990 Case IH 1083 corn-  
head

**AUGER & GRAIN CARTS**  
Frontier GC 1108 grain cart

850 bushel

2008 Harvest International  
13x72 swing hopper

Westfield TR100-61 std.  
Hyd. swing hopper

New Mayrath 10x35 elect.  
New Parker 839 grain cart

Parker 510 grain cart, corner  
auger

2009 Demco 750 grain cart

Brandt 1050 grain cart,.....  
.....Special Pricing

### MISCELLANEOUS

2004 Sunflower 9433 no-till  
drill

200 Case IH 3950 23' disk

EZ Trail 30' header trailer

JD F135 4x16 plow

Howse 7' rotary mower

New Cimarron 7' rotary  
mower

Case IH 1200 16RN planter

New Brown 10' & 12' box  
scrapers

New Sunflower 6630/27' ver-  
tical till

2011 Sunflower 1435-40  
split wing disc

2009 Sunflower 9434-30'  
Very good condition

New Rhino 1540 hydraulic  
blade

Icon 1632 grader rear steer



**SUPERIOR**  
**IMPLEMENT, INC.**

**402-879-4723**

Evening: 402-879-3719

**SUPERIOR, NEBRASKA**



## BUILDINGS - BLDG MATLS

**GoBob**  
Pipe & Steel Sales



"Get your shelter set up BEFORE you need it. To INSPIRE you to act now, we are giving discounts up to \$500, depending on the size and options UNTIL THE FIRST SNOW OR SLEET HITS in our area, then the sale will end and the waiting will begin.  
**1-855-880-7964**  
gobobks.com

## FOAM INSULATION

The Icynene Insulation System™ Metal Bldgs. — Homes  
**800-334-3626**  
Healthier, Quieter, More Energy Efficient.™  
MID-AMERICAN SALES, INC.

## Butterfly Supply, Inc.

**800-249-7473**  
• Tubing • Rods • Cable •  
• Guardrail • Clips •

**STEEL FENCING & BUILDING SUPPLIES**  
www.butterflysupplyinc.com



**GoBob**  
Pipe & Steel Sales



Steel pipe and gates, continuous fence, corral and fence materials, best prices!  
**1-855-880-7964**  
gobobks.com

## BINS - DRYERS - VACS



Check my prices on Brock Grain Bins  
CONTACT: LYNN KOHAKE  
**785-336-1692**

## WANTED

**DAMAGED GRAIN WANTED STATEWIDE**

We buy damaged grain, any condition -wet or dry- including damaged silo corn.

**TOP DOLLAR!**

We have vacs and trucks.

**CALL HEIDI OR GARTON NORTHERN AG SERVICE, INC.**  
**800-205-5751**

**WANTED: BIG OX V-RIPPER**  
9pt. with gauge wheels.  
785-636-5262

## GRASS &amp; GRAIN

Place your Classified Ad

ONLINE at:

grassandgrain.com

## MISCELLANEOUS



**Life Size Aluminum Buffalo**

\$2,500, delivery possible.  
785-488-5150 (KS)

**SALINA, KANSAS Toy Show,**  
November 19, 2016, 4-H Building/ Kenwood Hall, 900 Greeley  
9 AM- 3 PM.

**FOR SALE: BEE EQUIPMENT.**  
Deepes, mediums, frames and more. Phone 785-632-7009.

## SERVICES

**LARRY'S PORTABLE Sawmill**  
service, can come saw your logs. 785-776-8153.  
785-565-2647.

**CUSTOM PORTABLE DISC-ROLLING**

**DARRELL WAGONER**  
Cell: **785-650-4094**

**SKID LOADER SERVICES:**  
Driveway maintenance, grading, excavation, debris removal and other services. Manhattan area  
316-680-1135

**SOIL TESTING, lab work,** fertilizer and lime recommendations.  
Call Suther Ag Services.  
785-457-3440.

## John Redmond Reservoir dredging project- Phase I complete

The Kansas Water Office (KWO) is pleased to announce the first phase of dredging at John Redmond

Reservoir is complete.

Great Lakes Dredge and Dock (GLDD) began dredging operations this past May.

## AUCTION

**SUNDAY, NOVEMBER 6 — 1:00 PM**  
**407 N. GORDY, EL DORADO, KANSAS**

**50+ silver dollars, several key dates \* Appliances:** Ducane stainless steel grill \* stainless refrigerator \* Jenn Air double wall oven \* Jenn Air counter top stove \* 2 year old Crosley washing machine \* Kenmore dryer \* Central heat furnace & central AC unit. **Antiques:** Monterey Western Ware 20+ pieces \* El Dorado Tires Metal Sign \* Advertising Signs & Items \* Red Wing Crocks \* 1950's Western Puzzles \* RR Lantern \* Coca Cola Collectible Advertising Signs \* RC Cola Clock \* Vintage Tins \* El Dorado, Augusta, Newton & Independence Ice Company Tongs \* Ranch Oak Bed \* Favorite Egg Incubator \* Augusta Kansas Mobil Refinery Pitcher & Glasses, Pegasus, Original Box

**MANY MISC. FURNITURE & ANTIQUE ITEMS**

**SUNDGREN AUCTION & REALTY • www.sundgren.com**  
**JEREMY SUNDGREN 316-377-0013**

## REAL ESTATE • INTERNET ONLY!

## AUCTION

**Bidding Ends DECEMBER 1, 2016**  
**10:00 AM**

**1318 Colorado Street, MANHATTAN, KS**

4 bedrooms 2 bath, 2060 sq ft with detached garage with shop and storage, 3 entrances to house space.

**Auctioneers Note: Great Investment property located between Poyntz Ave and Fort Riley Blvd. within walking distance of City Park.** Buyer to put down 20% earnest money deposit of purchase price at the end of the auction. Closing to occur on or before December 30, 2016. Property Sold As is Where Is. 2016 taxes to be paid by seller. 10% Buyers premium will be added to the final Bid price. **Call Auctioneer with questions or to view this property.**

**SELLER: LAURA CRABS**



Jeff Ruckert, Auctioneer  
Manhattan, KS 66502  
785-565-8293  
jctt.97@gmail.com

**www.RuckertAuctions.com**

## Huge Northeast Kansas MOVING AUCTION

**SATURDAY, NOVEMBER 5 — 9:00 AM SHARP!**

**11904 142nd St. • VALLEY FALLS, KS**

**DIRECTIONS:** From Valley Falls, at the north K4 & 16 Hwy. Jct. go east 1.7 miles to Ferguson road, then south 2.7 miles to 142nd St., then 2.4 miles east to the auction site. Park in pasture west of the house unless too wet.

**NOTE: PRE-AUCTION ONLINE ABSENTEE BIDDING HAS BEGUN AT: WWW.UCNORTHEASTKANSAS.COM**

**AUCTIONEER'S NOTE:** Doug and Deb have retired. Their property is under contract and they are moving out of state. Doug grew up in this home. There is a LARGE quantity of items on this auction, including things from when his late father, Leroy owned this farm. This is NOT a complete inventory of what will be sold as we are literally uncovering new things every day. **WE WILL RUN 2 RINGS PART OF THE DAY. Be on time and plan to spend a full day with us.**

**GUNS, AMMO, BOW, HUNTING/FISHING:** Offered at **11:00 AM as a second ring. SELL IN ACCORDANCE WITH STATE & FEDERAL FIREARMS LAWS. If in doubt, CALL AHEAD**

Argentine Mauser model 1893, 7.65x53; Carcinoma model 9124, 6.5x52; Colt Police Positive .38 special; Colt SAA 3rd model .38 special; Fabricas de Armes Oveido, 7x57; Hawes tip-up .22LR; Marlin model 6088CC .22LR; Mauser 98, 8mm; Model 151M .22LR; Mossberg model 500A 12 ga.; Mossberg model 715T .22LR; Remington model 512 .22 S/LR; Remington model 870 12 ga.; Santa Fe Division of Golden State Arms 1941 Supreme .303; Spanish Mauser model 1916, 7x57mm; Springfield 1903, 30.06; Taurus model PT 9-11, 9mm; Thompson Center Arms .223 Pachmyr conversion; Thompson Center Arms .44mag; Winchester model 70, 300 win mag; Winchester model 1400, 16 ga.; S&W 4-screw model .38 special, works but barely any finish; Ammunition including 300 win mag; 7.65; 308; 22-250; 40 S&W; shotgun shells; possibly more ammo; wood ammo boxes; shotgun & rifle reloaders; dies; brass; Millett Sights Benchmark handgun shooting rest, NIB; double clay pigeon thrower mounted on concrete; gun cleaning rods; PSE Graphite USA Spirit compound bow w/ case, quiver, arrows, no sights; Martin Archery Tru-shot 300 compound bow sights w/ case. **TRACTOR & EQUIPMENT:** Allis Chalmers D-17 series 4 tractor, with a 5' front end loader bucket; 3-pt rotary mower; 3-point 8" post hole auger; 3-point bale spear; hay rake; 2-fuel tanks &

stands; New Holland 8' sickle bar mower; grain auger; Pickson zero turn mower.

**CAR & STORAGE UNIT:** 2000 Ford Explorer, 142,562 miles; storage container, 23'x8'x8' (2 weeks to get moved).

**MOTORCYCLES & GATOR:** Honda Reflex motorcycle, running w/good title; Suzuki motorcycle, running, no title; Gator 4x2, dump bed, 2,424 hrs.

**SHOP EQUIPMENT & TOOLS:** Chain hoist; engine stand; elec. welder; handy man jack; come-alongs; acetylene torch & cart; metal work bench w/wise; pipe wrenches; bottle jack; large anvil; several heavy log chains; boomers; socket sets; creeper; scroll saw; table saw; car ramps; air bubble; Huskee 26 gal. air compressor; several parts organizers & cabinets; Craftsman radial miter saw; tile cutter; roto zip; tap & die set; Mig 100 welder; Halogen shop light; step ladders; 12" McCullough Mac 10 chain saw; Husqvarna 20" 351 chain saw; 2-Stihl chain saws; battery charger; alum. ext. ladder; Homelite trimmer; assortment of various hand tools.

**ANTIQUES & COLLECTIBLES:** Horse hames; old wringer washing machine; 4-old metal milking stanchions; wood child's sleds; crocks; jugs; coffee grinder; very old chenille-type bedspread w/lace; Valley Falls Lodge 21 AF & AM Centennial Program 1959, napkin & regalia & a Holy Bible Reference Dictionary Book, a manual of ceremonies, & other items; large collection of Louis Lamore leather bound books; Zane Grey books; large book collection; cast iron toys; toy horse collection; WD 45 toy tractor; and more; Older horse drawn implements & harness pieces; Barbie

The project is the first of its kind in the nation with a non-federal entity dredging sediment from a U.S. Army Corps of Engineers (USACE) reservoir. Three million cubic yards of sediment was removed from the reservoir and placed in confined disposal facilities on USACE land and private property. These disposal sites will be returned to the preferred use of the respective landowners after dewatering.

"In 2012, we started the planning process to conduct this large-scale dredging project to restore water supply storage at John Redmond," said Director of KWO Tracy Streeter. "This project was vital for the area. The reservoir is a supply source to 19 communities and six industrial users, including Wolf Creek Nuclear Operating Station."

The removal of sediment has helped to ensure an adequate water supply to meet our citizens' demand in the future. Unfortunately past drought has shown the removal of three million yards will not solve all of the problems with the aging reservoir to help restore water

supply storage lost to sedimentation.

"Completion of Phase I dredging operations at John Redmond does not signify 'mission accomplished' in efforts to restore lost water supply storage to satisfy projected demand into the future," Streeter said. "Additional work in the watershed above John Redmond to reduce the sedimentation rate, evaluation of other waters supplies as well as future restoration work to remove sediment within the reservoir is still necessary to ensure future water supply demand is met through the year 2045 in the Neosho River basin."

More information and details about the project will be shared at the upcoming Governor's Water Conference on November 14-15 in Manhattan, including a panel discussion involving Bryan Taylor, USACE-Tulsa District, Stan Ekren - GLDD and Matt Unruh - KWO Dredging Project manager.

For additional information on the dredging project or the upcoming conference, visit [www.kwo.org](http://www.kwo.org).

## U.S. pork industry seeks the pig farmers of tomorrow

As National Pork Month draws to a close, the Pork Checkoff is launching a new national awards program to recognize, inspire and connect the next generation of American pig farmers. Through Nov. 22, the National Pork Board is seeking applications from young

producers to become one of the 2017 Pig Farmers of Tomorrow at [www.pigfarmersoftomorrow.com](http://www.pigfarmersoftomorrow.com).

The new award will recognize future farm leaders, ages 18-29, who intend to make pig farming their life's work and are committed to the U.S. pork industry and to raising pigs using the We Care<sup>SM</sup> ethical principles.

"One of the National Pork Board's primary responsibilities is to train and motivate future pork industry leaders," said National Pork Board president Jan Archer, a pig farmer from Goldsboro, North Carolina. "The award is designed to recognize and inspire youth who are investing their time and energy into responsible pig farming."

Up to three award recipients will be selected in the program's inaugural year. Winners will be invited to speak at National Pork Board events, including the March 2017 National Pork Industry Forum in Atlanta. They also will be responsible for providing content via the pork industry's social media program #RealPigFarming. To apply, applicants must be actively involved in raising pigs in the U.S. on a full- or part-time basis and be between the ages of 18-29 as of Jan. 1, 2017. Students currently enrolled in a college program also are encouraged to apply.

Applicants must have a completed Common Industry Audit or be willing to have one conducted and paid for by the National Pork Board. Applicants also must submit social media content defining a "day in the life" on their farm and upload up to ten photos with 140 character descriptions. The National Pork Board selection committee will name up to eight semi-finalists who will be interviewed by a panel of judges to select the finalists. Three winners will be chosen based on a combination of all application materials

"It is important for youth in our industry to make the right connections at the right time as they build a career in agriculture," Archer said. "As the winners share their personal stories, the program will not only recognize these future leaders, but will introduce them to experienced producers and networking opportunities."

Get Your Copy of Grass & Grain Every Week ... Subscribe Today!

Since 1954

**GRASS & GRAIN**

Published by AG PRESS



**CALL (785) 539-7558**

or go online at

**www.grassandgrain.com**

## SELLERS: MR. &amp; MRS. DOUG &amp; DEB LOY

Auction conducted by:



Heart of America  
Real Estate  
& Auction

**www.ucnortheastkansas.com**

— AUCTIONEERS —

Andy Conser, CAI, UCMA  
Bill Conser & Lance Fullerton, CAI  
**785-806-6921 or 785-863-3322**  
Email: [andy@ucheartofamerica.com](mailto:andy@ucheartofamerica.com)



Partial terms: Cash or bankable check. All items sold as-is, where-is with no guarantees or warranties expressed or implied. Settlement is due day of auction and nothing can be removed until settled for in full. All purchases must be removed day of auction. Statements made at time of auction take precedence over advertisements and previous statements. Full terms on web site.





Members of the 2016 K-State Soils Judging Team include, back row, from left: Mickey Ransom (coach), Benjamin Hamill, Jaret Kluender, Chris Weber, Peter Bergkamp, Jacob Reinecker, Kim Kerschen (assistant coach). Front row: Logan Evers, Keren Duerksen, Erin Bush, Lucas Scott, Tara Wilson, Tessa Zee.

## K-State Soil Judging Team takes top regional honors

Kansas State University's Soil Judging Team won first place in the "Overall Team" and second place in the "Group Judging" categories at the 2016 Region 5 Soil Judging Contest hosted by the University of Nebraska-Lincoln Oct. 9-14.

Erin Bush, senior from Franklin, Indiana, was second high individual, Jacob Reinecker, junior from, Caldwell, Idaho, tied for

sixth, and Logan Evers, junior from Great Bend, tied for 10th.

Other team members include: Jaret Kluender, senior, Perryville, Missouri; Benjamin Hamill, senior, Newton; Chris Weber, junior, Hoxie; Tessa Zee, junior, Erie, Colorado; Keren Duerksen, sophomore, Newton; Tara Wilson, sophomore, Highland, Michigan; Peter Bergkamp, freshman,

Garden Plain; and Lucas Scott, freshman, Olathe.

The Soil Judging Team was coached by Mickey Ransom, K-State professor of agronomy, and assistant coach, Kim Kerschen, instructor and academic coordinator in agronomy.

The contest is an activity of the American Society of Agronomy and the Soil Science Society of America.

## Federal court dismisses dietary guidelines challenge

The Physicians Committee for Responsible Medicine, an animal activist group which promotes a vegan lifestyle, filed a complaint in January against the USDA and Department of Health and Human Services saying that the groups allowed too much food industry influence on the Dietary Guidelines Advisory Committee's crafting of the 2015 Dietary Guidelines. The lawsuit has been dismissed by a federal court on

the grounds that the complaint was non-justiciable and that there are no existing guidelines for determin-

ing how much industry influence is too much in circumstances such as this.

## Kansas milk production sees 6 percent increase

Milk production in Kansas during September 2016 totaled 268 million pounds, up 6 percent from September 2015, according to the USDA's National Agricultural Statistics Service. The average number of milk cows was 146,000 head, 3,000 head more than September 2015. Milk production per cow averaged 1,835 pounds.

Catalogs  
Sale Flyers  
Magazines  
Calendars  
Brochures  
Books  
Newspapers

  
Call today  
and ask for  
Sandra for  
all your  
printing  
needs.

785 539-7558

## REAL ESTATE AUCTION

**SATURDAY, NOVEMBER 19 — 10:30 AM**  
3996 E. Stimmel Road — NEW CAMBRIA, KANSAS  
4 minutes East of Salina

**OPEN HOUSE: Sunday, November 6, 2:30-5 PM**

### FEATURES OF PROPERTY

Going down a country lane in the back of almost 3.5 acres is a lovely 3 bedroom, 2 bath home with cupola. Over 1,700 sq. ft. and a very desirable open floor plan. Includes an enclosed area for spa or porch or office. Updated Kitchen & Baths. The basement is finished in barn wood for a lovely country appeal. 2 Car Garage.

*Enjoy the peace and tranquility this home has to offer!*

**TAXES:** 2015 Property Tax \$2276.92. **YEAR BUILT:** 1975

**TERMS ON PROPERTY:** A 2.5% Buyers premium will be added to the final bid. 10% down day of auction and sign sales agreement. Balance due in certified funds at closing on or before December 20, 2016 upon merchantable title. Home sold in as-is condition. No warranties expressed or implied by Coldwell Banker Antrim-Piper Wenger REALTOR® or Seller. All inspections including lead based paint inspection are to be completed prior to auction at Buyer's expense if requested. Title Insurance shared equally between Buyer and Seller. Taxes prorated to closing. Buyer to produce preapproved letter from lender. Sale is not contingent on the buyers obtaining financing. Auction price to be approved by seller.

Announcements day of auction take precedence over printed material.

**Designated Sellers Agent: Mark Baxa REALTOR®**  
**Coldwell Banker; Antrim-Piper Wenger REALTORS®**  
**Auction conducted by Mark Baxa REALTOR®/Auctioneer**  
631 East Crawford, Salina, KS 67401  
785-827-3641 or cell 785-826-3437  
mbaxa@cbsalina.com



### ON SITE AUCTION

**Personal Property to sell after sale of home at 10:30 AM**

**SELLER: LARRY & GENERA FARMER TRUST**

**Tractor/PU:** TO 30 Massey Ferguson fresh running rear tires, converted 12v, 93 Toyota king cab p/u 4x4 w/new timing chain, 5 speed, Evinrude 90hp motor for repair, shopmate bench, Whirlpool refrigerator, Craftsman tool box and shop vac, 30K BTU kerosene heater, 2 row lister, 8' cultivator, Dearborn rear scoop and 2 bottom plow, 7' blade, LP 60" 3 pt. finishing mower, popup camper, 50" riding mower w/18hp Kohler w/lots of Att., gas cans, yard tools, Lincoln welder, air compressor, log splitter kit, lawn mower, draw bar, 3 pt. rear lift, sledge, ax, wedges, mosquito fogger, jack stands, 67 Mustang fenders, carport, AG Fab vacuum for mower, 25 gallon Femco sprayer & much more!

**Terms:** Cash or a good check.

Announcements made day of sale take precedence.

**BAXA AUCTIONS, Mark Baxa Auctioneer, 785-826-3437**  
**Go to KSAL.com for full Auction Info & Pictures!**

## Marysville Livestock Sales

**Every Thursday at 12 Noon**

**Donnie Kirkham, Manager • 785-562-1015**  
**1180 US Hwy. 77, P. O. Box 67, Marysville, KS 66508**

**SALE INFORMATION FOR OCTOBER 27, 2016**

CALVES BY THE HEAD			
MCFARLAND	4 HOL STR	\$260.00	
BURCHARD,NE	1 BLK HFR	\$220.00	
BERN	1 BLK HFR	\$210.00	
FRANKFORT	1 BLK HFR	\$180.00	
FRANKFORT	1 BLK HFR	\$160.00	
STEERS			
FILLY, NE	4 XBRD STR	396@\$137.00	
BLUE SPRINGS,NE	6 XBRD STR	485@\$137.00	
WATERVILLE	48 BLK STR	796@\$135.50	
MORROWVILLE	9 XBRD STR	467@\$134.50	
WYMORE,NE	6 BLK STR	519@\$133.00	
WYMORE,NE	4 BLK STR	432@\$132.50	
BARNES	8 BLK STR	737@\$131.75	
BEATRICE,NE	3 XBRD STR	523@\$131.00	
BAILEYVILLE	16 BLK STR	714@\$130.25	
BEATRICE,NE	6 BLK STR	719@\$129.50	
WATERVILLE	4 BLK STR	676@\$128.50	
BARNES	2 XBRD STR	490@\$128.00	
GREENLEAF	113 BLK STR	968@\$127.60	
WESTMORELAND	31 BLK STR	830@\$127.25	
MARYSVILLE	7 RED STR	743@\$127.00	
FILLY, NE	1 BLK STR	460@\$126.00	
BAILEYVILLE	35 BLK STR	800@\$125.75	
BLUE RAPIDS	2 BLK STR	765@\$124.50	
FRANKFORT	16 BLK STR	718@\$124.50	
SENECA	6 XBRD STR	582@\$124.00	
BREMEN	1 RED STR	750@\$123.50	
FRANKFORT	7 BLK STR	612@\$122.50	
BARNES	13 XBRD STR	613@\$122.25	
MORROWVILLE	73 XBRD STR	569@\$122.00	
MARTELL,NE	4 XBRD STR	847@\$121.00	
BLUE RAPIDS	2 BLK STR	847@\$120.75	
BARNES	2 MIX STR	692@\$118.50	
BEATRICE,NE	1 BLK STR	595@\$118.50	
MORROWVILLE	12 XBRD STR	656@\$117.50	
BERN	12 BLK STR	585@\$117.00	
MARYSVILLE	3 RED STR	643@\$116.50	
BERN	21 BLK STR	668@\$116.00	
SENECA	9 XBRD STR	678@\$115.25	
BEATRICE,NE	1 BLK STR	905@\$115.00	
BEATRICE,NE	6 BLK STR	716@\$114.50	
BARNES	6 XBRD STR	710@\$114.50	
BURCHARD,NE	1 BLK BULL	590@\$113.50	
WATERVILLE	2 CHAR STR	1,022@\$105.50	
BEATRICE,NE	1 XBRD STR	710@\$105.00	
BEATRICE, NE	1 WF BULL	630@\$102.00	
BEATRICE,NE	2 BLKX STR	612@\$100.50	
MCFARLAND	13 JERS STR	298@\$67.00	
MORROWVILLE			
MORROWVILLE	49 XBRD HFR	523@\$110.00	
MARYSVILLE	1 BWF HFR	565@\$109.00	
BEATRICE,NE	4 BLK HFR	656@\$108.50	
MORROWVILLE	20 XBRD HFR	577@\$108.00	
BEATRICE,NE	3 BLK HFR	673@\$105.50	
BEATRICE,NE	4 XBRD HFR	631@\$105.00	
BEATRICE,NE	5 XBRD HFR	525@\$100.00	
LINN			
LINN	1 BLK HFRETTE	915@\$110.00	
BERN	1 BLK HFRETTE	880@\$103.00	
LINN	1 BLK HFRETTE	1,080@\$95.00	
BLUE RAPIDS	1 BWF HFRETTE	845@\$93.50	
MORROWVILLE	2 BWF HFRETTE	890@\$92.50	
MARTELL,NE	1 BWF HFRETTE	965@\$90.50	
MARYSVILLE	1 BLK HFRETTE	980@\$93.00	
MUSCOTAH			
MUSCOTAH	1 BLK COW	1,180@\$67.00	
BARNES	1 BLK COW	1,525@\$64.50	
MUSCOTAH	1 BLK COW	1,375@\$63.50	
RANDOLPH	1 BLK COW	1,535@\$63.50	
MUSCOTAH	1 BLK COW	1,440@\$63.00	
MUSCOTAH	1 BLK COW	1,275@\$62.50	
BARNES	1 XBRD COW	1,805@\$62.50	
MORROWVILLE	1 RED COW	1,330@\$61.50	
MUSCOTAH	1 BLK COW	1,360@\$61.00	
CENTRALIA	1 XBRD COW	1,350@\$60.50	
MORROWVILLE	1 RED COW	1,430@\$60.50	
WASHINGTON	1 BLK COW	1,350@\$60.50	
MORROWVILLE	1 RED COW	1,510@\$60.00	
CENTRALIA	1 RED COW	1,145@\$59.00	
CENTRALIA	1 RED COW	1,305@\$58.50	
BERN	1 RED COW	1,255@\$57.00	
BEATRICE,NE	1 BWF COW	1,295@\$56.00	
WATERVILLE	1 WF COW	1,395@\$55.50	
MORROWVILLE	1 RED COW	1,590@\$55.50	
HANOVER	1 BLK COW	1,555@\$55.50	
WASHINGTON	1 BLK COW	1,200@\$55.50	
CENTRALIA	1 RED COW	1,120@\$55.00	
BREMEN	1 BLK COW	1,150@\$54.50	
MUSCOTAH	1 BLK COW	1,220@\$54.50	
WASHINGTON	1 WF COW	1,335@\$53.00	
BLUE RAPIDS	1 XBRD COW	1,280@\$52.50	
MARYSVILLE	1 BWF COW	1,435@\$52.00	
BURCHARD,NE	1 WF COW	1,135@\$52.00	
HOPE	1 XBRD COW	1,460@\$52.00	
BEATTIE	1 HOL COW	1,540@\$50.00	
CENTRALIA	1 RED COW	1,270@\$50.00	
WASHINGTON	1 BLK COW	1,260@\$50.00	
BEATTIE	1 HOL COW	1,140@\$50.00	
SOLDIER			
SOLDIER	1 BLK BULL	1,765@\$82.00	
SENECA	1 BLK BULL	2,040@\$73.00	
EARLY CONSIGNMENTS FOR 11/3/2016			
35 BLK 1ST CALF HFERS CALVE FEB. 1			
20 BLK COWS - Spring calvers, Running ages			
3 BLK PAIRS 1ST CALF HFERS			
12 BLK STRS/HFRS	500-550#	V	HR
65 BLK STRS/HFRS	500-550#		
23 MIX STRS/HFRS	500-600#	WV	HR
85 CHAR STRS/HFRS	550-600#	V	HR
95 BLK STRS/HFRS	550-700#	WV	HR
65 red & blk baldy STRS/HFRS	500-700#	WV	HR
84 MIX STRS/HFRS	700-800#	WV	OG
61 BLK STRS/HFRS	700-850#	WV	HR
58 BLK STRS	900-925#	WV	OG
HOLSTEIN SPECIAL - NOVEMBER 10			
FIELDMEN			
Jim Dalinghaus	Dave Bures, Auctioneer	Jeff Cook	Greg Anderson
785-799-5643	402-239-9717	785-564-2173	785-747-8170
Baileyville, KS	Odell, Nebraska	Hanover, KS	Waterville, KS
Barn Phone • 785-562-1015			Frankfort, KS
			www.marysvillivelivestock.com

## AUCTION

**SUNDAY, NOVEMBER 6 — 10:30 AM**  
**Auction Location: Civic Center, 201 NW 2nd — ABILENE, KS**



### COINS TO START SELLING AT 10:30

Approximately 260 lots of silver & gold coins & bullion including: 1803 Heraldic Eagle dollar; CC Morgans 1889, 1882, 1881, 1891, 1878; 200+ silver rounds; 100 oz. silver bar; Lincoln cents- 1909S, 1914D; 1000+ silver quarters; 190+ 1/2 dollars; 100+ Morgans; 130+ Peace dollars; (3) 10 oz bars; rolls of unc 1922 Peace dollars; 1895 \$20 gold; 1875 California \$1 gold piece; (2) 1980 Krugerrands; 18930, 1893, 18950 Morgan Dollars; 1/2 cents. **Many more, call for a complete coin brochure or go to kansas.auctions.net.**

### GOLD & SILVER ITEMS

Sets of sterling; Wallace sterling in celluloid case (107 pcs); Alvin Sterling in wood case (12 place set); Reed & Barton sterling in wood case (1941 French Renaissance, 8 place set); Oneida Tudor silverplate in wood case (12 place set); other sterling & silverplate items; Rolex oyster perpetual watch (chronometer) ?; watch with lg 14K watch band; 3 Mason rings w/diamonds; gold & silver jewelry, some with gems; old cameo on gold filled chain; Ivory type rose on ivory type chain. **Many other pieces of jewelry not listed.**

### COLLECTIBLES: (Approx. Noon)

Approximately 100 year old oil painting on canvas, copy of Guido Reni's Veronica at the crucifixion; 2 Charles H. Sanderson; 1935 photo of Shriner Clown band & slaves; Canvas of Spanish boats by Bilmen; Birger Sandzen prints; Glassware; blue opalescent 9 goblets, pitcher, 5 bowls, 1 nappy & other pieces; American Fostoria footed cake plate & large under plate; Lariat handled candle holder, punch bowl with under plate; 50 pieces Churchill England Blue Willow; 8 place



setting of Wedgwood dinner ware; Cobalt blue decanter set; 12 place setting Bavaria china; Candlewick sandwich tray; monk cookie jar & salt/pepper; Flow Blue plate, cup & bone dishes; Ruby Red compote, sugar, creamer & cruet; pieces of custard glass, green Depression, Bavaria, Majolica, Bohemia, Gorham, Mikasa, lead crystal pieces w/label still on; Northwood white carnival glass dish; milk glass powder dish & other milk glass items; Tom & Jerry punch bowl set; 4 piece white Federal mixing bowl set; Hampshire pottery tea pot, creamer & sugar; Fenton ribbon 3 tier plate; cigar jar w/tin lid;



many brass & crystal candle holders; glass figurines; Duckwall Bros. juice glass; ornate metal desk ink well set; small Kingsley enamel pill box w/gold trim; Oriental items; plastic Electrolux sweeper bank, auto & train banks.

**AUCTIONEERS NOTES: This is only a partial listing of the things that are to liquidate!**

**SELLER: DR. FRANK HOLTZ TRUST**

**TERMS & CONDITION:** Cash or personal check with proper ID. All items must be paid for before removal. Statements made day of auction take precedence over printed material.

*Independent Cashier: Diane Lykins*

**For pictures & complete listing go to kansasauctions.net**

**REYNOLDS AUCTION SERVICE**

**ABILENE & CLAY CENTER**

**RANDY REYNOLDS: 785.263.5627**  
landmanrj@gmail.com



# Kansas Hay Market Report

Hay trade continues to be slow. Demand moderate for alfalfa pellets, light for all other classes of hay, prices steady. Harvest continues to be a warm and dry one. Above normal temperatures have been felt across the state and several areas have not seen rain in almost two months. Some southwestern area producers are dusting in winter wheat, while others are holding off on sowing due to a lack of soil mois-

ture. The dry and warm conditions have rapidly pushed the western half of the state into either abnormally dry or drought conditions once again.

According to the U.S. Drought Monitor, the abnormally dry (D0) category increased to 29.35 pct and moderate drought (D1) is at 3.07 pct. The NASS Kansas Crop Progress and Condition report for the week ending October 23, 2016 stated that pasture and range conditions rated 1 pct very poor, 4 pct poor, 25 pct fair, 58 pct good and 12 pct excellent. If you have hay for sale, pasture to rent or need hay and/or grazing, use the services of the Hay and Pasture Exchange: [www.kfb.org/commodities/haypasture/index.html](http://www.kfb.org/commodities/haypasture/index.html)

## Southwest Kansas

Dairy alfalfa, grinding alfalfa and ground and delivered, steady, movement slow. Alfalfa: Horse, small squares 220.00-250.00. Dairy, .80-.90/point RFV, Supreme 150.00-165.00, Premium 135.00-165.00, Good 120.00-150.00. Stock or Dry Cow alfalfa, 80.00-100.00. Fair/ Good grinding alfalfa, 55.00-70.00. Ground and delivered locally to feedlots and dairies, 100.00-105.00, instance of new crop at 115.00. The week of 10/16-10/22, 9,574T of grinding alfalfa and 522T of dairy alfalfa were delivered. Sudan, large rounds 60.00 delivered locally. Corn stalks, large rounds 45.00-55.00 delivered locally, ground and delivered 80.00-85.00. Straw, mid squares, 50.00-55.00.

## South Central Kansas

Dairy, grinding alfalfa, alfalfa pellets, alfalfa ground and delivered steady, movement slow. Alfalfa: Dairy, .65-.80/point RFV, Supreme 120.00-155.00, Premium 110.00-

155.00, Good 95.00-135.00. Stock cow alfalfa, 100.00-110.00. Fair/ Good grinding alfalfa, 55.00-65.00 edge of the field, 70.00-85.00 delivered locally. Ground and delivered locally to feedlots 100.00-105.00, instance of 110.00. The week of 10/16-10/22, 3,897T of grinding alfalfa and 638T of dairy alfalfa were delivered. Alfalfa pellets: Sun Cured 15 pct protein 135.00-140.00, 17 pct protein 140.00-150.00, Dehydrated 17 pct 205.00-210.00. Grass hay: bluestem, mid and large squares none reported, large rounds 65.00-70.00. Corn stalks, ground and delivered 55.00-65.00. Oat hay, large rounds 65.00-70.00. Straw, large rounds, 50.00-60.00.

## Southeast Kansas

Alfalfa, brome, prairie hay steady, movement slow. Alfalfa: Horse or Goat, none reported. Dairy and Stock Cow .80 to .90/point RFV. Good grinding alfalfa 55.00-60.00. Ground and delivered, 80.00-90.00. Grass hay: bluestem, small squares 100.00-110.00. Good, mid and large squares 65.00-85.00, large rounds 55.00-70.00. Brome: small squares 130.00-135.00. Good, mid and large squares, 90.00-110.00, large rounds, none reported. Straw, mid squares 50.00-60.00. Grass Mulch, large rounds 40.00-50.00. Fescue, large rounds 20.00-30.00 delivered locally.

## Northwest Kansas

Dairy alfalfa, grinding alfalfa steady, movement slow. Alfalfa: Horse/Goat, small squares 225.00-275.00 delivered locally. Dairy, Premium/Supreme .80-.95/point RFV. Stock cow, fair/good 100.00-110.00. Good, large rounds 75.00-85.00. Fair, grinding alfalfa 65.00-75.00. Ground and delivered locally to feedlots and dairies 100.00-105.00.

## North Central-Northeast Kansas

Dairy alfalfa, grinding alfalfa, prairie hay and brome steady, movement slow. Alfalfa: Dairy .80-.95/point RFV, Supreme 150.00-175.00. Premium 135.00-175.00, Good 120.00-160.00, small squares 10.00/bale. Stock Cow, good 100.00-125.00. Fair/Good, grinding alfalfa 65.00-75.00. Ground and delivered 95.00-120.00. Grass hay: bluestem, small squares 6.00/bale delivered locally, large squares 75.00-90.00, large rounds 45.00-55.00. Brome: Good, small squares 6.00/bale, 7.00/bale delivered locally, mid and large squares 100.00-120.00, good large rounds 60.00-70.00, fair 50.00-60.00. Sorghum/Sudan, large rounds 60.00-65.00. Straw, good, small squares 4.00/ bale or 5.00/bale delivered, large square bales 60.00-70.00, 75.00-85.00 delivered locally and large rounds 60.00-65.00 delivered locally. CWF grass mulch 65.00 per large round bale.

\*\*\*Prices are dollars per ton and FOB unless otherwise noted. Dairy alfalfa prices are for mid and large squares unless otherwise noted. Horse hay is in small squares unless otherwise noted. Prices are from the most recent sales.

\*CWF Certified Weed Free

\*RFV calculated using the Wis/Minn formula.

\*\*TDN calculated using the Western formula. Quantitative factors are approximate, and many factors can affect feeding value. Values based on 100% dry matter (TDN showing both 100% & 90%). Guidelines are to be used with visual appearance and intent of sale (usage). Source: Source: Kansas Department of Agriculture - Manhattan, KS Kim Nettleton 785 564-6709

Posted to the Internet: [www.ams.usda.gov/mnreports/DC\\_GR310.txt](http://www.ams.usda.gov/mnreports/DC_GR310.txt)

## EMPORIA LIVESTOCK SALE CO.

*Bonded & Insured*

**SALE EVERY WEDNESDAY IN EMPORIA, KANSAS AT 11:00 AM**

**620-342-2425 or 800-835-7803 toll-free • Fax: 620-342-7741**

**Date: 10/26/16 Total Head Count: 865. COWS: \$57-63; \$51-56.75; \$50 & down. BULLS: \$71-76, light test.**

BULLCALVES		3 mix		490@142.00	
3 blk	335@156.00	3 blk		458@140.00	
HEIFERS		9 blk/bwf		593@125.00	
3 blk	343@140.00	5 mix		527@122.00	
4 Char	406@132.00	3 blk		595@120.00	
4 blk	411@131.00	3 mix		647@119.50	
5 mix	482@125.00	6 mix		624@117.00	
5 blk/bwf	500@123.00	5 blk		637@116.00	
4 mix	523@122.00	3 blk/bwf		643@116.00	
4 blk	529@117.00	5 blk		670@116.00	
6 blk	533@116.00	18 blk		689@115.50	
4 mix	560@114.00	4 blk		640@112.50	
5 blk	560@113.00	5 wf		665@106.50	
5 blk	555@107.00	14 blk/bwf		783@130.00	
7 blk	579@107.00	18 mix		740@128.00	
4 mix	568@105.50	41 mix		719@127.00	
4 blk/bwf	599@104.50	13 blk		762@126.75	
5 wf	546@101.00	3 blk		763@126.00	
16 blk	643@105.00	14 blk		714@124.50	
49 mix	751@123.00	6 red		737@117.50	
14 blk	770@122.50	10 blk		815@131.00	
4 blk	789@119.00	14 mix		808@130.00	
4 blk/bwf	708@118.00	9 blk		849@128.75	
5 blk	721@118.00	8 blk/bwf		881@127.25	
10 blk	747@116.50	9 blk		876@127.00	
12 mix	818@121.00	21 blk		894@126.75	
6 mix	982@100.00	8 blk		896@126.75	
STEERS		14 mix		810@125.50	
5 blk/bwf	425@149.00	6 mix		823@114.50	
3 Char	440@142.00	108 blk/bwf		955@124.85	

**CONSIGNMENTS FOR NOV. 2ND:**

- 32 blk str & hfrs, 6 wks weaned, 550-650 lbs
- 320 blk red & Char strs, 800-900 lbs
- 180 blk & Char strs, 850-950 lbs
- 55 blk & bwf strs, 975-1025 lbs

**CONSIGNMENTS FOR NOV. 9TH:**

- 320 blk red & Char strs, 800-900 lbs

**THANK YOU FOR ALL OF YOUR CONTINUED SUPPORT! YOUR BUSINESS ALWAYS APPRECIATED!**

For Cattle Appraisals Call:

BRODY PEAK, 620-343-5107      GLENN UNRUH, 620-341-0607  
 LYLE WILLIAMS, Field Representative, 785-229-5457  
 WIBW 580 - 6:45 A.M. Thurs; KVOE 1400 - 6:30-6:45 A.M. Thurs. & Fri.  
[emporialivestock.com](http://emporialivestock.com)

## LEWIS CATTLE OILERS

**Effective Year-Long  
STOP FLY  
PROBLEMS NOW!**

620-408-6387  
or  
888-256-5544

[USALEWISCATTLEOILERS.COM](http://USALEWISCATTLEOILERS.COM)

*Come See Us At The Wichita Farm Show!*

## FEED THE KEY FEEDS

“The Key To Successful Feeding”

# Anaplasmosis?

## What is the solution?

We have cubes with chlortetracycline.

Call Us Now so we can help you  
maximize your feedstuffs,  
livestock productivity and  
greenbacks in your pocketbook!

## FOURTH & POMEROY ASSOCIATES, INC.

Joseph Ebert, General Manager

P.O. Box 516, Clay Center, KS 67432  
785-632-2141 • WATS 1-800-432-7423

## LaCrosse Livestock Market Inc.

Frank Seidel  
2340 North Highway 183, LaCrosse Kansas 67548

# Annual Special Red Angus Influence Sale

**Friday, November 4th**  
Expecting 1,400 head \*\* Start time 12:30 \*\*

**Early Consignments:**

- 5 total Red Angus Heifer Pairs
- 65 total Red Angus & Red Angus Cross Bred Heifers
- 570 total heifers (125 will be weaned) (445 will be right off the cow)
- 760 total steers (185 will be weaned) (575 will be right off the cow)

-615 steers/heifers will carry either the FCCP or Allied Tag

**All calves will be local and home raised with several fancy replacement quality heifers offered.**

If you have any questions call:  
LaCrosse Livestock Market at 785-222-2586  
or Frank Seidel (owner) 785-650-4919

For a more detailed listing go to [www.lacrosselivestock.com](http://www.lacrosselivestock.com)  
for a link to check out the sale catalog.

\*\*\*\*\*

You can watch the sale live at [www.lmauctions.com](http://www.lmauctions.com).

If interested in bidding online,  
please register by November 2nd!

## See you at the Sale!!!

## JC LIVESTOCK SALES INC.

**Wednesday Sale, Hogs NOON • Cattle 12:30 PM**

For the week of October 26, 2016:

STEERS		3		637		113.50	
4	471	135.00	1	1025			106.00
14	804	133.00					
8	524	129.75					
60	870	129.75					
18	665	129.00					
19	827	124.00					
11	794	122.50					
5	818	120.50					
25	949	120.00					
9	954	119.75					
1	1010	110.00					
HEIFERS							
11	760	122.00					
3	537	120.00					
10	648	118.75					

**TOP BUTCHER COW**  
\$64.00 @ 1,140 lbs.

**TOP BUTCHER BULL**  
\$77.50 @ 2,195 lbs.

**BRED COWS: \$725-\$950**

**PAIRS: No Test**  
**FAT HOG TOP: No Test**  
**SOWS: No Test**

**PIGS: \$25.00 @ 298 lbs.**

**FEEDER PIGS:**  
\$19.00 @ 38 hd.

**2nd SPECIAL CALF SALE: Monday October 31, 6 PM**

140 Angus Strs/Hfrs .....500-700 lbs.....Weaned

104 Angus X Strs/Hfrs .....500-700 lbs.....Weaned

39 Angus X Strs/Hfrs .....500-700 lbs.....Weaned

140 Char X Strs/Hfrs .....400-650 lbs.....Pre-Vacc.

20 Angus X Strs/Hfrs .....500-675 lbs.....Spring Shots

20 Angus X Strs/Hfrs .....600-700 lbs.....Spring Shots

25 Angus X Strs/Hfrs .....600-700 lbs.....Spring Shots

15 R.A. X Hfrs .....550-600 lbs.....Weaned

**PLUS MANY MORE BY SALE TIME!**

If you need assistance in marketing your cattle please call & we will be happy to discuss it with you.

**Visit our new website at [jccclivestock.com](http://jccclivestock.com)**

**JUNCTION CITY, KANSAS • Barn Phone 785-238-1471**  
Seth Lauer 785-949-2285, Abilene

**Clay Center, Ks • Barn Phone 785-632-5566**  
Clay Center Field Representatives:  
Tom Koch, 785-243-5124      Lance Lagasse, 785-262-1185

**KARL LANGVARDT**      **MITCH LANGVARDT**      **LYNN LANGVARDT**

785-499-5434      785-238-1858      785-762-2702  
Cell: 785-499-2945      Cell: 785-761-5814      Cell: 785-761-5813

## CLAY CENTER LIVESTOCK SALES INC.

**Cattle sales Tuesday, 11:00 AM.**

For the week of October 25, 2016:

STEERS		4		433		115.00	
1	380	149.00	1	660			113.00
4	429	131.00	3	738			111.00
39	859	126.50	7	884			110.00
3	790	122.00	1	970			103.50
9	542	121.50					
4	593	118.50					
6	642	118.50					
11	981	116.25					
5	970	115.00					
HEIFERS							
1	325	122.00					
2	458	117.00					

**Top Butcher Cow:**  
\$63.75 @ 1,545 lbs.

**Top Butcher Bull:**  
\$82.00 @ 2,375 lbs.

**Bred Cows: \$800**  
**Pairs: No Test**

**SPECIAL CONSIGNMENTS FOR TUESDAY, NOV. 1:**  
80 Ang & bwf 1st calf spring bred hfrs, AI bred to Lyons Confidence (CED +13; BW -.3), cleaned up with Lyons Sons of Dash & Thunder  
30 Angus ... 3-8 yr old spring bred cows  
10 Angus ... 3-8 yr old fall bred cows  
All above cows are bred to Lyons Angus Bulls  
PLUS MORE BY SALE DAY!

**CONSIGNMENTS FOR SHEEP & GOAT SALE: SAT, NOV. 5:**  
Hay & Equipment at 11 AM  
- 100 small square wire tied Prairie Hay  
- Various gates, panels and equipment  
Sheep and Goat Sale at 12:00  
• 25 Dorper X bred ewes (4 Solid Mouth)  
• 1 Registered Boer Billy  
• 11 Bred Boer Nannies (some w/papers) Complete Disp.  
For even more consignments for upcoming Sheep & Goat Sales, join the Clay Center Livestock Sheep & Goat Sales group on FACEBOOK!

## Central Livestock

811 N. Main St.  
South Hutchinson, KS

[www.centrallivestockks.com](http://www.centrallivestockks.com)

Office: 620-662-3371  
or Matt Hoffman (Owner): 620-727-0913

Hay Auction- Every Tuesday at 900 a.m.  
Cattle Auction- Every Tuesday at 10:00 a.m.  
Hog/Sheep/Goat Auction- Every 3rd Saturday

**Results From Oct. 25th Sale:**

Steers:		600-700		\$85.00-\$113.00	
300-400	\$133.50-\$149.00	700-800			\$95.00-\$117.00
400-500	\$140.00-\$152.00	Holstein Steers:			
500-600	\$125.00-\$132.00	300-400			\$61.00-\$87.00
600-700	Light Test	400-500			\$49.00-\$75.00
700-800	\$115.00-\$127.00	500-600			\$51.00-\$64.00
800-900	\$113.00-\$120.00	600-700			\$47.50-\$71.00
Heifers:		700-800		\$47.50-\$72.00	
300-400	\$120.00-\$145.00	800-900			\$48.50-\$73.00
400-500	Light Test	900-1000			\$60.00-\$73.00
500-600	\$101.00-\$116.00				

**11/08/16- Calf/Yearling Special**  
**11/19/16- Hog/Sheep/Goat Sale**  
**11/22/16- Holstein Special**



## Kansas cattle on feed up 10 percent

Kansas feedlots, with capacities of 1,000 or more head, contained 2.22 million cattle on feed on October 1, according to the USDA's National Agricultural Statistics Service. This inventory was up 10 percent from last year.

Placements during September totaled 420,000 head, up 5 percent from 2015. Fed cattle marketings for the month of September totaled 360,000 head, up 13 percent from last year. Other disappearance during September totaled 10,000 head, unchanged from last year.



Allison Whitebread, Holland Sunflowers, led the reserve champion breeding doe at the Central Kansas Free Fair. She is shown with judge Rocky Swearingen.

### BELLEVILLE 81 LIVESTOCK SALES

Junction Hwys 36 & 81 Belleville, Kansas

**CATTLE SALES EVERY FRIDAY • 10:30 AM**

October 28 sale. Slaughter cows = Poor-Crip Cows, \$25-\$50; Better Cows, \$52-\$68; Bulls to \$78.

<b>STEERS</b>	720@122.50	600@117.00
515@\$136.50	754@130.00	622@112.00
533@\$138.50		653@112.50
605 Here@124.00	<b>HEIFERS</b>	717@116.00
633@125.00	485@131.00	741@113.00
653@126.00	513@133.25	758@111.00
701 Here@122.00	547@127.50	
Full Load		

**NOVEMBER 4th FEEDER SALE: 10:00 COWS**  
25 blk red strs, 850 lbs.; 165 CharAngus x strs & hfrs, 700-825 lbs.; 24 blkwfr strs, 750 lbs.; 10 blk, 400-500 lbs.; 50 blk blkwfr strs & hfrs, 500-650 lbs.; 80 blk red Char x, 375-575 lbs.; 12 blk, 600-650 lbs.; 20 Red SimmX strs & hfrs, 700-800 lbs.; 30 blk, 500-600 lbs.; 23 blk strs, 550-750 lbs.

**NOVEMBER 11 & 18 Feeder Sales ... Consign Now!**

**Goat-Sheep Sale: Saturday, Nov. 19 • 2:00 PM**

**ANNIVERSARY CATTLE SALE: FRIDAY, DECEMBER 2**  
Get on the List!

For Market Reports, and Early Listings  
Website: **Belleville81.com**

Barry & Angii Kort, Owners • 785-527-2258  
Thanks for your business!

## EL DORADO LIVESTOCK AUCTION, INC.

**316-320-3212**

Fax: 316-320-7159

2595 SE Highway 54, P.O. Box 622,  
El Dorado, KS 67042

**Market Report - Sale Date 10-27-16. Head count: 1651.**  
300-400 lb. steers, \$95-\$141; heifers, \$90-\$135; 400-500 lb. steers, \$92.50-\$133; heifers, \$90-\$121; 500-600 lb. steers, \$90-\$128; heifers, \$90-\$118; 600-700 lb. steers, \$90-\$121.50; heifers, \$90-\$111.50 700-800 lb. steers, \$80-\$115. Trend on Calves: Choice steer & heifer calves, steady to \$4 higher. Trend on Feeder Cattle: Not enough feeder steers & heifers for a good market test. Butcher Cows: High dressing cows: \$45-\$61; Avg. dressing cows: \$35-\$45; Low dressing cows: \$20-\$35. Stock Cows: Bred Cows \$750-\$1575; Cow/Calf Pairs: \$900-\$2350. Butcher Bulls: Avg. to high dressing bulls \$67.50-\$78. Trend on Cows & Bulls: Butcher cows, \$2 lower; Butcher bulls, \$3 lower.

**Thank you to everyone that came out & made our cow sale a success!!!**

**We welcome your consignments!**

If you have cattle to consign or would like additional information, please call the office at 316-320-3212

Check our website for updated consignments:  
[www.eldoradolivestock.com](http://www.eldoradolivestock.com)

<b>Chris Locke</b>	<b>Steven Hamlin</b>
(316) 320-1005 (H)	(602) 402-6008 (H)
(316) 322-0675 (M)	(620) 222-1199 (M)
<b>Larry Womacks, Fieldman</b>	<b>Van Schmidt, Fieldman</b>
(620) 394-3273 (H)	(620) 367-2331 (H)
(620) 229-0076 (M)	(620) 345-6879 (M)

**Cattle Sale Every Thursday 11:00 AM**

## USDA issues safety-net payments to Kansas farmers in response to 2015 market downturn

USDA Kansas Farm Service Agency (FSA) executive director, Adrian Polansky announced that many Kansas farms that enrolled in safety-net programs established by the 2014 Farm Bill will receive financial assistance for the 2015 crop year. The programs, known as Agriculture Risk Coverage (ARC) and Price Loss Coverage (PLC), are designed to protect against unexpected drops in crop prices or revenues due to market downturns.

"These safety-net programs provide help when price and revenues fall below normal, unlike the previous direct payments program that provided funds even in good years," said Polansky. "These payments will help provide re-assurance to Kansas farm

families, who are standing strong against low commodity prices compounded by unfavorable growing conditions.

Statewide, about 101,000 farms enrolled in the 2015 ARC-County and PLC programs. Total dollars issued so far to Kansas producers through these contracts is more than \$341 million.

"ARC-County payments can vary county to county because average county yields will differ," said Polansky. "PLC payments

are determined nationwide based on the difference between a commodity's market year average price and the USDA-established reference price. This resulted in PLC payment rates per bushel of .09 for corn and .64 for grain sorghum."

More details on the price and yield information used to calculate the financing assistance from the safety-net programs is available on the FSA website at [www.fsa.usda.gov/arc-plc](http://www.fsa.usda.gov/arc-plc) and [www.fsa.usda.gov/ks](http://www.fsa.usda.gov/ks).

**AG PRESS**  
785-539-7558

**Call us for:**  
Catalogs • Sale Flyers • Magazines  
Calendars • Brochures • Books • Newspapers  
**Ask for Sandra**

**WASHINGTON COUNTY LIVESTOCK, LLC**  
Locally owned & operated  
WASHINGTON, KS – PHONE 785-325-2243  
Fax: 785-325-2244  
**\*\*Sale Every Monday at 1 PM\*\***  
**If you have cattle to sell, please call us anytime!**

**Results from 10-24-16**

<b>BULLS</b>	1 black	980@77.00	
1 red	1120@84.00	1 black	1030@71.00
1 black	1640@76.50	1 black	1595@59.50
		1 Charolais	1540@53.50
<b>COWS</b>	1 black	1490@53.00	
1 black	950@90.00	1 red	1325@53.00
1 black	1080@81.00	1 red	1315@52.00

**Don't Forget the Video as an option to market your cattle**

**View our live auctions at [www.lmauctions.com](http://www.lmauctions.com)**

**Manager: Matt Kruse, 785-556-0715**  
**Fieldman: Terry Ohlde: 785-747-6554**  
**View our website for current market report!**  
**[www.washingtoncountylivestock.com](http://www.washingtoncountylivestock.com)**

**Eureka Livestock Sale**  
P.O. Box 267 Eureka, KS 67045  
620-583-5008 Office 620-583-7475  
**Sale Every Thursday at 11:30 a.m. Sharp**

On Thursday, Oct. 27, we had 967 hd of cattle on a \$4-8 higher market.

<b>STEERS</b>	7 bk/bwf 669@118.50	3 blk 990@115.00
41 bk/red 733@133.75	6 bk/bwf 642@118.00	3 blk 543@114.25
60 bk/Char 858@130.75	4 bk/red 1119@115.00	7 bk/bwf 712@113.00
12 blk 545@130.75	10 bk/bwf 746@113.50	5 bk/bwf 842@112.00
4 blk 604@130.00	6 bk/bwf 801@111.00	9 bk/bwf 619@111.50
60 bk/bwf 890@129.00	<b>HEIFERS</b>	9 bk/bwf 614@110.25
60 bk/bwf 838@128.75	6 blk 456@133.00	6 bk/bwf 633@109.00
4 bwf/rbf 431@128.00	2 bwf 440@130.00	6 bk/bwf 603@109.00
54 red/Char 903@127.25	10 bk/bwf 769@121.50	21 bk/bwf 649@108.50
12 blk 831@126.00	5 bk/bwf 893@119.50	4 blk 1035@116.50
6 bk/bwf 616@124.50	7 bk/bwf 417@118.50	4 bk/bwf 1139@113.00
12 blk 611@123.50	3 blk 508@118.00	<b>BULLS</b>
11 bk/red 736@123.50	5 blk 942@117.00	2 blk 335@136.00
60 bk/bwf 926@120.10	5 bk/bwf 477@116.00	2 blk 443@125.50
27 Char 966@120.00	4 bk/bwf 706@116.00	2 blk 675@104.50
31 mix 908@118.75	4 blk 429@116.00	4 bwf 363@120.00

**Butcher Cows: \$39-\$66.50, mostly \$54-\$62, steady to \$1 higher.**  
**Butcher Bulls: \$70-\$79.50, mostly \$74-\$78, steady to very active.**

<b>BUTCHER COWS</b>	5 blk/bwf 1298@60.50	<b>BUTCHER BULLS</b>
1 Hols 1765@66.50	1 blk 1895@79.50	
1 blk 1465@64.00	1 blk 2075@78.00	
1 bwf 1600@64.00	1 grey 1795@77.00	
1 blk 1260@63.00	1 blk 1540@77.00	
1 blk 1460@62.00	1 blk 1725@76.00	
1 bwf 1365@62.00	1 blk 1760@75.00	
2 blk/bwf 1278@62.00		
1 Hols 1280@61.00		

**EARLY CONSIGNMENTS FOR NOV. 3**  
• 125 blk rbf bwf strs & hfrs, 450-650 lbs  
• 35 Char x strs & hfrs, 600-750 lbs

**SPECIAL STOCK COW SALE NOV. 10 AT NOON**  
• 50 Fancy red Angus pairs, 2-10 yrs old w/red Angus calves at side  
• 40 Fancy red Angus Spring calving cows, 2-10 yrs old, bred to red Angus bull  
• 25 fancy red Angus Fall open hfrs ready to breed. Complete dispersal from the Mann Ranch  
• 25 big blk bwf Fall pairs, 4-10 yrs old w/Angus calves at side  
• 45 blk bwf cows, 8-10 yr old Spring Calvers bred to Angus bulls.

**CALL WITH YOUR CONSIGNMENTS TODAY!**

**We appreciate your business!**

**Ron Ervin - Owner-Manager**  
Home Phone - 620-583-5385  
Mobile Cell 620-750-0123  
**Austin Evenson - Fieldman**  
Mobile Cell 620-750-0222  
If you have any cattle to be looked at call Ron or Austin

**VALENTINE LIVESTOCK AUCTION CO. Valentine, Neb.**  
Thursday, November 3, 2016  
Special Spring Calf Sale featuring Red Angus  
S.T. 12:30 p.m. Expecting 3,500 hd

#4: 7-way (2), 5-way viral (2), pasteurella, and poured or injected w/Invermectin (fall)  
#3: 7-way (2), 5-way viral (2), pasteurella, no pour on  
#2: 7-way (2), 5-way viral once  
#1: 7-way only

**Weaned Calves: weaned 40 days or more**

240 .....angus & blk (200h-40s) NI hfrs not topped Connealy genes... 475-550# .....Jack & Shane Carr  
170 .....blk-x & blk strs .....650-700# .....Larry, Danny & Craig O'Keif #4  
110 .....blk, bwf (56s-44h) NI .....475-600# .....Swensen Ranch #4  
70 .....blk, blk-x, few rd-x (62h-8s) .....425-525# .....Schmidt & Robinson #4  
46 .....blk (30s-16h) NI .....600-750# .....Doug & Anthony Deibler #2

**Red Angus Sired:**

180 .....rd angus (80s-100h) NI hfrs not topped .....500-575# .....Bill & Karen DeNaeyer #4  
100 .....rd angus (70s-30h) .....450-550# .....Shane & Austin Wobig #4  
100 .....rd angus (70s-30h) NI .....500-575# .....Janousek Farms  
100 .....rd angus strs NI .....500-600# .....Gordon & Michael McLeod #3

**Listings:**

375 .....blk, bwf (180s-175h) NI hfrs not topped .....500-625# .....OE Ranch (Rodarte) #4  
200 .....blk, few bwf NI hfrs not topped .....500-650# .....Mike Pier #3  
155 .....blk & bwf hfrs not topped, sired by Dailey Angus...475-575# .....Wales Rn (Greg & Gale) #2  
95 .....angus hfrs NI breedable .....500-600# .....Lois, Ed & Tony Titus #4  
150 .....rd & blk (65s-85h) NI .....475-500# .....Steven & Shalee Morrison #2  
100 .....blk, few bwf NI .....450-550# .....John Hockenbary & Kyle Qualley #4  
100 .....blk NI .....450-550# .....Joe & Jane Homan #4  
90 .....blk, bwf NI .....450-500# .....Joel Kuhlman #3  
90 .....blk, bwf NI .....500-600# .....Fuzzy & Lanel Stillwell #2  
85 .....blk, few bwf NI .....425-575# .....Garth Carr #4  
70 .....blk NI .....600-700# .....Gene Lurz #2  
64 .....hereford (45s-19h) NI .....500-600# .....Reena King #4  
70 .....angus (46s-24h) NI .....525-650# .....Richard Graeff #2  
60 .....blk strs NI .....500-600# .....Phil, Landon & Luke Miller #4  
50 .....angus & blk hfrs not topped .....550-650# .....Warren & Dawn Dorsey #3  
60 .....blk, few rd NI .....525-625# .....Lazy TUF #4

Plus more from O Box Lvstsk, King, Harris (50), Evergreen & Tetherow (50), Sokol (47), Sherman (60), Farley (60), Frauen (50), Miller (30), Assman (30)

**View our special sales online @ [cattleusa.com](http://cattleusa.com)**  
**Office: 1-800-682-4874 or 402-376-3611**  
Greg Arendt, Mgr., C: 402-376-4701 Greg Nielsen, Fieldman, C: 402-389-0833  
For complete listing visit our website: [www.valentinelivestock.net](http://www.valentinelivestock.net)

**Holton Livestock Exchange, Inc.**  
1/2 mile East of Holton, KS on 16 Highway  
**Livestock Auction every Tuesday at 12 NOON**  
Serving the Midwest Livestock Industry for 64 Years!  
\*\*\*\*STARTING TIME: 12:00 NOON\*\*\*\*

**MARKET REPORT FOR TUESDAY, OCTOBER 25, 2016**  
**RECEIPTS: 775 CATTLE**

<b>STEERS</b>	397@157.00	2 bwf char hfrs	250@137.00
2 blk strs	427@144.00	2 blk bwf hfrs	342@131.00
2 blk strs	410@142.00	3 blk hfrs	353@130.00
6 blk strs	486@142.00	5 blk hfrs	432@129.00
9 blk char strs	537@131.25	6 blk hfrs	449@127.00
6 blk strs	546@130.00	4 blk hfrs	500@125.00
47 mix strs	622@128.00	54 mix hfrs	715@124.85
6 blk strs	721@127.50	9 blk bwf hfrs	635@122.00
7 blk strs	650@127.00	16 blk hfrs	854@121.00
32 mix strs	896@127.00	8 blk hfrs	723@118.50
11 blk bwf strs	746@125.50	5 blk hfrs	594@116.00
9 blk strs	569@124.75	4 blk hfrs	646@115.50
6 blk strs	695@124.50	5 blk hfrs	581@115.00
18 blk bwf strs	715@120.25	7 hefr hfrs	495@114.00
4 blk bwf strs	570@118.00	4 blk hfrs	615@109.50
9 blk strs	637@118.00	18 blk bwf hfrs	649@109.25
7 blk strs	655@114.50	7 blk hfrs	577@109.00
9 hols strs	828@63.00	3 blk bwf hfrs	636@107.00

**NOVEMBER 4-SPECIAL COW & BULL AUCTION--6:30 P.M.**

22 blk 3/4 angus 1/4 simm & 2 rwf 1st calf bred hfrs, OCV, AI bred to Connealy Comrade (71 BW) & Gaffney Game Time (74 BW) for a due date of Jan. 1 with 60 day calving period, clean up bulls are sons of Final Answer (76 BW) & Network (78 BW) 1050-1100 vacc & wormed  
18 blk & red cows/2-8 week fall calves, 6-8 yrs, running back with blk angus bulls  
13 blk cows, 4-aged, bred to blk River Creek simm bull for March 1 calves  
7 blk angus cows/30-60 day old calves, 6-9 yrs

12 blk angus replacement hfrs 800-850 homeraised  
2-20 month blk 5/8 simm 3/8 angus breeding bulls, fertility & trich tested, moderate BW  
19 month Reg. blk angus bull, fertility & trich tested, good disposition  
7-14 month Reg. blk angus bulls LBW (Connealy genetics)  
2-18 month blk angus bulls 65-70 lb. BW +11 & +9 CE EPD fertility & trich tested  
20 month polled hefr bull BW 82 fertility & trich tested  
2-18 month PB blk angus bulls 65-70 lb. BW fertility & trich tested

**Dan Harris, Auctioneer & Owner • 785-364-7137**  
**Danny Deters, Corning, Auct. & Field Rep • 785-868-2591**  
**Dick Coppinger, Winchester, Field Rep. • 913-774-2415**  
**Steve Aeschliman, Sabetha, Field Rep. • 785-284-2417**  
**Larry Matzke, Wheaton, Field Rep. • 785-268-0225**  
**Craig Wischropp, Horton, Field Rep. • 785-547-5419**  
**Barn Phone • 785-364-4114**  
**WEBSITE: [www.holtonlivestock.com](http://www.holtonlivestock.com)**  
**EMAIL: [dan@holtonlivestock.com](mailto:dan@holtonlivestock.com)**  
**View our auctions live at [lmauctions.com](http://lmauctions.com)!**



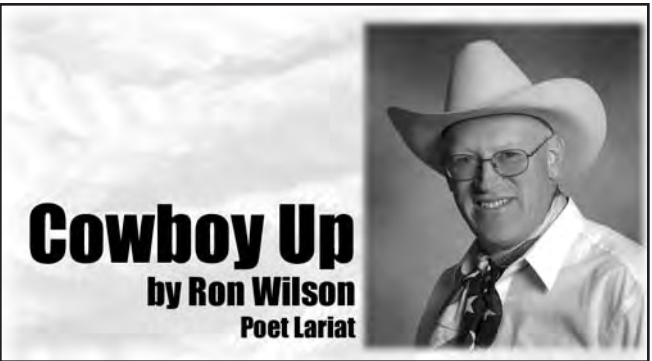

## To the Summit(s)

I have been to the summit. Actually, two of them. Fortunately for me, these were not the kind which required mountain climbing gear or high altitude oxygen packs. These were summits of a different kind: One was the Governor's Summit on Agricultural Growth, coordinated by the Kansas Department of Agriculture, and the second was the K-State Ranching Summit con-

ducted by the K-State Department of Animal Sciences and Industry. Both were excellent recent events.

The Ag Growth summit was kicked off by remarks from Gov. Sam Brownback and Secretary of Agriculture Jackie McClaskey. One of the things I liked about the organization of this meeting was the way that the planners organized the

breakout sessions. First of all, there were lots of breakout sessions so we could weigh in on various topics. In the morning, there were sessions on the topics that one might expect such as wheat, beef, pork, sorghum, dairy, corn, soybeans and other oilseeds, feed and forage. There were also sessions on cotton, poultry, specialty crops, specialty livestock, equipment and technology, food processing, pet food, and Unmanned Aerial Systems (That speaker did not drone on...).

In the afternoon were what they called crossover topics. I liked this too, because so many modern issues don't fit in a little box. They transcend commodities and locations. These over-arching sessions included minor little issues (!) like water, consumer awareness and acceptance, workforce, transportation and logistics, barriers to entry, and global opportunities.

The breakout discussions were facilitated by the excellent staff of the Kansas Department of Agriculture, but the best thing is that they were just that: Discussions. They were not boring lectures. Each session had some informative documents for background, but most of the time was spent discussing the issues among ourselves. The department was really looking for ideas, input, dialogue, and prioritization from the Kansas citizens who participated. Ultimately, we suggested action steps in each area. I thought it was extremely well done.

The other summit I attended was a first for K-State: its first-ever ranching

summit. K-State has offered other events such as Cattleman's Day and Beef Stocker Field Day for decades, but this was a first-time event to focus specifically on ranching. It too was quite well done. The purpose of this summit was somewhat different than the ag growth one, beyond the obvious difference that this one was about ranching specifically. This summit was not about gathering public input, it was more about profit for the individual producer.

Speakers included K-State ag economists as well as ranchers and other experts. One thought-provoking comment was about considering profit per acre, not production per cow. Essentially, this speaker's point was that smaller-framed, easier-carrying cows might generate less pounds per animal but net out at more profit per acre.

At the Ag Growth summit, the best comments I heard came from rancher Matt Perrier of Eureka. In the beef breakout session, he noted that Kansas has every segment of the beef industry, from purebred seedstock to cow-calf production to backgrounders to feedyards. He also made a comment that was a fitting and well-deserved compliment to farm and ranch families. It has to do with the skills, work ethic, and independent problem-solving which farm kids have to learn, growing up on a farm or ranch. Matt said, "Besides protein, we raise something else that the world needs: Kids who can think critically."

That was a mountaintop experience for me.

## Letter to the Editor

I am writing this letter to recommend the re-election of Ron Highland as our State Representative of the 51st District. Ron Highland is a Republican and proud of his Kansas Republican values. I have noticed that his opponent's signs do not even mention that she is a Democrat.

Ron Highland is a gentle man. He makes himself available to listen to the positions and beliefs of his constituents and those appearing before the House Education Committee of which he is the chairman. He is not obligated to follow the dogma of any "special interest" group. But Ron is interested in providing the best possible education for the children of this state. He is not a KNEA member; he is not a school board member, he is not the wife or child of any of those persons and he is not under their control. Therefore he is in a position to evaluate and with objectivity weigh the decisions necessary for the improvement of the Kansas educational system.

Representative Highland understands public education in this state. He grew up the son of a mail carrier in Brewster, Kansas, population under 200 people. For twelve years in that small town he attended grade school and high school in the same building. Then he went to Kansas State University as an undergraduate obtaining a sci-

ence degree followed by graduation from the School of Veterinary Medicine. He then practiced veterinary medicine and returned to K-State and received a doctorate degree in Veterinary Pharmacology. He served as an officer in the United States Army and was wounded in Korea. He worked for many years in research, development and marketing of veterinary drugs.

He probably won't tell you all of this but I can because it reflects upon the knowledge and experience that this man brings to the decision-making process presented in the Kansas Legislature. At age 69 he remains pro-life, a supporter of the second amendment and an advocate for his district. He wants results and achievement in the state's education endeavors which receive over 60% of the state budget. On average the state spends more than \$13,000 per pupil per year in K-12 education. I submit that Ron Highland and his like should make the decision of how much is enough and not legislators beholden to the special interests that already receive 60% of the budget and are using our tax dollars to sue us for more tax dollars. Please join me in voting to re-elect Ron Highland on November 8, 2016.

Respectfully Submitted  
Ed Pugh

## Climbing the Summit

By Ron Wilson, Poet Lariat

I figured going to the summit meant climbing a mountaintop, Till you reach the highest point and you finally get to stop. Here in Kansas, we don't have any mountains all around, So climbing up the Flint Hills is the best that I have found. But we do have summit meetings – it's not a mountain climb, But a chance to come together in a concentrated time. We can focus on things like growing our ag economy, Or helping ranches operate with more profitability. We might get some new ideas or a different point of view, Greet old friends or have the chance to meet someone brand new. It's a chance to learn with others who share our strong beliefs On the importance of farming and those who're raising beef. So I made it to these summits, and like mountain climbers somehow, I've found that from these summits, I can see farther now. Happy Trails!  
www.ronscowboypoetry.com  
© Copyright 2016



Sell  
Or Buy

Cattle

By  
Auction

STARTING TIME  
10:30 AM

Marys  
Tuesdays

We sold 1756 cattle October 25. There was good demand for steer and heifer calves at higher prices. Feeder steers and heifers sold \$2.00-7.00 higher. Cows and bulls remained steady.

STEER & BULL CALVES				
2 blk str	325 @ 150.00	28 blk/red str	781 @ 126.50	
1 blk str	355 @ 147.00	6 blk str	580 @ 126.00	
1 bwf bull	345 @ 145.00	17 blk str	762 @ 126.00	
3 blk bulls	232 @ 140.00	3 blk str	668 @ 125.00	
5 blk/bwf str	453 @ 140.00	5 blk/bwf str	657 @ 124.50	
3 blk str/bulls	378 @ 139.00	5 blk/bwf str	615 @ 123.00	
2 blk/bwf bulls	368 @ 138.00	117 blk/bwf str	907 @ 122.00	
2 blk str	468 @ 136.50	14 blk/bwf str	667 @ 120.00	
3 blk/bwf str/bulls	473 @ 136.50	16 blk/bwf str	720 @ 120.00	
6 blk/char str	536 @ 136.00	4 blk str	783 @ 120.00	
3 blk str	538 @ 134.00	25 blk/red str	860 @ 120.00	
6 blk/bwf str/bulls	493 @ 134.00	6 blk/sim str	619 @ 119.00	
3 red str	462 @ 133.00	16 blk/bwf str	655 @ 119.00	
15 blk/char str	479 @ 132.50	12 w/blk str	601 @ 118.50	
3 bwf/blk str	428 @ 130.00	3 blk/bwf str	618 @ 118.00	
2 bwf bulls	500 @ 129.00	3 x-bred str	618 @ 118.00	
2 char str	538 @ 127.00	607 @ 117.50	24 blk/bwf str	663 @ 117.50
STOCKER & FEEDER STEERS		57 mix str	967 @ 117.10	
11 blk str	554 @ 137.00	52 blk/char str	961 @ 116.85	
111 blk/char str	791 @ 134.20	11 blk/bwf str	677 @ 115.00	
4 blk str	554 @ 132.50	22 blk/char str	905 @ 115.00	
62 mix str	840 @ 132.25	13 blk/red str	934 @ 114.00	
6 blk/sim str	553 @ 129.50	5 blk str	841 @ 110.50	
2 blk str	553 @ 128.50	HEIFER CALVES		
66 blk/red str	844 @ 128.50	1 blk hfr	270 @ 137.00	
67 mix str	740 @ 127.50	3 blk hfr	372 @ 136.00	
4 blk/bwf str	579 @ 126.50	1 blk hfr	350 @ 129.00	
4 red str	584 @ 126.50	3 blk/bwf hfr	400 @ 129.00	

STOCKER & FEEDER HEIFERS	
58 blk/bwf hfr	802 @ 123.25
10 blk/bwf hfr	688 @ 123.00
17 blk/char hfr	582 @ 122.00
12 blk/bwf hfr	617 @ 122.00
12 blk/bwf hfr	786 @ 122.00
9 blk/bwf hfr	711 @ 121.50
130 blk/bwf hfr	830 @ 120.35
70 blk/bwf hfr	830 @ 120.25
119 blk/char hfr	797 @ 118.85
8 blk/bwf hfr	553 @ 117.50
5 blk hfr	667 @ 117.50
41 blk hfr	786 @ 117.50
14 blk/bwf hfr	584 @ 115.00
3 blk hfr	885 @ 115.00
57 blk/char hfr	874 @ 114.75
9 blk/char hfr	599 @ 107.50

COWS & HEIFERETTES	
1 blk hfrt	1035 @ 110.00
1 blk hfrt	880 @ 100.00
1 blk hfrt	960 @ 100.00
1 blk hfrt	655 @ 91.00
1 blk cow	1210 @ 71.00
1 sim cow	1150 @ 70.00
1 blk cow	1220 @ 67.50
1 blk cow	1555 @ 63.50
1 blk cow	1660 @ 63.00
1 sim cow	1410 @ 62.50
1 blk cow	1630 @ 62.00
1 blk cow	1700 @ 61.50
1 blk cow	1575 @ 60.50
1 red cow	1495 @ 60.00
1 char cow	1190 @ 58.50
1 blk cow	1240 @ 57.50
1 blk cow	1100 @ 56.50
1 blk cow	1655 @ 55.50
1 blk cow	950 @ 53.00

BRED COWS & HEIFERS	
4 blk cows	@ 1075.00
1 blk cow	@ 1000.00
1 blk cow	@ 1000.00
1 char cow	@ 975.00

BULLS	
1 blk cow/cf	@ 1050.00
1 blk bull	1710 @ 75.00
1 blk bull	2040 @ 69.00
1 blk bull	2400 @ 67.50
1 blk bull	1780 @ 65.00

WATCH OUR AUCTIONS LIVE ON  
DVAuctions.com

CONSIGNMENTS FOR NOVEMBER 1:  
• 27 Angus steers, 550-600 lbs., weaned, vacc.  
• 50 blk red baldy str, 650-700 lbs., weaned, vacc.  
• 150 Angus str & hfrs, 500-600 lbs., vaccinated  
• 70 black heifers, 725-750 lbs.  
• 140 black heifers, 750-775 lbs.  
• 64 black steers, 825-850 lbs.  
• 60 black Charolais steers, 875-900 lbs.  
• 60 black steers, 875-900 lbs.  
• 61 black crossbred str, 925-950 lbs.  
• 58 black steers, 900-925 lbs.  
• 60 black Charolais steers, 900-925 lbs.  
• 31 black crossbred steers, 900-925 lbs.  
PLUS MORE BY SALE TIME!

CONSIGNMENTS FOR NOVEMBER 8:  
• 55 Angus bwf steers & heifers, 500-600 lbs., weaned, vacc.  
PLUS MORE BY SALE TIME!

Our CONSIGNMENTS can now be viewed after 12 Noon on Mondays by going to [WWW.grassandgrain.com](http://WWW.grassandgrain.com) & logging onto the online subscription

FOR INFORMATION OR ESTIMATES:

REZAC BARN . . . .ST. MARYS, 785-437-2785

DENNIS REZAC . . . .ST. MARYS, 785-437-6349

DENNIS' CELL PHONE . . . . .785-456-4187

KENNETH REZAC . .ST. MARYS 785-458-9071

LELAND BAILEY . . .TOPEKA, 785-286-1107

LYNN REZAC . . .ST. MARYS, 785-456-4943

REX ARB . . . . .MELVERN, 785-224-6765

Toll Free Number.....1-800-531-1676

Website: [www.rezACLIVESTOCK.com](http://www.rezACLIVESTOCK.com)

AUCTIONEERS: DENNIS REZAC & REX ARB



Livestock Commission  
Company, Inc.  
St. Marys, Ks.